

**CADENAS Y ACCESORIOS PARA  
CINTAS TRANSPORTADORAS**



**2011**



CADENA DE MALLA	Jw900T	P1
CADENA DE MALLA	Jw900G	P1
CADENA DE MALLA	Jw900B	P1
CADENA DE MALLA	Jw900BK	P1
SPROCKET	Jw900L	P2
PEINE	Jw900S	P2
CADENA DE MALLA	Jw1100G	P2
CADENA DE MALLA	Jw1100D	P2
SPROCKET	Jw1100L	P3
CADENA DE MALLA	Jwp1-15	P3
CADENA DE MALLA	Jwp2-15	P3
SPROCKET	JwpL	P3
CADENA DE MALLA	Jw127	P4
SPROCKET	Jw127L	P4
CADENA DE MALLA	Jw254	P4
SPROCKET	Jw254L	P4
CADENA DE MALLA	Jw400-159	P5
SPROCKET	Jw400L	P5
CADENA DE MALLA	Jw5935	P5
SPROCKET	Jw5935L	P5
PEINE	Jw5935S	P6
CADENA DE MALLA	Jw7705	P6
SPROCKET	Jw7705L	P6
CADENA DE MALLA	Jw4803	P6
SPROCKET	Jw4803L	P7
PEINE	Jw4803S	P7
CADENA DE MALLA	Jw4809	P7
SPROCKET	Jw4809L	P7
CADENA DE MALLA	Jw5997	P7
SPROCKET	Jw5997L	P8
PEINE	Jw5997S	P8
CADENA DE MALLA	Jw1000	P8
SPROCKET	Jw1000L	P8

CADENA DE TABLILLA INOX	: JL815	P9
CADENA DE TABLILLA INOX	: JL802	P9
CADENA DE TABLILLA INOX	: JL512	P9
CADENA DE TABLILLA INOX	: JL802T	P9
CADENA DE TABLILLA INOX	: JL812T	P10
SPROCKET	JNS815Z	P10
SPROCKET	: JKU815Z	P10
SPROCKET	: JNS815J	P10
SPROCKET	: JKU815J	P11
SPROCKET	: JST815T	P11
RUEDA DE RETORNO	: JNSXT820J	P11
RUEDA DE RETORNO	: JNXT820Z	P11
CADENA DE TABLILLA INOX	: JL881C	P12
CADENA DE TABLILLA INOX	: JL8811TAB	P12
SPROCKET	: JKU881J	P12

SPROCKET	: JNS881Z	P12
SPROCKET	: JNS881J	P12
CADENA DE TABLILLA TERMOPLASTICA	: JL820	P13
CADENA DE TABLILLA TERMOPLASTICA	: JL820K	P13
CADENA DE TABLILLA TERMOPLASTICA	: JL820D	P13
SPROCKET	: JNS820Z	P13
SPROCKET	: JNS820J	P13
RUEDA DE RETORNO	: JNSXT820Z	P14
RUEDA DE RETORNO	: JNXT820Z	P14
CADENA DE TABLILLA TERMOPLASTICA	: JL821	P14
CADENA DE TABLILLA TERMOPLASTICA	: JL821D	P14
SPROCKET	: JKU821J	P14
SPROCKET	: JKU821J	P15
RUEDA DE RETORNO	: JNXT821J	P15
CADENA DE TABLILLA TERMOPLASTICA	: JL831	P15
SPROCKET	: JKU831J	P15
SPROCKET	: JNS831Z	P15
SPROCKET	: JNS831J	P16
SPROCKET	: JKU831J	P16
CADENA DE TABLILLA TERMOPLASTICA	: JL880	P16
CADENA DE TABLILLA TERMOPLASTICA	: JL880TAB	P16
CADENA DE TABLILLA TERMOPLASTICA	: JL880K	P16
SPROCKET	: JNS880J	P17
SPROCKET	: JNS880Z	P17
SPROCKET	: JKU880J	P17
CADENA DE TABLILLA TERMOPLASTICA	: JL882	P17
CADENA DE TABLILLA TERMOPLASTICA	: JL882TAB	P17
SPROCKET	: JNS882Z	P18
SPROCKET	: JKU882J	P18
SPROCKET	: JNS882J	P18
CADENA DE TABLILLA TERMOPLASTICA	: JL1873	P18
CADENA DE TABLILLA TERMOPLASTICA	: JL963	P18
SPROCKET	: JL100	P19
CADENA DE TABLILLA DE BAJA PRESION	: JL821	P19
CADENA DE TABLILLA DE BAJA PRESION	: JL882TAB	P19
CADENA DE TABLILLA DE BAJA PRESION	: JL883TAB	P19
CADENAS MULTIFLEXIBLES	: JL1700K	P20
CADENAS MULTIFLEXIBLES	: JL1701	P20
CADENAS MULTIFLEXIBLES	: JL1702	P20
CADENAS MULTIFLEXIBLES	: JL1716K	P20
CADENAS MULTIFLEXIBLES	: JL1790K	P21
SPROCKET	: JKU1700	P21
SPROCKET	: JL1700Z, JL1700S	P21
CADENA P/TRANSPORTES DE CAJAS	: JLA600, JLA1400	P21
SPROCKET	: JL600A	P22
SPROCKET	: JL600B	P22
SPROCKET	: JL600C	P22
CADENAS MULTIFLEXIBLES	: JL55	P22
CADENAS MULTIFLEXIBLES	: JL1060	P23
CADENAS MULTIFLEXIBLES	: JL1050	P23
EJE UNI 6604		P23
EJE INCH		P23

CURVA MAGNETICA	KMU	p24
CURVA MAGNETICA	COMBI	p24
CURVA COLA DE MILANO	KSU	p25
CURVA COLA DE MILANO	SSU	p25
CURVA TAB 880	KTU200	p26
CURVA TAB 882	STU200	p26
CURVA TAB 1873-1874	KTU300	p27
CURVA TAB 1873-1874	STU300	p27
CURVA TAB LBP-SLBP	KTU200	p28
CURVA TAB LBP-SLBP	STU200	p28
CURVA TAB 1700-1701	KTU500	p29
CURVA TAB 1700-1701	STU500	p29

SOPORTE ORIENTABLE	JP234	p30
SOPORTE ORIENTABLE	JP235	p30
SOPORTE FIJO	JP236	p30
SOPORTE FIJO	Jp617	p30
SOPORTE FIJO	Jp140	p30
SOPORTE FIJO	Jp81	p30
SOPORTE FIJO	Jp72	p31
SOPORTE FIJO	Jp599	p31
SOPORTE FIJO PEQUEÑO	Jp107	p31
SOPORTE ORIENTABLE	Jp542	p31
SOPORTE ORIENTABLE	Jp541	p32
SOPORTE ORIENTABLE	Jp544	p32
SOPORTE ORIENTABLE	Jp543	p32
MARIPOSA HEMBRA	Jp183	p32
MARIPOSA MACHO	Jp185	p32
MARIPOSA HEMBRA	Jp182	p33
MARIPOSA MACHO	Jp181	p33
CANCAMO CON TUERCA	Jp180	p33
MANILLA DE AJUSTE HEMBRA	Jp302	p33
MANILLA DE AJUSTE MACHO	Jp303	p33
CABEZA ORIENTABLE	Jp256	p34
CABEZA ORIENTABLE	Jp192	p34
BASE SOPORTE LATERAL	Jp186	p34
SEPARADOR LATERAL	Jp142	p34
VASTAGO HEMBRA M8	Jp535	p35
SET PORTA-SENSOR	Jp342	p35
MORDAZA T	Jp339	p35
MORDAZA CRUZ	Jp340	p35
PORTA-SENSOR	Jp341	p36
MORDAZA T	Jp595	p36
AMARRA CRUZ	Jp609	p36
AMARRA CRUZ	Jp610	p36
MORDAZA CRUZ	Jp174, Jp174R	p36
MORDAZA SIMPLE CILINDRICA	Jp82	p37
MORDAZA SIMPLE CILINDRICA C/VASTAGO	Jp82P	p37
MORDAZA SIMPLE CONICA	Jp210	p37
MORDAZA SIMPLE CONICA C/VASTAGO	Jp210P	p37
MORDAZA CONICA DESLIZANTE	Jp211	p38

MORDAZA CILINDRICA DESLIZANTE	Jp159, Jp437	p38
MORDAZA DOBLE CONICA	Jp213	p38
MORDAZA DOBLE CILINDRICA	Jp214	p38
SOPORTE DE BANDEJA	Jp225	p38
SOPORTE DE BANDEJA	Jp226	p39
ARANDELA FIJACION SOPORTE DE BANDEJA	Jp227	p39
TAPON HILADO REDONDO	Jp178	p39
TAPON HILADO CUADRADO	Jp179	p39
JUNTA DE CONEXION SIMPLE	Jp409	p39
CABEZAL SOPORTE LATERAL	Jp199	p40
CABEZAL DE APOYO CUADRADO	Jp198	p40
CABEZAL DE APOYO RECTANGULAR	Jp280	p40
ADAPTADOR	Jp420	p40
AMARRA DE PIE	Jp454	p41
AMARRA DE PIE	Jp137	p41
BASE TRIPODE	Jp615	p41
BASE BIPODE CON SALIDA LATERAL	Jp616	p41
BASE BIPODE	Jp618	p42
BASE PIE D.100	Jp629	p42
BASE PIE D.125	Jp625	p42
PIE ARTICULADO D.100	Jp624	p42
PIE ARTICULADO D. 60,70,80	Jp626, Jp627, Jp628	p43
RODILLO DE RETORNO	Jp561	p43
RODILLO DE RETORNO	Jp560	p43
RODILLO DE RETORNO	Jp73	p43
RODILLO DE RETORNO	Jp126	p44
RODILLO DE RETORNO	Jp125	p44
RODILLO DE RETORNO	Jp554	p44
RODILLO DE RETORNO	Jp555	p44
RODILLO DE RETORNO	Jp421	p45
RODILLO DE RETORNO	Jp388	p45
RODILLO DE RETORNO	Jp556	p45
RUEDA DE RETORNO	Jp67, Jp22, Jp74	p45
RUEDA DE RETORNO	Jp22M	p46
CONTROL DE CONTACTO	Jp518	p46
PATIN DE RETORNO	Jp150	p46
ABRAZADERA	Jp371	p46
CONECTOR	Jp372	p46
PATIN DE DESLIZAMIENTO	Jp551	p47
PATIN DE DESLIZAMIENTO	Jp550	p47
MORDAZA CONICA	Jp275	p47
PLACA DE TRANSFERENCIA	Jp567	p47
PLACA DE TRANSFERENCIA	Jp568	p48
PLACA DE TRANSFERENCIA	Jp569	p48
GUIA DE ACUMULACION	Jp628s	p48
GUIA DE ACUMULACION	Jp557	p48
GUIA DE ACUMULACION	Jp581	p49
GUIA DE ACUMULACION	Jp554	p49
GUIA DE ACUMULACION	Jp580	p49
GUIA DE ACUMULACION	Jp580p	p49
GUIA DE ACUMULACION	Jp582	p50
GUIA DE ACUMULACION	Jp585	p50
GUIA DE ACUMULACION	Jp128	p50
GUIA DE ACUMULACION	Jp129	p50
GUIA DE ACUMULACION	Jp570, Jp806	p51



## CONTENIDO

CABEZA DE GUIA DE ACUMULACION	Jp807	p51
CABEZA DE GUIA DE ACUMULACION	Jp586	p51
CABEZA DE GUIA DE ACUMULACION	Jp587, Jp808	p51
CABEZA DE GUIA DE ACUMULACION	Jp597	p52
CABEZA DE GUIA DE ACUMULACION	Jp570	p52
GUIA DE ACUMULACION	Jp128S	p52
GUIA DE ACUMULACION	Jp128AS	p52
ACCESORIOS PARA LLENADORAS	Jp611	p53
ACCESORIOS PARA LLENADORAS	Jp612	p53
ACCESORIOS PARA LLENADORAS	Jp613A	p53
ACCESORIOS PARA LLENADORAS	Jp613B	p53
ACCESORIOS PARA LLENADORAS	Jp613C	p54
ACCESORIOS PARA LLENADORAS	Jp613D	p54
ACCESORIOS PARA LLENADORAS	Jp613E	p54
ACCESORIOS PARA LLENADORAS	Jp615	p54
ACCESORIOS PARA LLENADORAS	Jp616	p55
ACCESORIOS PARA LLENADORAS	Jp617	p55
ACCESORIOS PARA LLENADORAS	Jp618	p55
ACCESORIOS PARA LLENADORAS	Jp619	p55
ACCESORIOS PARA LLENADORAS	Jp620	p56
ACCESORIOS PARA LLENADORAS	Jp215	p56
ACCESORIOS PARA LLENADORAS	Jp217	p56
ACCESORIOS PARA LLENADORAS	Jp218	p56
ACCESORIOS PARA LLENADORAS	Jp602	p56
ACCESORIOS PARA LLENADORAS	Jp603	p57
ACCESORIOS PARA LLENADORAS	Jp604	p57
ACCESORIOS PARA LLENADORAS	Jp605	p57
ACCESORIOS PARA LLENADORAS	Jp606	p57
ACCESORIOS PARA LLENADORAS	Jp607	p58
ACCESORIOS PARA LLENADORAS	Jp608	p58
ACCESORIOS PARA LLENADORAS	Jp218	p58
ACCESORIOS PARA LLENADORAS	Jp219	p58
PORTA-ESPEJO	Jp220	p58
PORTA-ESPEJO	Jp221	p58
BISAGRA	180° Jp571	p59
BISAGRA	180° Jp337	p59
BISAGRA	170° Jp260	p59
BISAGRA	270° Jp576	p60
BISAGRA	195° Jp575	p60
MANILLA GRANDE	Jp621	p60
MANILLA PEQUEÑA	Jp622	p60
TOPE	Jp623	p61
ACCESORIOS PARA LLENADORAS	Jp230	p61
ACCESORIOS PARA LLENADORAS	Jp231	p61
ACCESORIOS PARA LLENADORAS	Jp232	p61
ACCESORIOS PARA LLENADORAS	Jp233	p61
ACCESORIOS PARA LLENADORAS	Jp222	p61
ACCESORIOS PARA LLENADORAS	Jp223	p61
ACCESORIOS PARA LLENADORAS	Jp224	p61
BOQUILLAS PARA LLENADORAS		p62
BOQUILLAS PARA LLENADORAS		p63
UCF/C - SUCF		p64
MANTENCION DE SOPORTES DE RODAMIENTO		p65
REPUESTOS PARA SOPORTES DE RODAMIENTOS		p66
REPUESTOS PARA SOPORTES DE RODAMIENTOS		p67

GUIAS DE DESLIZAMIENTO		
Jdp01	PE	p68
Jdp02	PE	p68
Jd91		p68
Jd596, Jd393		p68
Jd223, Jd274		p69
Jd310, Jd356		p69
Jd219		p69
Jd273, Jd539		p70
Jd540		p70
Jd262, Jd261, Jd243, Jd241		p70
Jd251, Jd242, Jd263, Jd386		p71
Jd362, Jd244, Jd387		p71
Jd001, Jd002, Jd003, Jd004		p72
Jd005, Jd006, Jd007, Jd008, Jd009		p72
Jd010, Jd011, Jd012, Jd013		p73
Jd014, Jd015, Jd016, Jd017		p73
Jd018, Jd019, Jd020, Jd021		p74
Jd022, Jd023, Jd024, Jd025		p74
Jd026, Jd027, Jd028, Jd029		p75
Jd030, Jd031, Jd032		p75
Jd033, Jd034, Jd035, Jd036		p76
Jd039, Jd040, Jd041		p76
Jd042, Jd043, Jd044, Jd045		p77
Jd049, Jd050, Jd051, Jd052		p77
Jd053, Jd054, Jd055, Jd056, Jd057		p78
Jd058, Jd060, Jd061, Jd063, Jd064		p78
Jd065, Jd066, Jd067, Jd068, Jd069		p79
Jd070, Jd071, Jd072, Jd073		p79
Jd074, Jd075, Jd078, Jd080		p80
Jd081, Jd082, Jd083, Jd084		p80
Jd085, Jd086, Jd087		p81
Jd088, Jd089, Jd090		p81

CADENAS DE MALLA TERMOPLASTICA



900 T

Jw900T

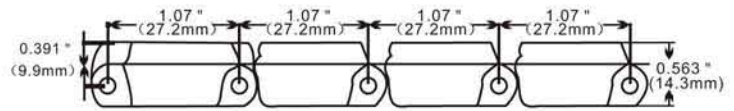
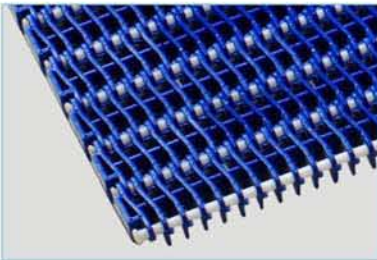

inch	12	15	18	24	30	36	42	54	60	96	120
mm	304.8	381	457.2	609.6	762	914.4	1066.8	1371.6	1524	2438.4	3048

900 G

Jw900G

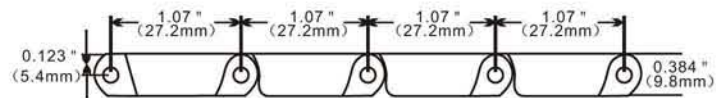
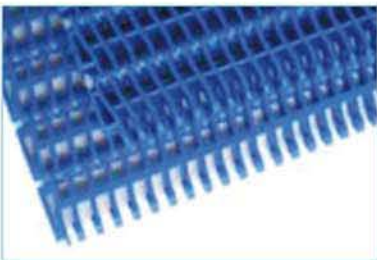

inch	12	15	18	24	30	36	42	54	60	96	120
mm	304.8	381	457.2	609.6	762	914.4	1066.8	1371.6	1524	2438.4	3048

900 B

Jw900B

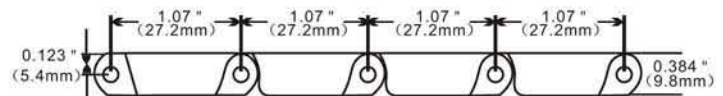

inch	12	15	18	24	30	36	42	54	60	96	120
mm	304.8	381	457.2	609.6	762	914.4	1066.8	1371.6	1524	2438.4	3048

900 BK

Jw900BK

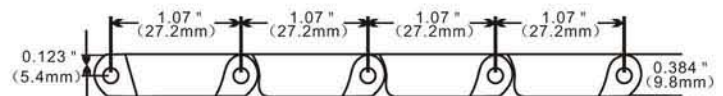

inch	12	15	18	24	30	36	42	54	60	96	120
mm	304.8	381	457.2	609.6	762	914.4	1066.8	1371.6	1524	2438.4	3048

900 L SPROCKET

Jw900L

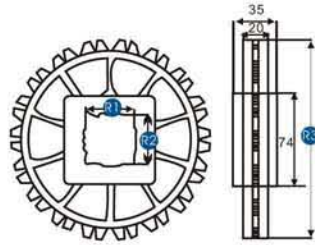

CODIGO	Z	D. CUAD		
		① mm	② mm	③ mm
JW900L6	6	25	25.4	53
JW900L9	9	30	40	78
JW900L12	12	30	40	104
JW900L18	18	30 40	40	155
JW900L20	20	30 40 50	60	173

900 S PEINE

Jw900S

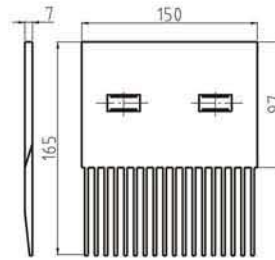

1100G

Jw1100G

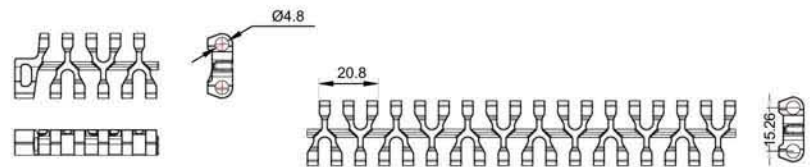
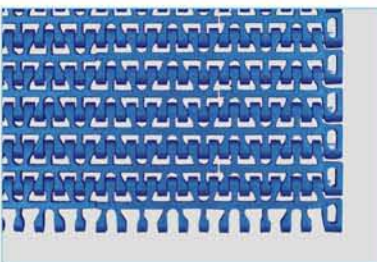

1100D

Jw1100D

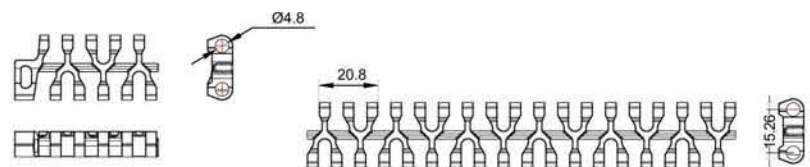

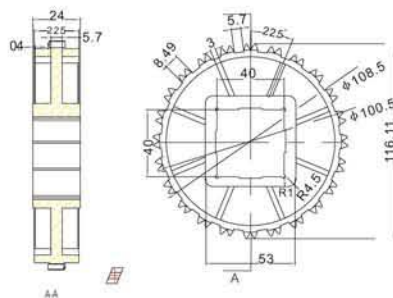
**1100L SPROCKET**
**Jw1100L**

CODIGO	NRO. DIENTES	DP mm	EJE CUAD mm
JW1100L16	16	78	30 35 40
JW1100L24	24	117	30 35 40
JW1100L32	32	155	30 35 40

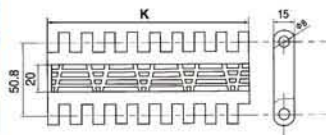
**Wp1-15**
**Jwp1-15**

CODIGO	K		N	PASO mm	Kg/m			
	mm	inch						
JWP1-15	152.4	6	2100	50	1.44			
inch	6	12	18	24	30	36	42	48
mm	152.4	304.8	457.2	609.6	762	914.4	1066.8	1219.2
inch	54	60	66	72	78	84	90	96
mm	1371.6	1524	1676.4	1828.8	1981.2	2133.6	2286	2438.4

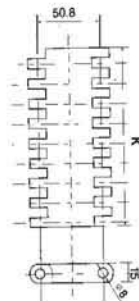
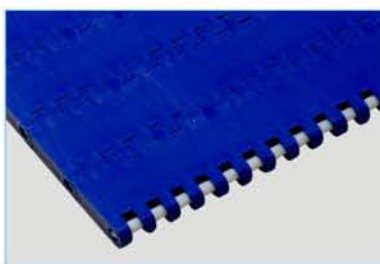
**Wp2-15**
**Jwp2-15**

CODIGO	K		N	PASO mm	Kg/m			
	mm	inch						
JWP2-15	152.4	6	2100	50	1.44			
inch	6	12	18	24	30	36	42	48
mm	152.4	304.8	457.2	609.6	762	914.4	1066.8	1219.2
inch	54	60	66	72	78	84	90	96
mm	1371.6	1524	1676.4	1828.8	1981.2	2133.6	2286	2438.4

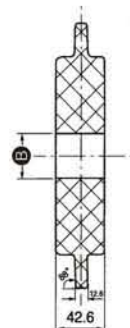
**WPL SPROCKET**
**Jwpl**

CODIGO	NRO. DIENTES	D. EXT. mm	DP mm	ANCHO mm	B mm	
					mm	mm
JWPL6	6	96	75	42.6	25 30	25.4 38.1
JWPL8	8	120	100	42.6	25 30	25.4 38.1
JWPL10	10	160	125	42.6	25 30 40 50	30 38.3 40 50
JWPL12	12	196	157	42.6	25 30 40 50	30 38.3 40 50
JWPL14	14	228	189	42.6	25 30 40 50	30 38.3 40 50

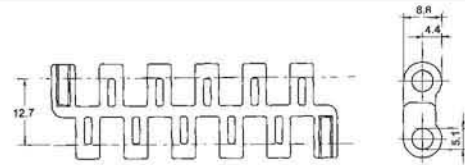

**JW127**
**Jw127**

inch	3.0	6.0	9.0	12.0	15.0	18.0	21.0	24.0	27.0	30.0	33.0	36.0	39.0	42.0	45.0	48.0	51.0	54.0	57.0	60.0
mm	76	152	228	305	381	457	533	607	683	762	838	914	990	1066.8	1143	1219.2	1295.4	1371.6	1447.8	1524
inch	63	66	69	72	75	78	81	84	87	90	93	96	99	102	105	108	111	114	117	120
mm	1600.2	1676.4	1752.6	1828.8	1905	1981.2	2057.4	2133.6	2209.8	2286	2362.2	2438.4	2514.6	2590.8	2667	2743.2	2819.4	2895.6	2971.8	3048

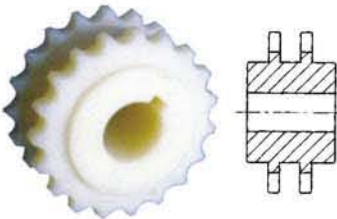
**JW127L SPROCKET**
**Jw127L**

CODIGO	Nro. de Dientes	d. masa		de		dp		espesor diente	
		mm	inch	mm	inch	mm	inch	mm	inch
JW127L10	10	10.00	0.39	41.1	1.62	40.1	1.58	2.0	0.08
JW127L19	19	19.05	0.75	77.2	3.04	76.2	3.00	2.0	0.08
JW127L28	28	19.05	0.75	113.4	4.46	112.4	4.43	2.0	0.08
JW127L38	38	19.05	0.75	153.8	6.06	152.8	6.02	2.0	0.08

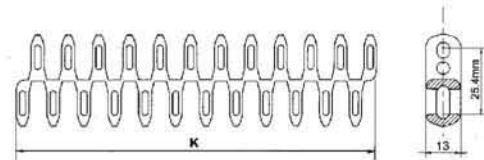
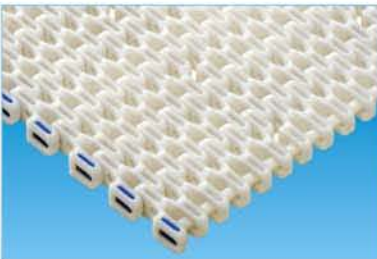
**JW254**
**Jw254**

inch	3.0	6.0	9.0	12.0	15.0	18.0	21.0	24.0	27.0	30.0	33.0	36.0	39.0
mm	76	152	228	305	381	457	533	607	683	762	838	914	990

**JW254L SPROCKET**
**Jw254L**

CODIGO	Nro. de Dientes	d. masa		de		dp	
		mm	inch	mm	inch	mm	inch
JW254L9	9	40.0	1.57	74.3	2.93	73.8	2.91
JW254L10	10	40.0	1.57	82.2	3.24	82.2	3.24
JW254L12	12	40.0	1.57	98.1	3.86	98.8	3.89
JW254L15	15	63.5	2.50	122.2	4.81	123.5	4.86
JW254L18	18	60.0	2.36	146.3	5.76	144.5	5.69
JW254L19	19	60.0	2.36	154.3	6.08	156.2	6.15
JW254L28	28	60.0	2.36	226.8	8.93	229.4	9.03

400-159

Jw400-159

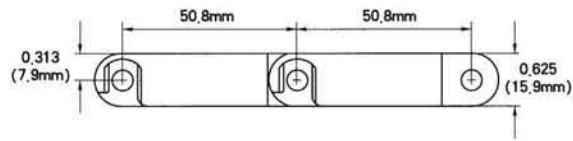

inch	6	12	15	18	30	36	42	48	60	66
mm	152	305	381	457.2	762	914.4	1066.8	1219	1524	1676.4

400L SPROCKET

Jw400L

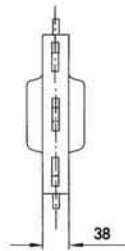

CODIGO	Nro. de Dientes	De		Dp		EJE CUAD. B mm
		mm	inch	mm	inch	
JW400L6	6	102	4.0	91	3.6	40 60 90
JW400L8	8	132	5.2	127	5.0	40 60 90
JW400L10	10	163	6.4	160	6.3	40 60 90
JW400L12	12	198	7.8	196	7.7	40 60 90
JW400L16	16	257	10.1	259	10.2	40 60 90

5935

Jw5935

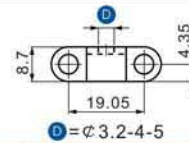

inch	9.0	12.0	15.0	18.0	21.0	24.0	27.0	30.0	33.0	36.0	39.0	42.0	45.0	48.0	51.0	54.0	57.0	60.0	63	66
mm	228	305	381	457	533	607	683	762	838	914	990	1066.8	1143	1219.2	1295.4	1371.6	1447.8	1524	1600.2	1676.4
inch	69	72	75	78	81	84	87	90	93	96	99	102	105	108	111	114	117	120	123	126
mm	1752.6	1828.8	1905	1981.2	2057.4	2133.6	2209.8	2286	2362.2	2438.4	2514.6	2590.8	2667	2743.2	2819.4	2895.6	2971.8	3048	3124.2	3200.4
inch	129	132	135	138	141	144	147	150	153	156	159	162	165	168	171	174	177			
mm	3276.6	3352.8	3429	3505.2	3581.4	3657.6	3733.8	3810	3886.2	3962.4	4038.6	4114.8	4191	4267.2	4343.4	4419.6	4495.8			

5935L SPROCKET

Jw5935L

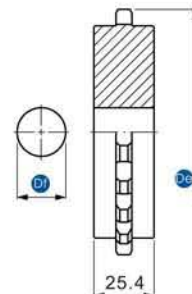

CODIGO	Nro. de Dientes	Dp mm	Df mm
JW5935L10	10	63.5	62.23
JW5935L24	24	149.2	147.34
JW5935L31	31	193.3	190.08

5935S PEINE

Jw5935S



148X15T

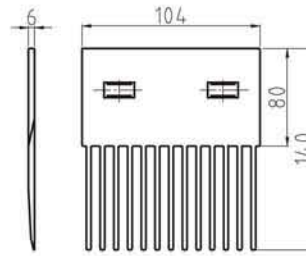

7705

Jw7705

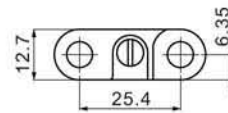

inch	3.25	4.5	6.0	9.0	12.0	15.0	18.0	21.0	24.0	27.0	30.0	33.0	36.0	39.0	42.0	45.0	48.0	51.0	54.0	57.0	60.0
mm	82.6	114.3	152	228	305	381	457	533	607	683	762	838	914	990	1066.8	1143	1219.2	1295.4	1371.6	1447.8	1524
inch	63	66	69	72	75	78	81	84	87	90	93	96	99	102	105	108	111	114	117	120	
mm	1600.2	1676.4	1752.6	1828.8	1905	1981.2	2057.4	2133.6	2209.8	2286	2362.2	2438.4	2514.6	2590.8	2667	2743.2	2819.4	2895.6	2971.8	3048	

7705L SPROCKET

Jw7705L

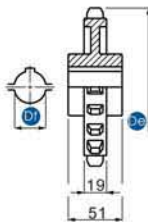

CODIGO	Nro. de Dientes	30 mm	Dp mm	30 mm	Kg
JW7705L16	16	130.6	130.20	20 30 35 40	0.33
JW7705L18	18	146.9	146.28	20 30 35 40	0.38
JW7705L21	21	170.7	170.43	20 30 35 40	0.44

4803

Jw4803

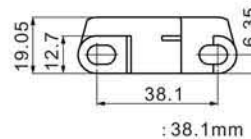

inch	6.0	12	18	24	30	36	42	48	54	60
mm	152.4	304.8	457.2	609.6	762	914.4	1066.8	1219.2	1371.6	1524
inch	66	72	78	84	90	96	102	108	114	120
mm	1676.4	1828.8	1981.2	2133.6	2286	2438.4	2590.8	2743.2	2895.6	3048

### 4803L SPROCKET

Jw4803L

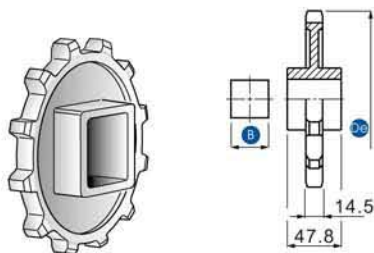

CODIGO	Nro. de Dientes	$\phi$ mm	Dp mm	$\phi$ mm	Kg
JW4803L12	12	147.2	147.22	40X40 65X65	0.19

### 4803T32

Jw4803S PEINE

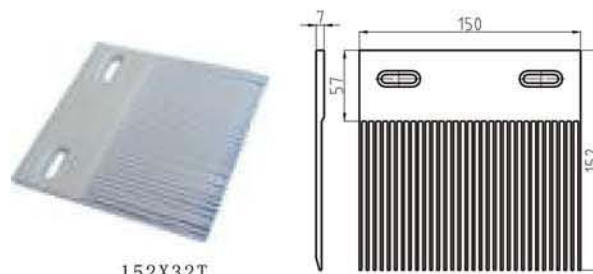

152X32T

### 4809

Jw4809

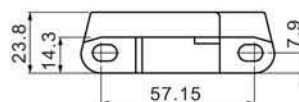

inch	6.0	12	18	24	30	36	42	48	54	60
mm	152.4	304.8	457.2	609.6	762	914.4	1066.8	1219.2	1371.6	1524
inch	66	72	78	84	90	96	102	108	114	120
mm	1676.4	1828.8	1981.2	2133.6	2286	2438.4	2590.8	2743.2	2895.6	3048

### 4809L SPROCKET

Jw4809L

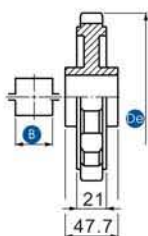

CODIGO	Nro. de Dientes	$\phi$ mm	Dp mm	$\phi$ mm	Kg
JW4809L14	14	256.5	256.82	90X90 120X120	0.77

### 5997

Jw5997

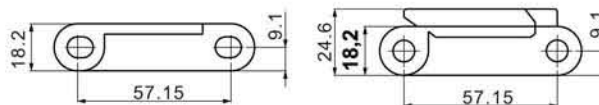

inch	18	24	30	36	42	48	54	60	66	72	78
mm	457.2	609.6	762	914.4	1066.8	1219.2	1371.6	1524	1676.4	1828.8	1981.2
inch	84	90	96	102	108	114	120	126	132	138	144
mm	2133.6	2286	2438.4	2590.8	2743.2	2895.6	3048	3200.4	3352.8	3505.2	3657.6

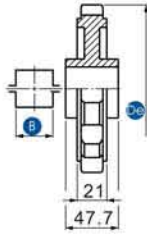
**5997L SPROCKET**
**Jw5997L**

CODIGO	Nro. de Dientes	De mm	Dp mm	EJE B mm	Kg
JW5997L14	14	256.5	256.82	90X90 120X120	0.77

**5997T12 PEINE**
**Jw5997S**

190X12T

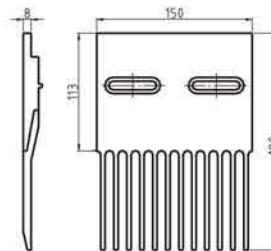
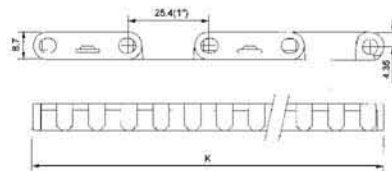
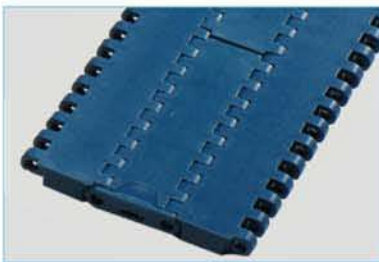

**1000**
**Jw1000**

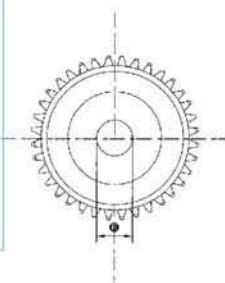
inch	3.35	6.70	10.04	13.39	16.73	20.08
mm	85.0	170	255	340	425	510
inch	26.77	33.46	53.54	66.92	80.31	133.86
mm	680	850	1360	1700	2040	3400

**1000L SPROCKET**
**Jw1000L**

CODIGO	Nro. de Dientes	De		Dp		EJE B mm
		mm	inch	mm	inch	
JW1005L16	16	130.6	5.14	130.2	5.13	20 30 40 60
JW1005L18	18	146.8	5.78	146.3	5.76	20 30 40 60
JW1005L20	20	163.1	6.42	162.4	6.40	20 30 40 60

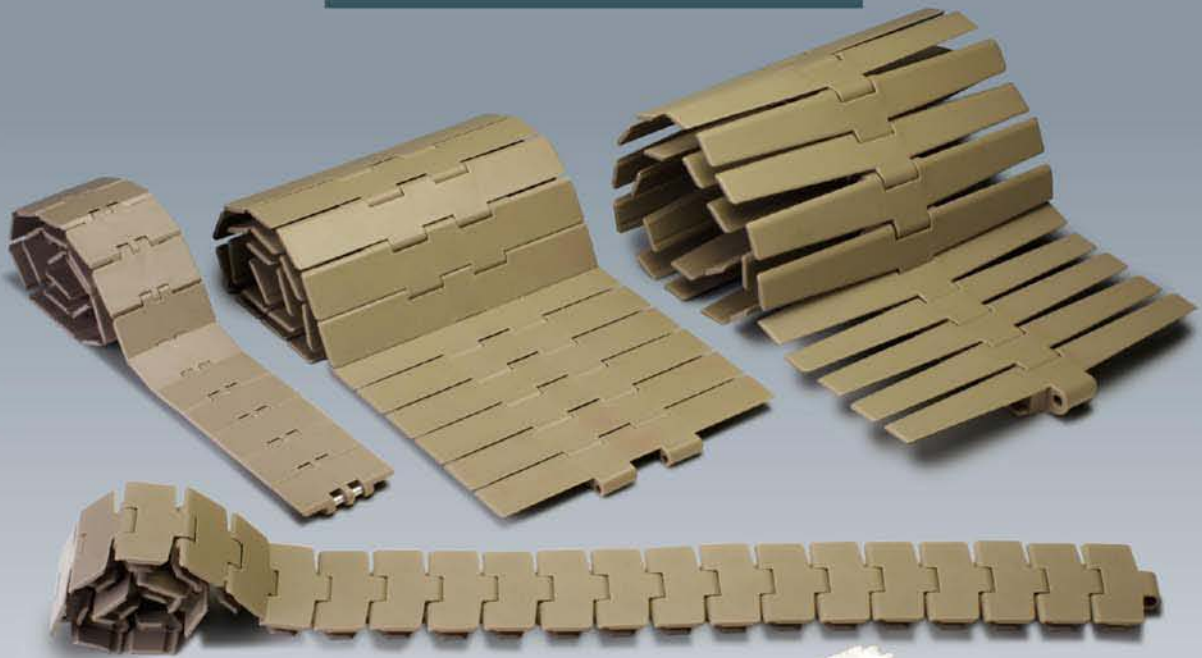
CADENAS DE TABLILLAS



812-815

JL815

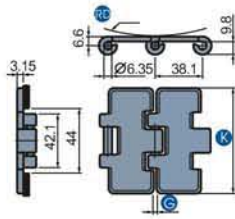

PASO 38.1MM=1½"

CODIGO	INOX	k mm	e mm	rt mm	kg/m
JL815-k325	304	82.5	1.8	150	2.6
JL815-k400	304	101.6	1.8	150	3.0
JL815-k450	304	114.3	1.8	150	3.3
JL815-k600	304	152.4	1.8	150	4.2
JL815-k750	304	190.5	1.8	150	5.1

802-805

JL802

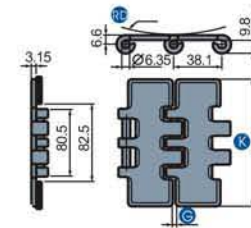

PASO 38.1MM=1½"

CODIGO	INOX	k mm	e mm	rt mm	kg/m
JL802-K750	304	190.5	1.8	150	5.8

512

JL512

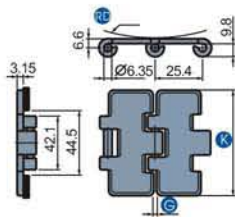

PASO 25.4MM=1"

CODIGO	INOX	k mm	e mm	rt mm	kg/m
JL512-k217	304	55.0	1.6	100	2.29
JL512-k236	304	60.0	1.6	100	2.41
JL512-k250	304	63.5	1.6	100	2.49
JL512-k283	304	72.0	1.6	100	2.65
JL512-k325	304	82.5	1.6	100	2.86
JL512-k350	304	88.9	1.6	100	3.01
JL512-k400	304	101.6	1.6	100	3.26

802

JL802T

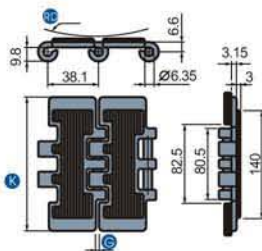

PASO 38.1MM=1½"

CODIGO	INOX	k mm	e mm	rt mm	kg/m
JL802T-K750	304	190.5	1.8	150	6.2

812

JL812T

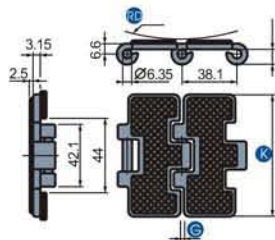

PASO 38.1MM=1½"

CODIGO	INOX	k mm	e mm	rt mm	kg/m
JL812T-K325	304	82.5	2.8	80	2.8

JNS815

812, 815, SSR812

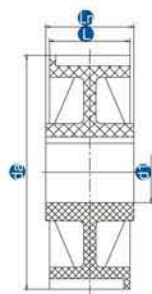

CODIGO	Z	dp mm	da mm	d1 mm	L mm	Lr mm	Kg
JNS815Z21	21	129.26	129.5	25 30 35 40 45	52	51	0.47
JNS815Z23	23	141.22	142.0	25 30 35 40 45	52	51	0.55
JNS815Z25	25	153.21	154.2	25 30 35 40 45	54	58.5	0.60

PERNO: INOX 304

JKU815

812, 815, SSR812

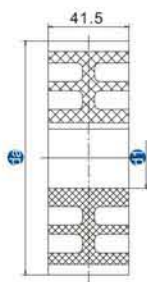

CODIGO	Z	dp mm	dc mm	d1 mm	Kg
JKU815Z21	21	129.26	129.5	25 30 40	0.66

JNS815

812, 815, SSR812

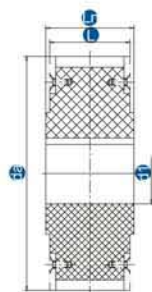

CODIGO	Z	da mm	dp mm	d1 mm	Kg
JNS815J19	19	117.35	117	20	0.40
JNS815J21	21	129.26	129	20	0.50
JNS815J23	23	141.22	142	20	0.61
JNS815J25	25	153.21	154	20	0.74
JNS815J27	27	165.21	166	20	0.88

NYLON



### JKU815

812, 815, SSR812

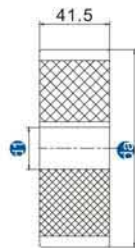

CODIGO	Z	$\phi_c$ mm	dp mm	$\phi_1$ mm	Kg
JKU815J19	19	177.35	117.0	20 30 3540	0.45
JKU815J21	21	129.26	129.5	20 30 3540	0.58
JKU815J23	23	141.22	142.0	20 30 3540	0.65
JKU815J25	25	153.21	154.2	20 30 3540 50 60	0.77
JKU815J27	27	165.21	166.0	20 30 3540	0.90

NYLON

### JST815

812, 815, SSR812

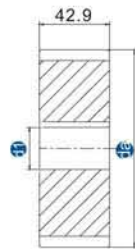

CODIGO	Z	$\phi_c$ mm	dp mm	$\phi_1$ mm	Kg
JST815T19	19	117.35	117	20	1.5
JST815T21	21	129.26	129	20	1.8
JST815T25	25	153.21	154	20	2.1

### JNSXT820

820,812-815, 802-805, 512

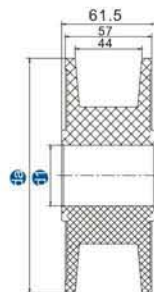

CODIGO	Z	$\phi_c$ mm	$\phi_1$ mm	$\phi_r$ mm	L mm	$\phi_r$ mm	Kg
JNSXT820J15	15	95.5	25 30	40	55	92	0.20
JNSXT820J17	17	106.5	25 30	42	53	57	0.18
JNSXT820J18	18	113.0	25 30	40	57	92	0.24
JNSXT820J19	19	118.0	25 30 40	42(51)	57	57	0.20
JNSXT820J9	19	118.0	1"	42	57	57	0.20
JNSXT831J21	21	130.0	1 1/4" 1 1/2"	40(45)	60	61.5	0.22
JNSXT831J23	23	142.5	1 1/4" 1 1/2"	40(45)	59.5	61.5	0.27
JNSXT831J25	25	154.5	1 1/4" 1 1/2"	40(45)	59	61.5	0.30

### JNXT820

820, 831, 820 HFP820, XLBP821

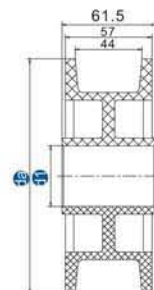

CODIGO	Z	$\phi_c$ mm	$\phi_1$ mm	$\phi_r$ mm	$\phi_1 =$ 25-30	$\phi_1 =$ 35-40	Kg
JNXT820Z21	21	130	25 30 3540	40	50	50	0.26
JNXT820Z23	23	142.5	25 30 3540	40	50	50	0.29
JNXT820Z25	25	154.5	25 30 3540 45	40	50	50	0.30

NYLON

881

JL881C

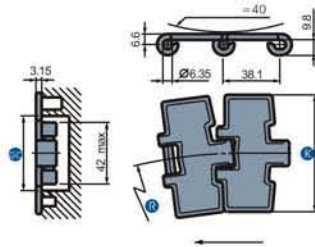

PASO: 38.1MM=1½"

CODIGO	MAG	⌀ <sub>k</sub> mm	⌀ <sub>sc</sub> mm	⌀ <sub>rc</sub> mm	kg/m
JL881C-k325	201	82.5	45 44.2	457	2.5
JL881C-k330	201	83.8	45 44.2	500	2.6
JL881C-k450	201	114.3	45 44.2	500	3.2
JL881C-k750	201	190.5	45 44.2	500	4.9

8811

JL8811TAB

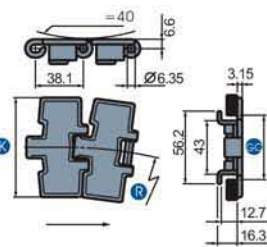

PASO: 38.1MM=1½"

CODIGO	INOX	⌀ <sub>k</sub> mm	⌀ <sub>sc</sub> mm	⌀ <sub>rc</sub> mm	kg/m
JL8811TAB-k325	304	82.5	46 44.2	457	3.1
JL8811TAB-k350	304	88.9	46 44.2	500	3.3
JL8811TAB-k450	304	114.3	46 44.2	610	3.8
JL8811TAB-k750	304	190.5	46 44.2	610	5.5

JKU881

881, 8811, 8811TAB, SSR812-K125/175, SSR812TAB, SSC8811TAB

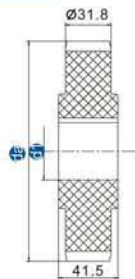

CODIGO	Z	dp mm	⌀ <sub>sc</sub> mm	⌀ <sub>di</sub> mm	⌀ <sub>dp</sub> mm	Kg
JKU881J10	21	129.26	129.5	20 30 3540	75	0.40
JKU881J11	23	141.22	142.0	20 30 3540	80	0.50
JKU881J12	25	153.21	154.2	20 30 3540	90	0.60

JNS881

881, 8811, 8811TAB, SSR812-K125/175, SSR812TAB, SSC8811TAB

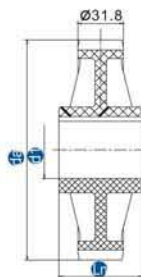

CODIGO	Z	dp mm	⌀ <sub>sc</sub> mm	⌀ <sub>di</sub> mm	⌀ <sub>dp</sub> mm	Kg
JNS881Z21	21	129.26	129.5	25 30 3540 45	51	0.39
JNS881Z23	23	141.22	142.0	25 30 3540 45	51	0.44
JNS881Z25	25	153.21	154.2	25 30 3540 45	58.5	0.52

PERNOS INOX 304

JNS881

881, 8811, 8811TAB, SSR812-K125/175, SSR812TAB, SSC8811TAB

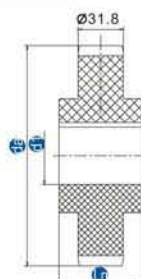

CODIGO	Z	dp mm	⌀ <sub>sc</sub> mm	⌀ <sub>di</sub> mm	⌀ <sub>dp</sub> mm	Kg
JNS881J21	21	129.26	129.5	20 30 3540	75	0.45
JNS881J23	23	141.22	142.0	20 30 3540	80	0.55
JNS881J25	25	153.21	154.2	20 30 3540	90	0.65

PERNOS INOX 304

820

JL820

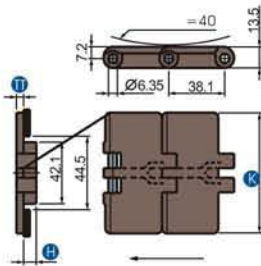

PASO: 38.1MM=1½"

CODIGO	MATERIAL	k mm	t mm	H mm	kg/m
JL820-k325	POM	63.5	4	9.5	0.73
JL820-k325	POM	82.5	4	9.5	0.83
JL820-k343	POM	87.0	4	9.5	0.85
JL820-k350	POM	88.9	4	9.5	0.87
JL820-k400	POM	101.6	4	9.5	0.95
JL820-k450	POM	114.3	4	9.5	1.03
JL820-k600	POM	152.4	4	9.5	1.25
JL820-k750	POM	190.5	4	9.5	1.47

820K

JL820K

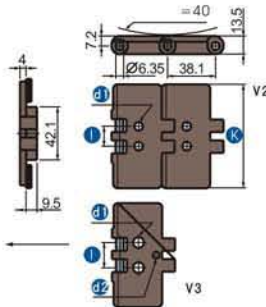

PASO: 38.1MM=1½"

CODIGO	MATERIAL	k mm	d1 mm	d2 mm	l mm	kg/m
JL820K-k325(V2)	POM	82.5	6.5		19	0.83
JL820K-k350(V2)	POM	88.9	4.0		45	0.87
JL820K-k450(V2)I30	POM	114.3	8.0		30	1.03
JL820K-k450(V3)I50	POM	114.3	8.0	4.0	50	1.03

820D

JL820D

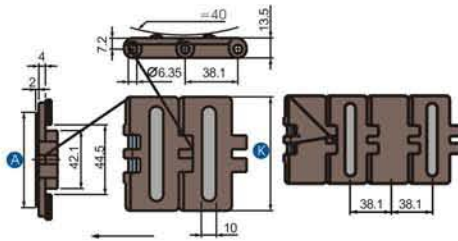

PASO: 38.1MM=1½"

CODIGO	k mm	A mm	kg/m
JL820D-k325	82.5	65.0	0.83
JL820D-k350	88.9	88.9	0.87
JL820D-k400	101.6	101.6	0.95
JL820D-k450	114.3	114.3	1.03
JL820D-k600	152.4	135.0	1.25

JNS820

820, HFP820, XLB831

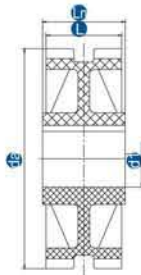

CODIGO	Z	dp mm	dc mm	d1 mm	L mm	tr mm	kg
JNS820Z21	21	129.26	129.5	25 30 35 40 45	52	51	0.46
JNS820Z23	23	141.22	142.0	25 30 35 40 45	52	51	0.54
JNS820Z25	25	153.21	154.2	25 30 35 40 45	54	58.5	0.63

JNS820J

820, HFP820, XLB831

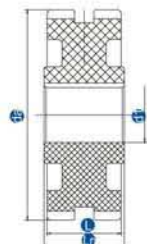

CODIGO	Z	dp mm	dc mm	d1 mm	L mm	tr mm	kg
JNS820J21	21	129.26	129.5	25 30 35 40 45	52	51	0.46
JNS820J23	23	141.22	142.0	25 30 35 40 45	52	51	0.54
JNS820J25	25	153.21	154.2	25 30 35 40 45	54	58.5	0.63

### JNSXT820

831, 820, HFP820, XLBP821

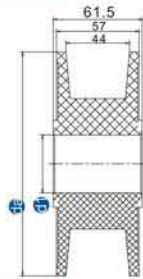

CODIGO	Z	dc mm	di mm	df mm		Kg
				25-30	35-40	
JNSXT820Z21	21	130	25 30 35 40	40	50	0.26
JNSXT820Z23	23	142.5	25 30 35 40	40	50	0.29
JNSXT820Z25	25	154.5	25 30 35 40 45	40	50	0.30

NYLON

### JNXT820

831, 820, HFP820, XLBP821

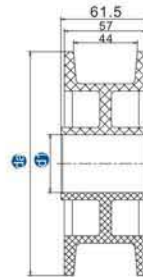

CODIGO	Z	dc mm	di mm	df mm	L mm	Lf mm	Kg
JNXT831Z17	17	106.5	25 30	42	53	57	0.18
JNXT831Z18	18	113.0	25 30	40	57	92	0.24
JNXT831Z19	19	118.0	25 30 40	42(51)	57	57	0.20
JNXT820Z19	19	118.0	1"	42	57	57	0.20
JNXT831Z21	21	130.0	1 1/4" 1 1/2"	40(45)	60	61.5	0.22
JNXT831Z23	23	142.5	1 1/4" 1 1/2"	40(45)	59.5	61.5	0.27
JNXT831Z25	25	154.5	1 1/4" 1 1/2"	40(45)	59	61.5	0.30

### 821

JL821

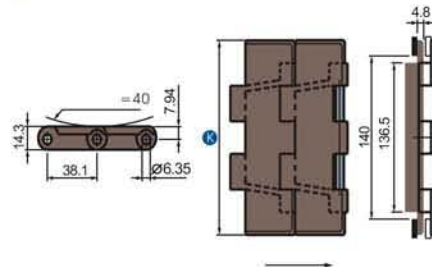

PASO: 38. 1MM=1 1/2"

CODIGO	MATERIAL	k mm	kg/m
JL820-k750	POM	190.5	2.5
JL820-k1000	POM	254.0	2.95
JL820-k1200	POM	304.8	3.25

### 821D

JL821D

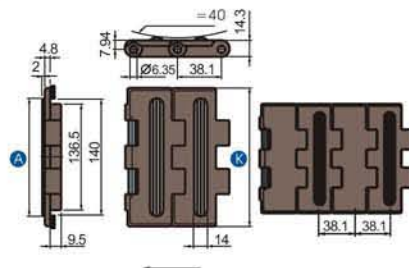

PASO: 38. 1MM=1 1/2"

CODIGO	k mm	A mm	kg/m
JL821D-k750	190.5	132	2.50
JL821D-k1000	254.0	195	2.95
JL821D-k1200	304.8	245	3.25

### JKUS821

821, FLBP821, HFP821, HFP821F, LBP821, SLBP821

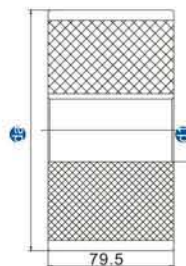

CODIGO	Z	dp mm	dc mm	di mm			Kg
				20	30	35 40 45	
JKUS821J21	21	129.26	129.5	20	30	35 40 45	1.03
JKUS821J23	23	141.22	142.0	20	30	35 40 45	1.23
JKUS821J25	25	153.21	154.2	20	30	35 40 45	1.46
JKUS821J27	27	165.21	166.0	20	30	35 40 45	1.67
JKUS821J29	29	177.24	179	20	30	35 40 45	2.06

NYLON

**JKU821**

821

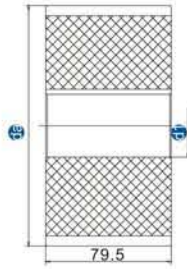

CODIGO	Z	dp mm	dc mm	dj mm	mm	Kg
JKU821J21	21	129.26	129	19	45	0.77
JKU821J23	23	141.22	142	19	45	0.88
JKU821J25	25	153.21	154	19	45	1.01
JKU821J27	27	165.21	166	19	45	1.19
JKU821J29	29	177.24	179	19	45	1.47

**JNXT821**

821, FLB821, HFP821, HFP821F, LBP821, SLBP821

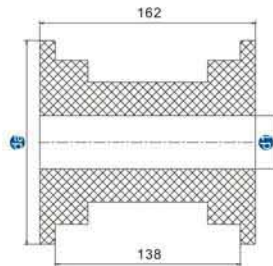

CODIGO	Z	dj mm	ANCHO mm	dc mm
JNXT821J25	25	154.7	162	25 30 35 40

**831**

JL831

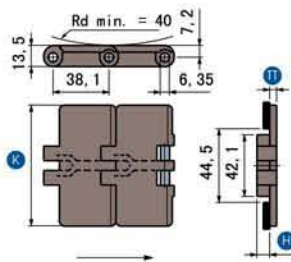

38.1MM=1½"

CODIGO	k mm	t mm	H mm	Kg
JL831-k325	82.5	4.8	8.7	1.00
JL831-k450	114.3	4.8	8.7	1.24
JL831-k750	190.5	4.8	8.7	1.76

**JKUS831**

831, 820, HFP820, XLBP831

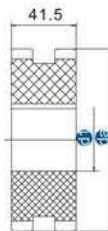

CODIGO	Z	dp mm	dc mm	dj mm	Kg
JKUS831J19	19	177.35	117.0	20 30 35 40	0.40
JKUS831J21	21	129.26	129.5	20 30 35 40	0.50
JKUS831J23	23	141.22	142.0	20 30 35 40	0.60
JKUS831J25	25	153.21	154.2	20 30 35 40 50 60	0.74
JKUS831J27	27	165.21	166.0	20 30 35 40	0.88

**JNS831**

831, 820, HFP820, XLBP831

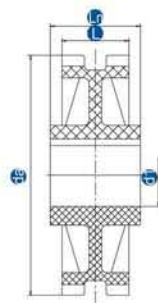

CODIGO	Z	dp mm	dc mm	dj mm	lt mm	Kg
JNS831Z21	21	129.26	129.5	25 30 35 40 45	51	0.46
JNS831Z23	23	141.22	142.0	25 30 35 40 45	51	0.54
JNS831Z25	25	153.21	154.2	25 30 35 40 45	58.5	0.63

**JNS831**

831, HFP820, XLBP831

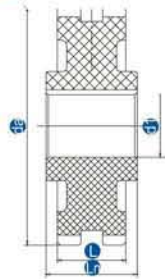

CODIGO	Z	dp mm	dc mm	d1 mm	lf mm	kg
JNS831J21	21	129.26	129.5	25 30 35 40 45	51	0.46
JNS831J23	23	141.22	142.0	25 30 35 40 45	51	0.54
JNS831J25	25	153.21	154.2	25 30 35 40 45	58.5	0.63

**JKU831**

831, 820, HFP820, XLBP831

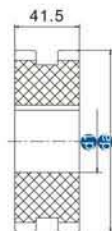

CODIGO	Z	dp mm	dc mm	d1 mm	lf mm	kg
JKU831J21	21	129.26	129.5	25 30 35 40 45	51	0.46
JKU831J23	23	141.22	142.0	25 30 35 40 45	51	0.54
JKU831J25	25	153.21	154.2	25 30 35 40 45	58.5	0.63

**880**

JL880

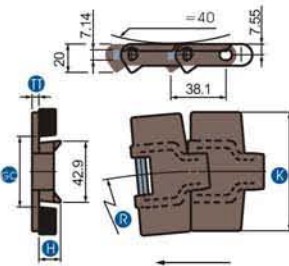

PASO 38.1MM=1 1/2"

CODIGO	MATERIAL	k mm	T mm	H mm	R mm	sc mm	kg/m
JL880-k325	POM	82.5	4	16	457	44.5 41.4	0.89
JL880-k450	POM	114.3	4	16	610	44.5 41.4	1.04

**880TAB**

JL880TAB

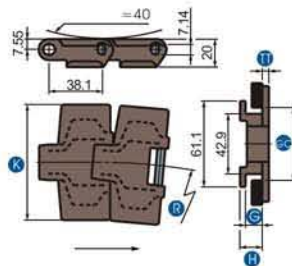

PASO 38.1MM=1 1/2"

CODIGO	MATERIAL	k mm	T mm	G mm	H mm	R mm	sc mm	kg/m
JL880TAB-k325	POM	82.5	4	11.5	16	457	46 44.2	0.94
JL880TAB-k343	POM	87.0	4	11.5	16	500	46 44.2	0.99
JL880TAB-k350	POM	88.9	4	11.5	16	500	46 44.2	1.01
JL880TAB-k450	POM	114.3	4	11.5	16	500	46 44.2	1.08

**880K**

JL880K

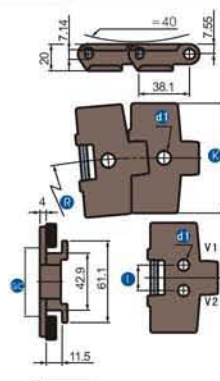

PASO 38.1MM=1 1/2"

CODIGO	MATERIAL	k mm	d1 mm	l mm	R mm	sc mm	kg/m
JL880K-k325 (V1)	POM	82.5	5-6-6.5-8-10		457	46 44.2	0.94
JL880K-k325 (V2)	POM	82.5	6 8	24 20	457	46 44.2	0.94
JL880K-k450 (V2)	POM	114.3	6	24	610	46 44.2	1.08

### JNS880

879, 879B0, 879TAP, 880, 880TAB, 880TAB-K454, HFP879B0, HFP880B0T, HFP880TAB, 880B0, 880B0F, 880B0GB, 880GB, 880TAB, LBP879B0, LPC279

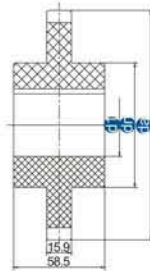

CODIGO	Z	dp mm	dc mm	d1 mm	df mm
JNS880J10	10	123.29	122.5	20 30 35 40	80
JNS880J11	11	135.23	135.0	20 30 35 40	85
JNS880J12	12	147.21	147.4	20 30 35 40	90

NYLON

### JNS880

879, 879B0, 879TAP, 880, 880TAB, 880TAB-K454, HFP879B0, HFP880B0T, HFP880TAB, 880B0, 880B0F, 880B0GB, 880GB, 880TAB, LBP879B0, LPC279

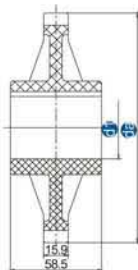

CODIGO	Z	dp mm	dc mm	d1 mm	Kg
JNS880Z10	10	123.29	122.5	25 30 35 40 45	0.30
JNS880Z12	12	147.21	147.4	25 30 35 40 45	0.37

### JKU880

879, 879B0, 879TAP, 880, 880TAB, 880TAB-K454, HFP879B0, HFP880B0T, HFP880TAB, 880B0, 880B0F, 880B0GB, 880GB, 880TAB, LBP879B0, LPC279



CODIGO	Z	dp mm	dc mm	d1 mm
JKU880J10	10	123.29	122.5	20 25 30 35
JKU880J12	12	147.21	147.4	25 30 35

### 882

### JL882

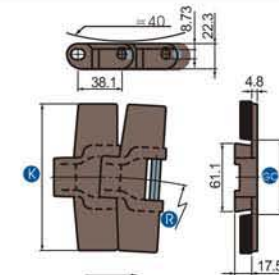

38.1MM=1 1/2"

CODIGO	MATERIAL	k mm	R mm	sc mm	kg/m
JL882-k450	PCM	114.3	610	61.9 58	1.94
JL882-k750	PCM	190.5	610	61.9 58	2.38
JL882-k1000	PCM	254.0	610	61.9 58	2.83

### 882TAB

### JL882TAB

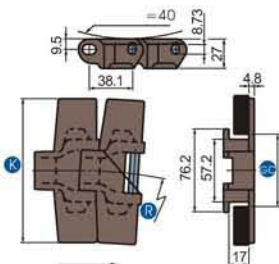

38.1MM=1 1/2"

CODIGO	MATERIAL	k mm	R mm	sc mm	kg/m
JL882TAB-k450	PCM	114.3	610	60 58	1.98
JL882TAB-k750	PCM	190.5	610	60 58	2.43
JL882TAB-k1000	PCM	254.0	610	60 58	2.87
JL882TAB-k1200	PCM	304.8	610	60 58	3.41

### JNS882

882, 882TAB, 882G, HFP882TAB, HFP882TABF, FLBP882TAB, LBP882TAB, SLBP882TAB, LBP883

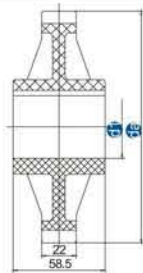

CODIGO	Z	dp mm	dc mm	di mm	Kg
JNS882Z12	12	147.21	149.9	25 30 35 40 45	0.37

### JKU882

882, 882TAB, 882G, HFP882TAB, HFP882TABF, FLBP882TAB, LBP882TAB, SLBP882TAB, LBP883

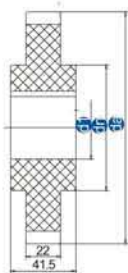

CODIGO	Z	dp mm	dc mm	di mm	dn mm	Kg
JKU882J9	9	111.4	112.0	20	64	0.46
JKU882J10	10	123.2	125.0	25 30 35 40 45	64	
JKU882J11	11	135.2	137.0	25 30 35 40 45	64	
JKU882J12	12	147.2	149.0	25 30 35 40 45	64	

: NYLON

### JNS882

882, 882TAB, 882G, HFP882TAB, HFP882TABF, FLBP882TAB, LBP882TAB, SLBP882TAB, LBP883



CODIGO	Z	dp mm	dc mm	di mm	Kg
JNS882J12	12	147.21	149.9	25 30 35 40 45	0.37

### 1873

### JL1873

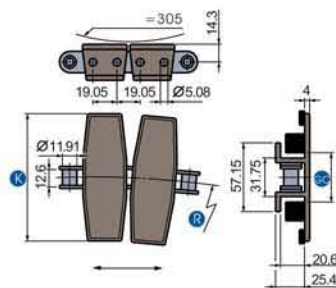

PASO 19.05MM =  $\frac{3}{4}$ "

CODIGO	INOX	k mm	R mm	mm	mm	kg/m
JL1873-k325	304	82.5	356	33.3	34.6	2.1
JL1873-k450	304	114.3	356	33.3	34.6	2.3
JL1873-k600	304	152.4	457	33.3	34.6	2.4
JL1873-k750	304	190.5	457	33.3	34.6	2.6
JL1873-k1000	304	254.0	457	33.3	34.6	2.8
JL1873-k1200	304	304.8	610	33.3	34.6	3.0

### 963

### JL963

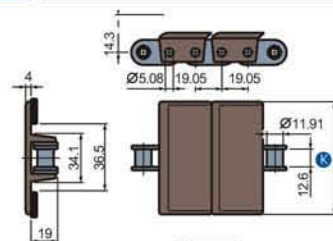

PASO 19.05MM =  $\frac{3}{4}$ "

CODIGO	INOX	k mm	kg/m
JL963-k325	304	82.5	2.10
JL963-k450	304	114.3	2.23
JL963-k600	304	152.4	2.53
JL963-k750	304	190.5	2.68



JL100

963, 1873

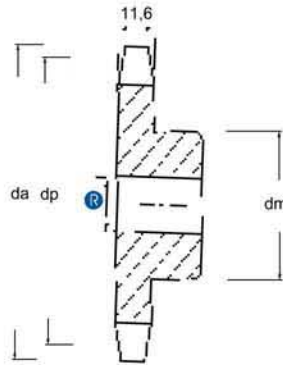

CODIGO	Z	dp mm	da mm	dm mm	R mm
JL100-15	15	91.63	99.8	70	15
JL100-17	17	103.67	111.5	80	15
JL100-19	19	115.75	124.2	80	15
JL100-21	21	127.82	136.0	90	20
JL100-23	23	139.90	149.0	90	20
JL100-25	25	152.00	160.0	90	20
JL100-27	27	164.09	172.3	95	20
JL100-29	29	175.19	184.1	95	20
JL100-31	31	188.31	196.3	100	25

821

JL821G

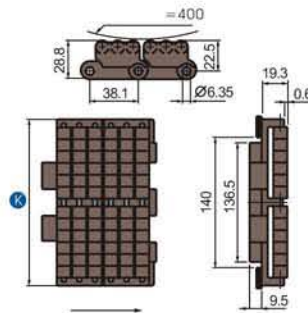

38.1MM=1½"

CODIGO	k mm	kg/m
JL821G-k750	190.5	6.1

882TAB

JL882TAB

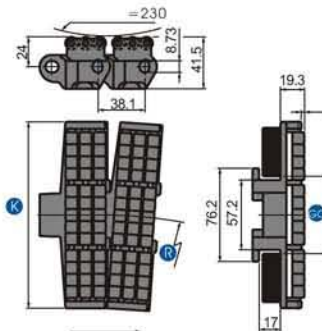

38.1MM=1½"

CODIGO	k mm	R mm	mm	mm	kg/m
JL882TAB-k750	190.5	610	60	58	3.9

883TAB

JL883TAB

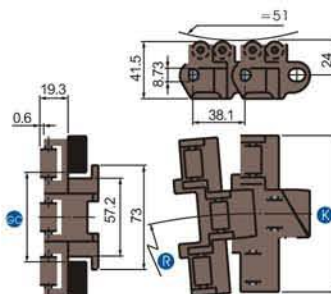

38.1MM=1½"

CODIGO	k mm	R mm	mm	mm	kg/m
JL883TAB-k450	114.3	610	60	58	2.5
JL883TAB-k750	190.5	610	60	58	3.4

1700K

JL1700K

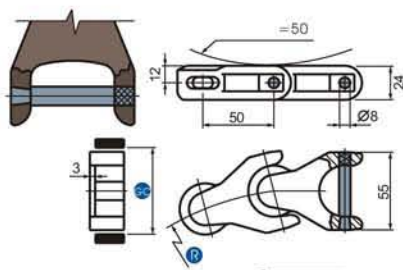

PASO: 50MM

CODIGO	PASADOR				kg/m
	INOX	R mm	mm	mm	
JL1700K	304	140	58	-	1.26

1701

JL1701

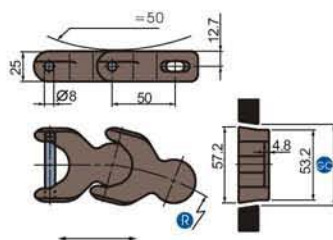

PASO: 50MM

CODIGO	PASADOR				kg/m
	INOX	R mm	mm	mm	
JL1701	304	140	59.5	55.6	1.42

1702

JL1702

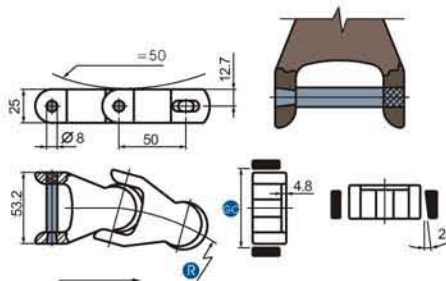

PASO: 50MM

CODIGO	PASADOR				kg/m
	INOX	R mm	mm	mm	
JL1702	304	140	59.5	56.8	1.43

1716K

JL1716K

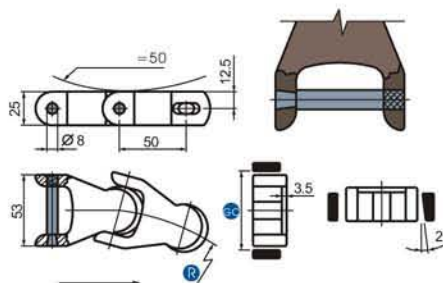

PASO: 50MM

CODIGO	PASADOR				kg/m
	INOX	R mm	mm	mm	
JL1716K	304	170	59.5	56.8	1.77

1790K

JL1790K

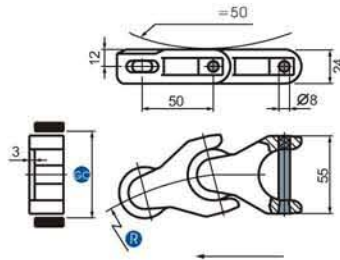

PASO: 50MM

CODIGO	PASADOR	mm	mm	mm	kg/m
	INOX				
JL1790K	304	140	58	58	1.26

JKU1700

JKU1700

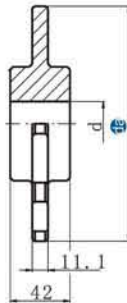

CODIGO	Z	mm	EJE			
			d- mm	D- inch		
JKU1700-T8R	8	136	25 30 35 40 45	1" 1-1/4" 1-1/2"		
JKU1700-T10R	10	165	25 30 35 40 45	1" 1-1/4" 1-1/2"		
JKU1700-T13R	13	215	25 30 35 40 45	1" 1-1/4" 1-1/2"		

JL1700Z, JL1700S

JL1700Z, JL1700S

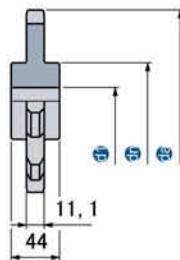

CODIGO	Z	mm				Kg
		mm	mm	mm	mm	
JL1700ZT10R20	10	161.8	165.1	20	69(69')	2.42
JL1700ZT12R20	12	193.19	196.1	20	69	2.95

A600 A1400

JLA600, JLA1400

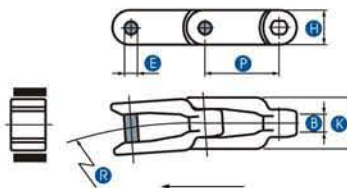

CODIGO	mm					kg/m
	P	k	E	B	H	
JLA600	63.5	43	11	14.3	29	1.44
JLA1400	82.5	50	11	15.9	38	2.08

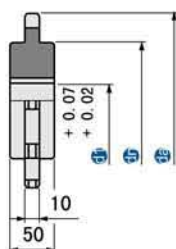
**JL600A**
**JL600A**

CODIGO	Z	d <sub>1</sub> mm	d <sub>2</sub> mm	R <sub>d</sub> mm	CUAD mm	d <sub>f</sub> mm	Kg
JL600A T06R20	6	127	128	20	—	74	0.36
JL600A T08R20	8	165.93	177.7	20	—	119	0.65
JL600A T10R35	10	205.49	219.3	25	—	161	1.30
JL600A T06S40	6	127	128	—	40X40	74	0.36
JL600A T08S50	8	165.93	177.7	—	40X40 50X50	119	0.65
JL600A T10S50	10	205.49	219.3	—	40X40 50X50	161	1.30

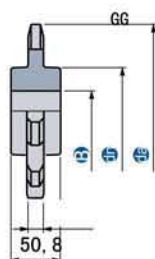
**JL600B**
**JL600B**

CODIGO	Z	d <sub>1</sub> mm	d <sub>2</sub> mm	B mm	d <sub>f</sub> mm	Kg
JL600B T08R19	8	165.86	171.4	19	95	3.4
JL600B T10R19	10	205.49	213.6	19	95	5.7
JL600B T12R19	12	245.36	255.2	19	95	8.2
JL600B T14R19	14	285.50	296.4	19	95	9.0

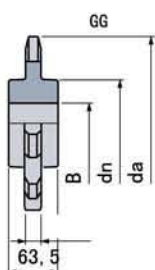
**JL600C**
**JL600C**

CODIGO	Z	d <sub>1</sub> mm	d <sub>2</sub> mm	B mm	d <sub>f</sub> mm	Kg
JL600C T10R19	10	267.20	292.6	19	102	13.3

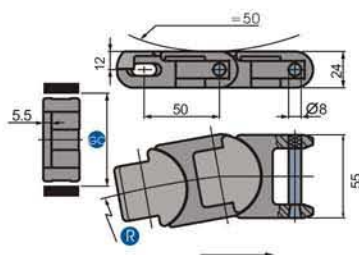
**55**
**JL55**

**PASO: 50MM**

CODIGO	PASADOR	R <sub>d</sub> mm	mm	d <sub>f</sub> mm	kg/m
	INOX	mm	mm	mm	
JL55	304	125	58	58	1.45

1060

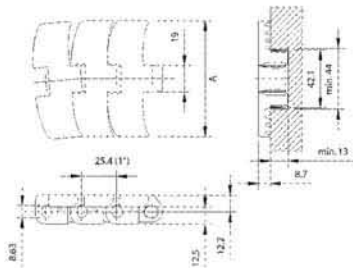
JL1060



CODIGO	A		R	kg/m
	mm	in		
JL1060	83.8	3.3	500	1.68

1050

JL1050

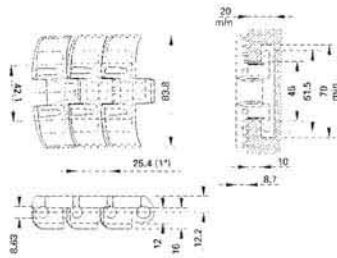

CODIGO	A		R	kg/m
	mm	in		
JL1050	83.8	3.3	500	1.54

EJES ( UNI 6604-69/ISO773)

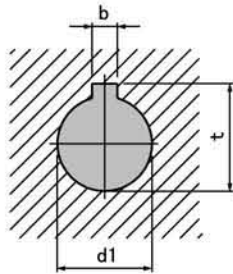

d1 mm	b m		t m	
	nom	toll.	nom	toll.
25	8	+0.036 0	28.3	+0.2 0
30	8		33.3	
35	10		38.3	
40	12	+0.043 0	43.3	
45	14		48.8	
50	14		53.8	
60	18		64.4	

EJES ( inch )

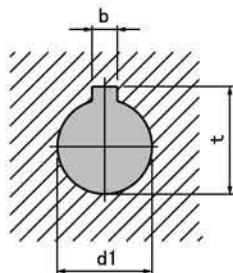

d1 inc	b inc		t inc	
	min	ma	min	ma
1 "	0.250	0.252	1.114	1.124
1 1/4 "	0.250	0.252	1.367	1.377
1 1/2 "	0.375	0.377	1.669	1.679
1 3/4 "	0.375	0.377	1.922	1.932
2 "	0.500	0.502	2.223	2.233

CURVAS

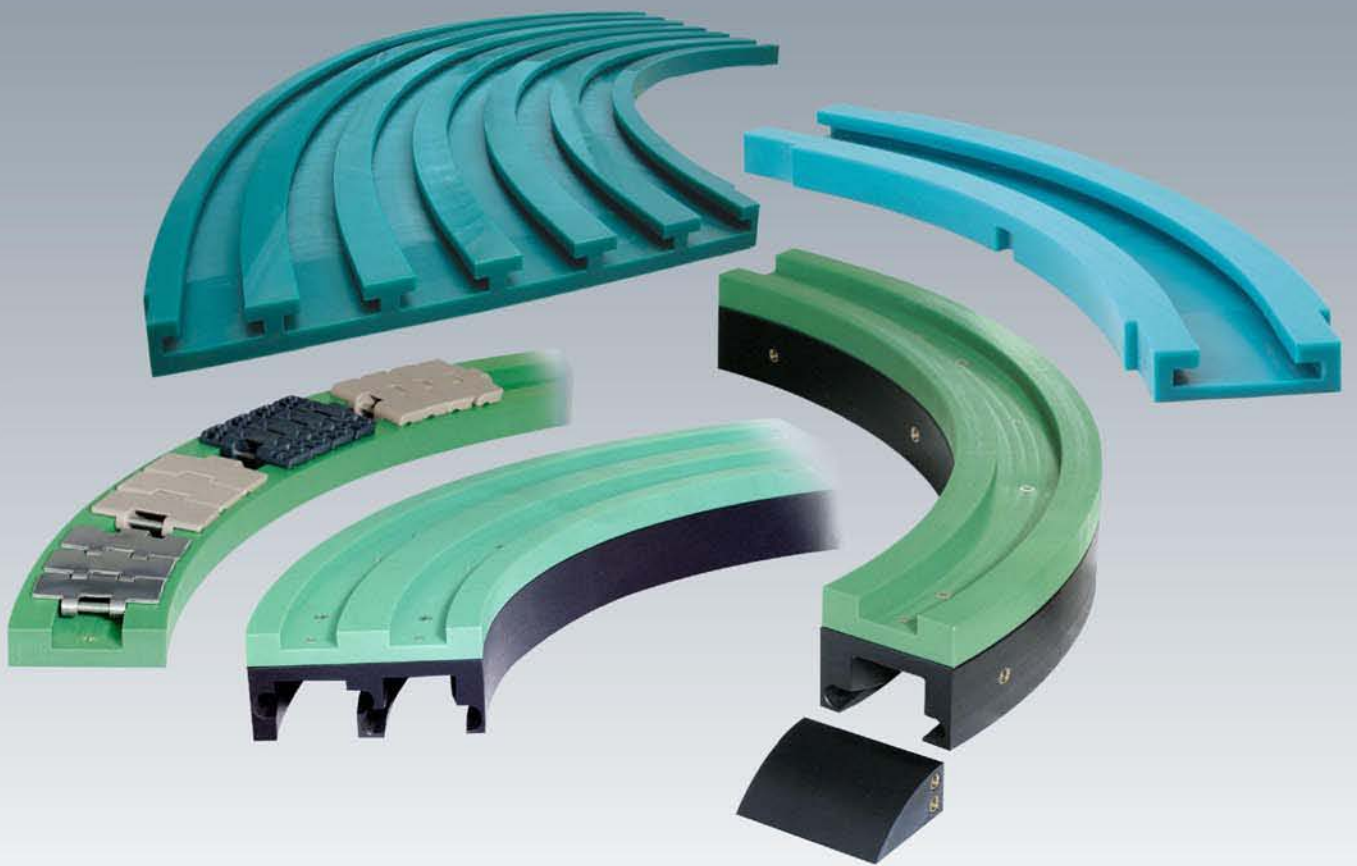



KMU MAGNETICA

881M

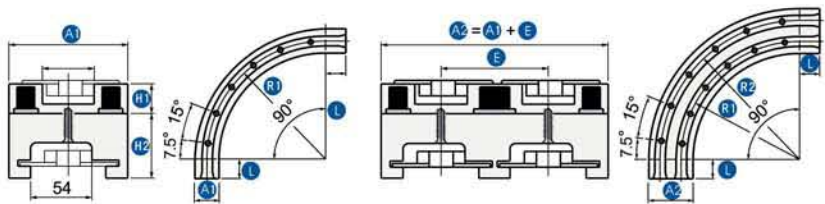
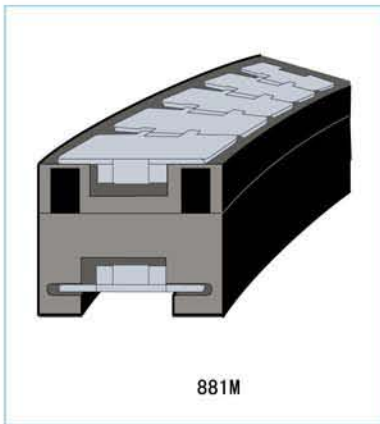

CODIGO	CADENA	mm	R1 mm	A1 mm	L mm	B1 <sup>+0.5</sup> mm	H1 mm	H2 mm	E mm
KMU881K325A	881M	82.5	500	100	-	44.2	27	55	90
KMU881K325B		82.5	500	100	125	44.2	27	55	89
KMU881K325C		82.5	500	111	100	44.2	27	55(63)	85
KMU881K325D		82.5	680	100	100	44.2	27	55	90
KMU881K325E		82.5	860	100	125	44.2	27	55	90
KMU881K330		83.8	500	100	100	44.2	27	63	85
KMU881K450A		114.3	500	129	125	44.2	27	63	120
KMU881K450B		114.3	610	129	125	44.2	27	55(63)	120
KMU881K750		190.5	610	214	125	44.2	27	55	196

COMBI MAGNETICA

881M, 881MG

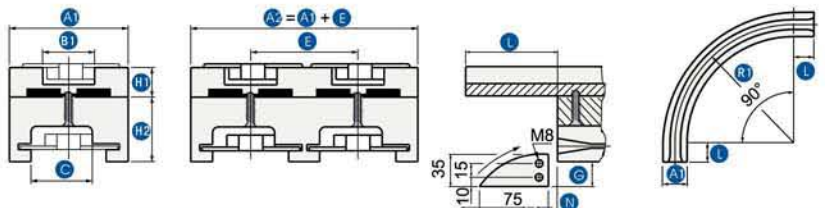
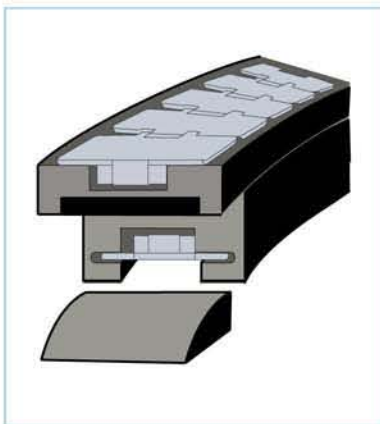

CODIGO	CADENA	mm	R1 mm	A1 mm	L mm	B1 <sup>+0.5</sup> mm	C mm	H1 mm	H2 mm	E mm	N mm	G mm
COMBI881K325A	880G, 881	82.5	500	100	100	44	50	27	55	90	GAP0	30
COMBI881K325B		82.5	500	100	125	44	50	27	55	89	GAP0	30
COMBI881K325C		82.5	500	111	100	44	50	27	63	85	20	20
COMBI880G325A		82.5	680	100	100	44	50	27	55	90	GAP0	30
COMBI880G325B		82.5	860	100	125	44	50	27	55	90	GAP0	30
COMBI881K330		83.8	500	100	100	44	50	27	63	85	20	20
COMBI881K450A		114.3	500	129	125	44	54	27	63	120	20	20
COMBI881K450B		114.3	610	129	125	44	54	27	63	120	20	20
COMBI881K750		190.5	610	214	125	44	54	27	55	196	20	20



**KSU COLA DE MILANO** 880, 881, 8811

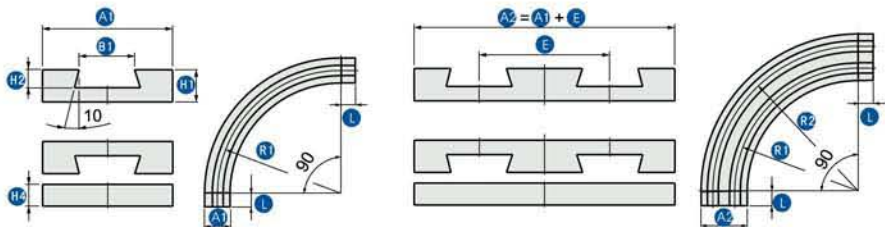
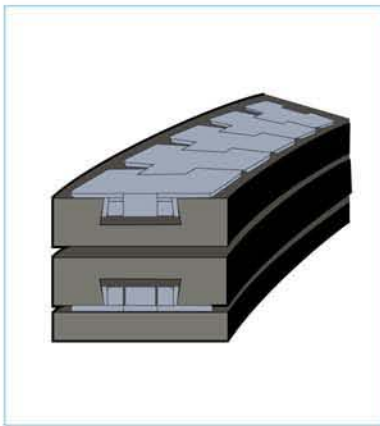

CODIGO	CADENA	mm	R1 mm	A1 mm	L mm	B1 <sup>+0.5</sup> mm	H1 mm	H2 mm	H4 mm	E mm
KSU880K325	880, 881, 8811	500	100	-	41.4	25	18	16	90	
KSU881K325		82.5	500	100	-	41.4	25	18	16	90
KSU8811K325		500	100	50	41.4	25	17	15	-	
KSU880K450		114.3	610	125	-	41.4	25	18	16	120
KSU881K450		114.3	610	130	50	41.4	25	17	16	-
KSU8811K450		114.3	610	130	50	41.4	25	17	15	-
KSU881K750		190.5	610	200	-	41.4	25	18	16	195
KSU8811K750		190.5	610	210	50	41.4	25	17	15	-

**SSU COLA DE MILANO** 880, 881, 8811

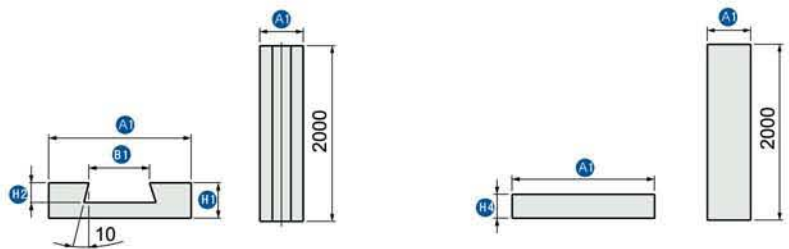
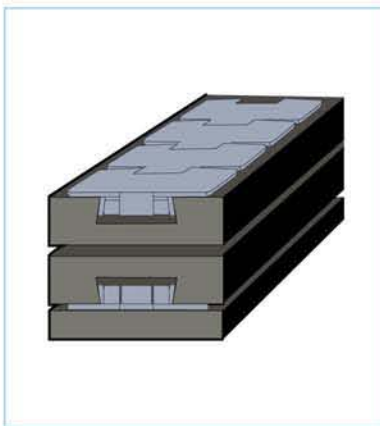

CODIGO	CADENA	mm	A1 mm	B1 <sup>+0.5</sup> mm	H1 mm	H2 mm	H4 mm
SSU880K325	880, 881, 8811	82.5	100	41.4	25	17	15
SSU881K325		82.5	100	41.4	25	17	15
SSU8811K325		82.5	100	41.4	25	17	15
SSU880K450		114.3	130	41.4	25	17	15
SSU881K450		114.3	130	41.4	25	17	15
SSU8811K450		114.3	130	41.4	25	17	15





**KTU** **880 TAB**

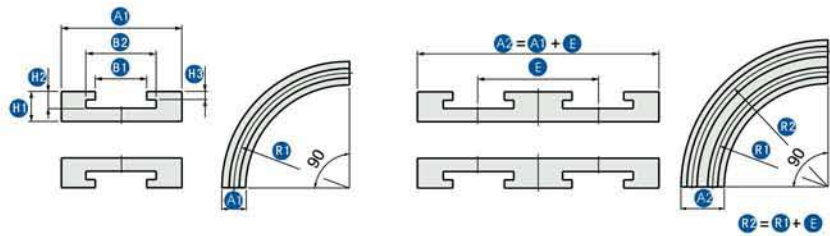
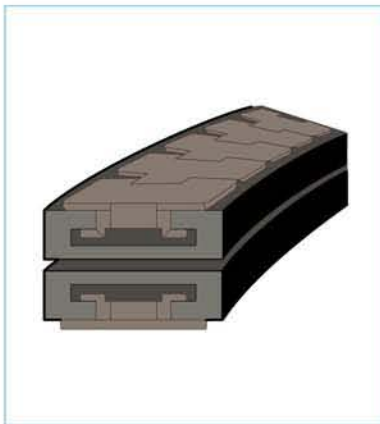

CODIGO	CADENA	mm	R1 mm	A1 mm	B1 mm	B2 mm	E mm	H1 mm	H2 mm	H3 mm
KTU880TABK325	880TAB	82.5	500	100	45	70	90	25	18	9.5
KTU880TABK450		114.3	610	125	45	70	120	25	18	9.5
KTU880TABK750		190.5	610	200	45	70	195	25	18	9.5

**KTU200** **882TAB**

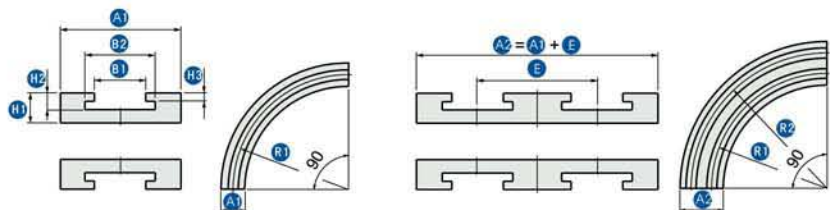
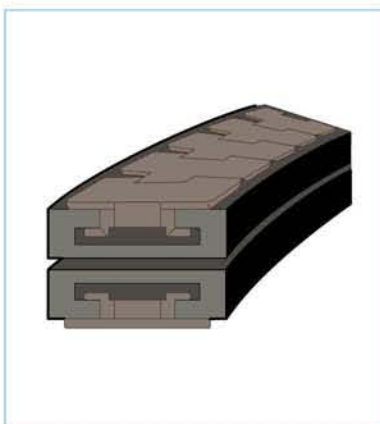

CODIGO	CADENA	mm	R1 mm	A1 mm	B1 mm	B2 mm	E mm	H1 mm	H2 mm	H3 mm
KTU882TABK450	882TAB	114.3	610	130	60	84	120	30	24	15
KTU882TABK750		190.5	610	210	60	84	195	30	24	15
KTU882TABK1000		254.0	610	270	60	84	260	30	24	15
KTU882TABK1200		304.8	610	320	60	84	310	30	24	15

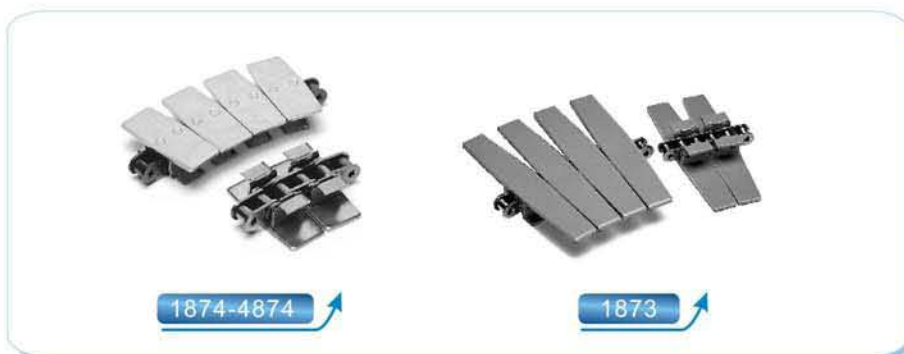

### KTU300

1874-4874, 1873

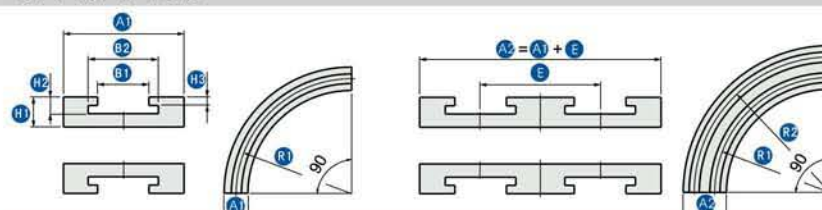
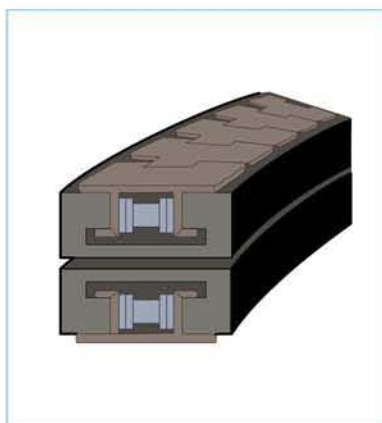

CODIGO	CADENA	mm	R1 mm	A1 mm	B1 mm	B2 mm	H1 mm	H2 mm	H3 mm	E mm
KTU1873K325	1873 1874 4874	82.5	500	100	34.6	70	36	29	19	90
KTU1874K325		82.5	500	100	34.6	70	36	29	19	90
KTU4874K325		82.5	500	100	34.6	70	36	29	19	90
KTU1873K450		114.3	500	125	34.6	70	36	29	19	120
KTU1874K450		114.3	500	125	34.6	70	36	29	19	120
KTU1873K600		152.4	610	160	34.6	70	36	29	19	160
KTU1874K600		152.4	610	160	34.6	70	36	29	19	160
KTU4874K600		152.4	610	160	34.6	70	36	29	19	160
KTU1873K750		190.5	610	200	34.6	70	36	29	19	195
KTU1874K750		190.5	610	200	34.6	70	36	29	19	195
KTU4874K750		190.5	610	200	34.6	70	36	29	19	195
KTU1873K1000		254.0	610	260	34.6	70	36	29	19	260
KTU1873K1200		304.8	610	310	34.6	70	36	29	19	310

### STU300

1874-4874, 1873

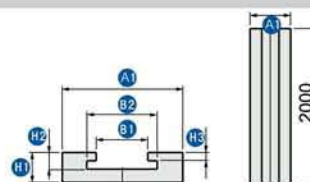
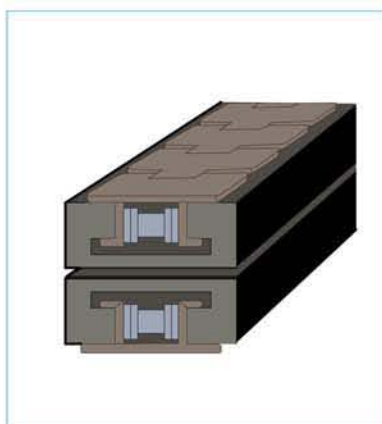

CODIGO	CADENA	mm	A1 mm	B1 mm	B2 mm	H1 mm	H2 mm	H3 mm
STU1873K325	1873 1874 4874	82.5	100	34.6	70	36	29	19
STU1874K325		82.5	100	34.6	70	36	29	19
STU4874K325		82.5	100	34.6	70	36	29	19
STU1873K450		114.3	125	34.6	70	36	29	19
STU1874K450		114.3	125	34.6	70	36	29	19
STU1873K600		152.4	160	34.6	70	36	29	19
STU1874K600		152.4	160	34.6	70	36	29	19
STU4874K600		152.4	160	34.6	70	36	29	19
STU1873K750		190.5	200	34.6	70	36	29	19
STU1874K750		190.5	200	34.6	70	36	29	19
STU4874K750		190.5	200	34.6	70	36	29	19
STU1873K1000		254.0	260	34.6	70	36	29	19
STU1873K1200		304.8	310	34.6	70	36	29	19



KTU200

SLBP882TAB, LBP883TAB

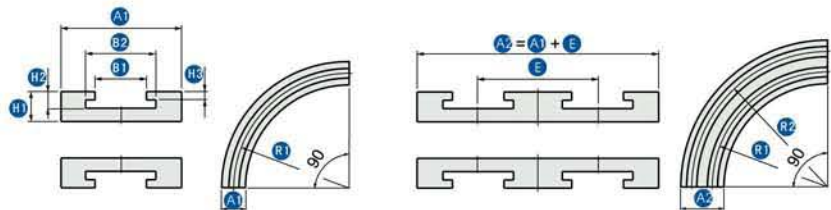
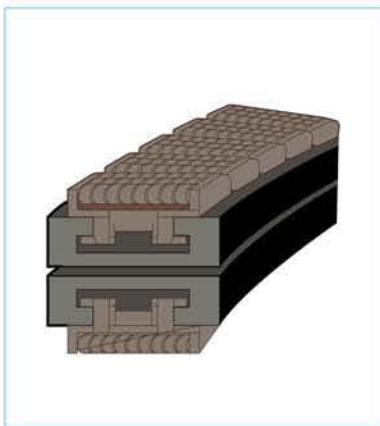

MATERIAL	CADENA	mm	$R_1$ mm	$A_1$ mm	$B_1$ mm	$B_2$ mm	E mm	$H_1$ mm	$H_2$ mm	$H_3$ mm
KTU LBP882TABK375	LBP882	95.2	700	110	60	84	160	30	24	15
KTU SLBP882TABK375	SLBP882TAB	95.2	700	110	60	84	160	30	24	15
KTU FLBP882TABK375	LBP883TAB	95.2	700	110	60	84	160	30	24	15

STU200

SLBP882TAB, LBP883TAB

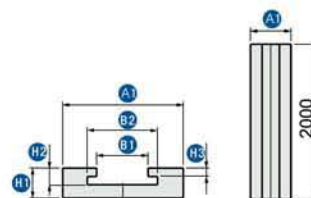
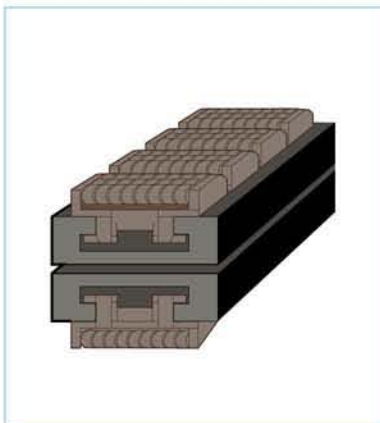

MATERIAL	CADENA	mm	$A_1$ mm	$B_1$ mm	$B_2$ mm	$H_1$ mm	$H_2$ mm	$H_3$ mm
STU LBP882TABK375	LBP882	95.2	110	60	84	30	24	15
STU SLBP882TABK375	SLBP882TAB	95.2	110	60	84	30	24	15
STU FLBP882TABK375	LBP883TAB	95.2	110	60	84	30	24	15



**KTU500** 1700TABK-1701TABK, 1710TABK, 1713TABK

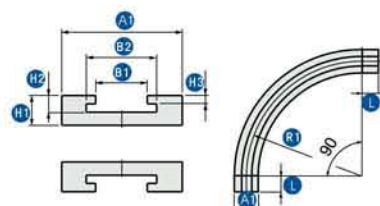
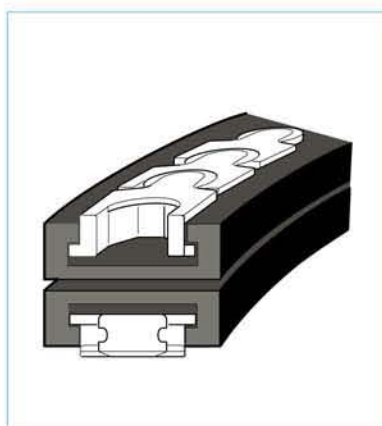

CODIGO	CADENA	mm	R1 mm	A1 mm	B1 mm	B2 mm	H1 mm	H2 mm	H3 mm	L mm
KTU1700TAB K	1700TAB K	55	250	100	58	70	40	21	12	50
KTU1701TAB K	1701TAB K	55	500	100	58	70	40	21	12	50
KTU1710TAB K1	1710TAB K	98	250	110	58	70	40	21	22	50
KTU1710TAB K2	1710TAB K	98	500	110	58	70	40	21	22	50
KTU1713TAB K	1713TAB K	253	500	270	58	70	40	30.5	20	50

**STU500** 1700TABK-1701TABK, 1710TABK, 1713TABK

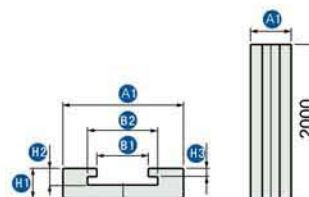
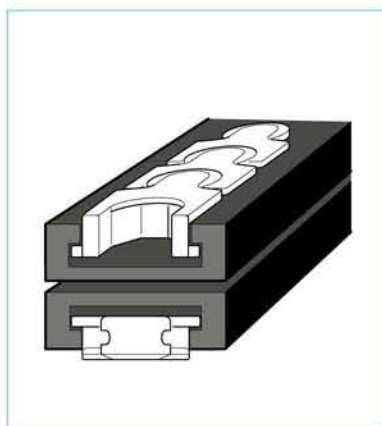

CODIGO	CADENA	mm	A1 mm	B1 mm	B2 mm	H1 mm	H2 mm	H3 mm
STU1700TAB K	1700TAB K	55	100	58	70	40	21	12
STU1701TAB K	1701TAB K	55	100	58	70	40	21	12
STU1710TAB K	1710TAB K	98	110	58	70	40	31	22
STU1713TAB K	1713TAB K	253	270	58	70	40	30	20

ACCESORIOS Y COMPONENTES  
PARA  
CINTAS TRANSPORTADORAS

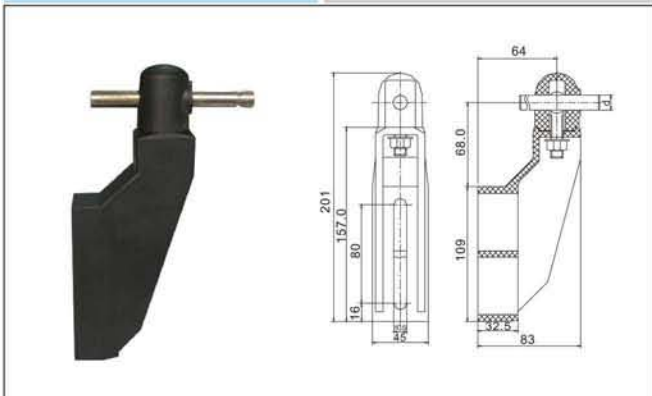
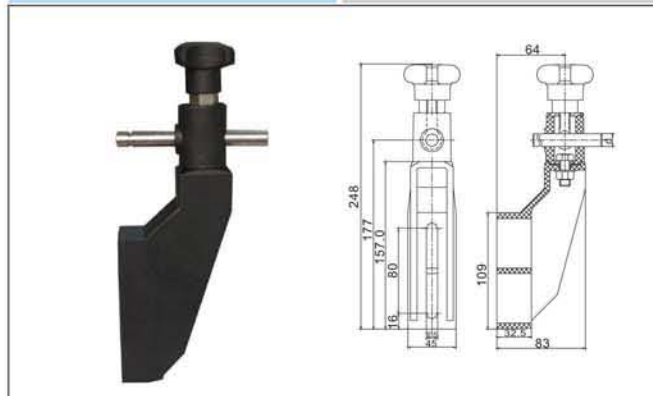
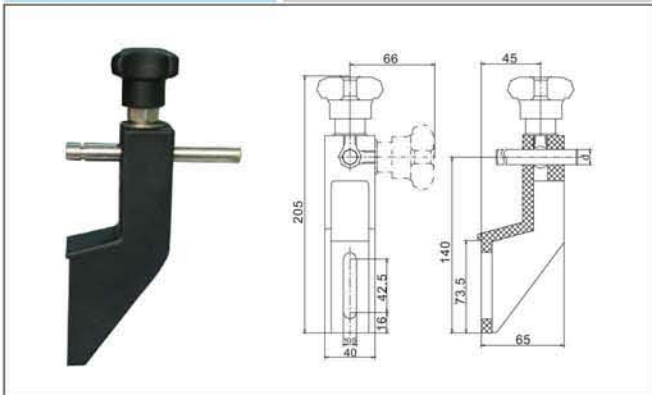
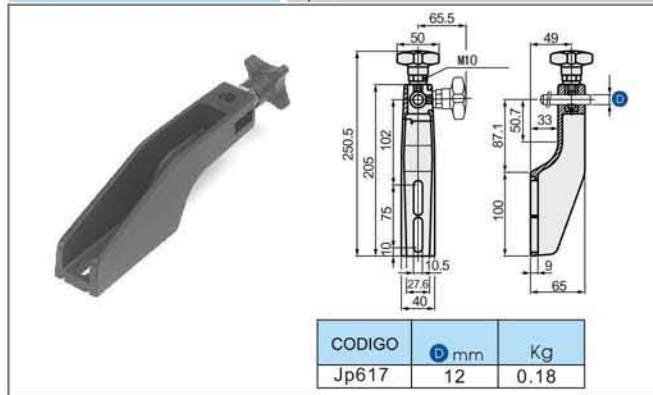
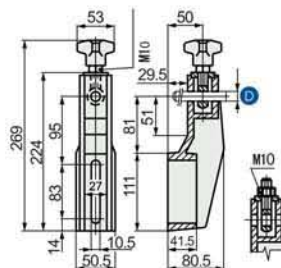

**SOPORTE ORIENTABLE JP234**

**SOPORTE ORIENTABLE JP235**

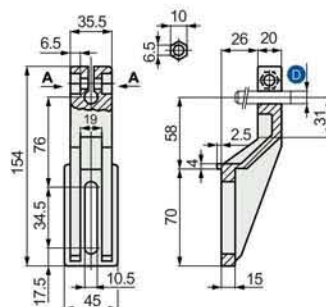
**SOPORTE FIJO JP236**

**SOPORTE FIJO Jp617**

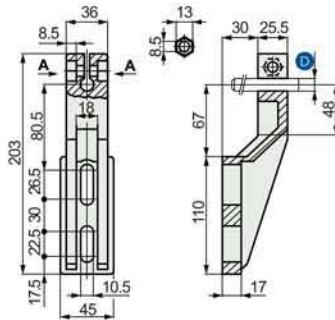
**SOPORTE FIJO Jp140**

CODIGO	Ø mm	Kg
Jp140A	14	0.47
Jp140B	16	0.47

**SOPORTE FIJO :Jp81**

CODIGO	Ø mm	Kg
Jp81A	12	0.11
Jp81B	14	0.11

**SOPORTE FIJO**
**Jp72**

CODIGO	$\varnothing$ mm	Kg
Jp72A	14	0.17
Jp72B	16	0.17
Jp72C	14	0.17
Jp72D	16	0.17

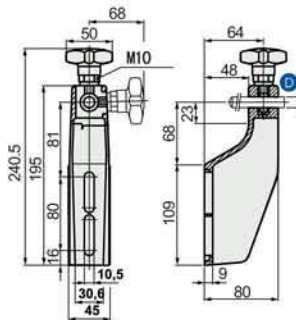
**SOPORTE FIJO**
**Jp599**

CODIGO	$\varnothing$ mm	Kg
Jp599	12	0.11

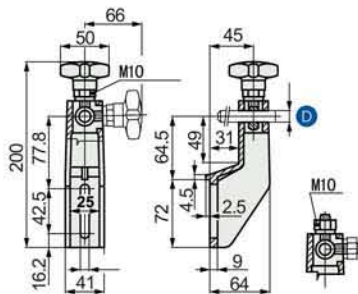
**SOPORTE FIJO PEQUEÑO**
**Jp107**

CODIGO	$\varnothing$ mm	Kg
Jp107A	12	0.15
Jp107B	14	0.15

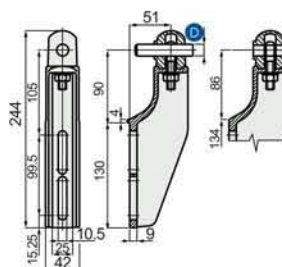
**SOPORTE ORIENTABLE**
**Jp542**

CODIGO	$\varnothing$ mm	Kg
Jp542A	12	0.15
Jp542B	14	0.15
Jp542C	16	0.15
Jp542D	12	0.15
Jp542E	14	0.15
Jp542F	16	0.15

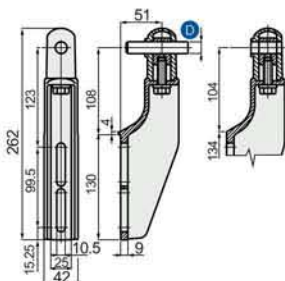
**SOPORTE ORIENTABLE**
**Jp541**

CODIGO	Ø mm	Kg
Jp541A	12	0.15
Jp541B	14	0.15
Jp541C	16	0.15
Jp541D	12	0.15
Jp541E	14	0.15
Jp541F	16	0.15

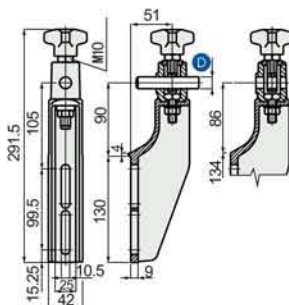
**SOPORTE ORIENTABLE**
**Jp544**

CODIGO	Ø mm	Kg
Jp544A	12	0.15
Jp544B	14	0.15
Jp544C	16	0.15
Jp544D	12	0.15
Jp544E	14	0.15
Jp544F	16	0.15

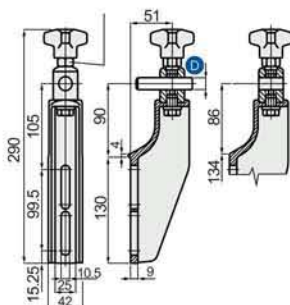
**SOPORTE ORIENTABLE**
**Jp543**

CODIGO	MAT	Ø mm	Kg
Jp543A	304	14	0.15
Jp543B		15	0.15
Jp543C		16	0.15
Jp543D	304	14	0.15
Jp543E		15	0.15
Jp543F		16	0.15

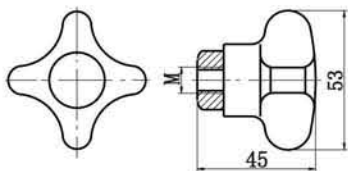
**MARIPOSA HEMBRA**
**Jp183**

CODIGO	Ø mm
Jp183A	M10
Jp183B	M8

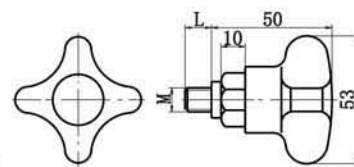
**MARIPOSA MACHO**
**Jp185**

CODIGO	Ø mm	L mm	MAT
Jp185A	M8	16	304
Jp185B	M10	11	304
Jp185C	M10	17	304

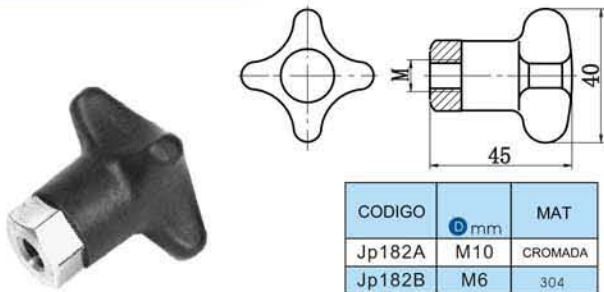

**MARIPOSA HEMBRA**
**Jp182**

CODIGO	D mm	MAT
Jp182A	M10	CROMADA
Jp182B	M6	304
Jp182C	M8	304
Jp182D	M10	304
Jp182E	M12	304

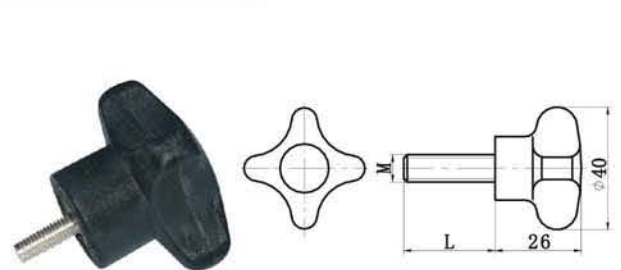
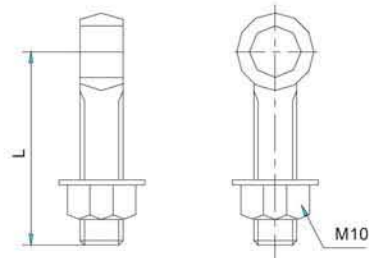
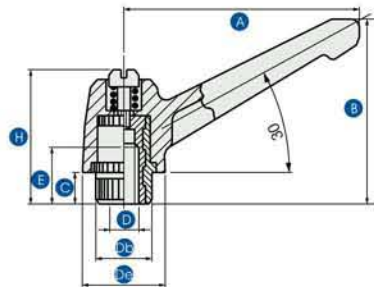
**MARIPOSA MACHO**
**Jp181**

**CANCAMO INOX**
**Jp180**

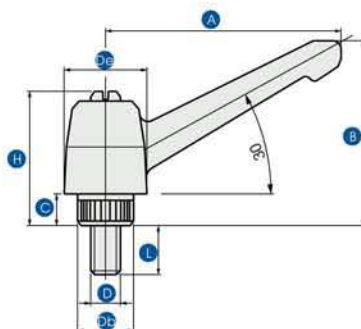
**MANILLA DE AJUSTE HEMBRA**
**Jp302**

CODIGO	D mm	A mm	B mm	C mm	E mm	H mm	Dc mm	Dc1 mm
Jp302A	M6	40	40	7	12	19	11	16
Jp302B	M8	55	51	9	14	36	14	20
Jp302C	M10	79	67	11	20	48	20	28

**MANILLA DE AJUSTE MACHO**
**Jp303**

CODIGO	D mm	A mm	B mm	C mm	E mm	H mm	Dc mm	Dc1 mm
Jp303A	M6	40	40	7	20	19	11	16
Jp303B	M8	55	51	9	25	36	14	20
Jp303C	M10	79	67	11	30	48	20	28

CABEZA ORIENTABLE

Jp256

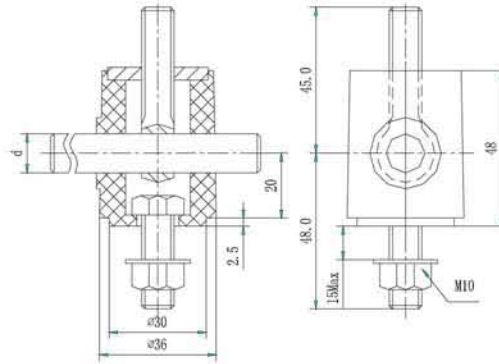

CABEZA ORIENTABLE

Jp192

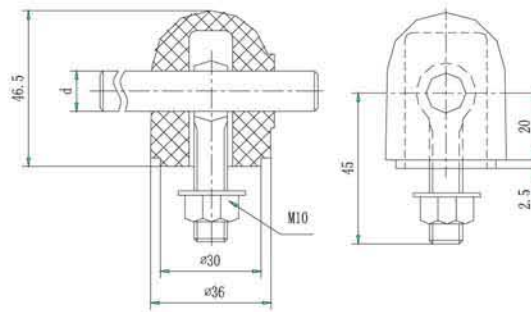

BASE SOPORTE LATERAL

Jp186

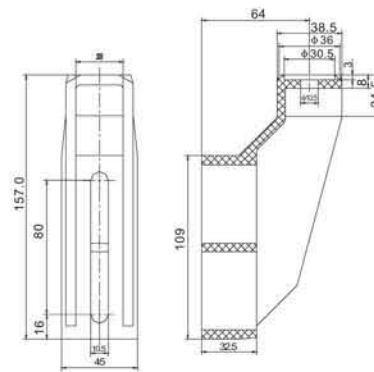

SEPARADOR LATERAL

Jp142

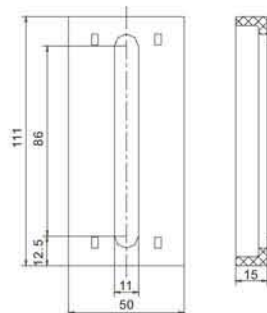

CODIGO	Kg
Jp142	0.06

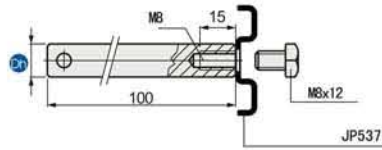
**VASTAGO HEMBRA M8**
**Jp535**

CODIGO	Ø mm	Kg
Jp535A	12	0.12
Jp535B	14	0.12

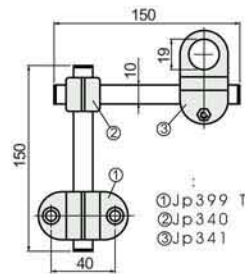
**SET PORTA-SENSOR**
**Jp342**

CODIGO	Kg
Jp342	0.14

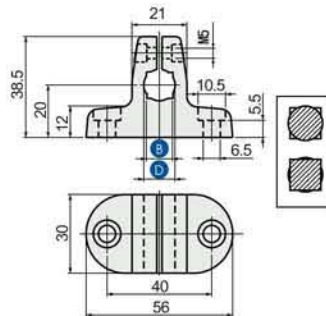
**MORDAZA T**
**Jp339**

CODIGO	MAT PERNO	Ø mm		Kg
		b	B	
Jp339A	304	10	8	0.03
Jp339B		12	10	0.03
Jp339C		14	12	0.03
Jp339D	ZINC	10	8	0.03
Jp339E		12	10	0.03
Jp339F		14	12	0.03

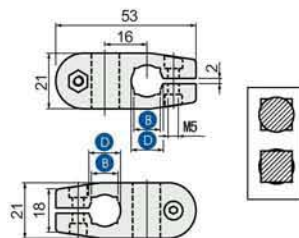
**MORDAZA CRUZ**
**Jp340**

CODIGO	MAT PERNO	Ø mm		Kg
		b	B	
Jp340A	304	10	8	0.02
Jp340B		12	10	0.02
Jp340C		14	12	0.02
Jp340D	ZINC	10	8	0.02
Jp340E		12	10	0.02
Jp340F		14	12	0.02

PORTA-SENSOR

Jp341

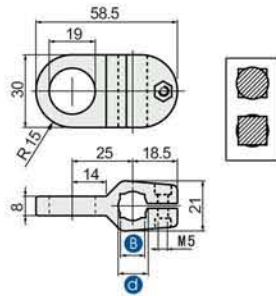

CODIGO	MAT PERNO	Ø mm	B mm	Kg
Jp341A	304	10	8	0.02
Jp341B	304	12	10	0.02
Jp341C	304	14	12	0.02
Jp341D	ZINC	10	8	0.02
Jp341E	ZINC	12	10	0.02
Jp341F	ZINC	14	12	0.02

MORDAZA T

Jp595

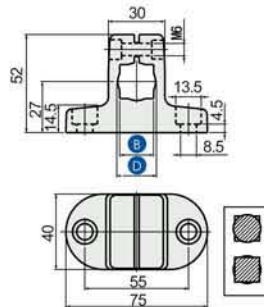

CODIGO	MAT PERNO	Ø mm	B mm	Kg
Jp595A	304	16	14	0.07
Jp595B		18	16	0.07
Jp595C		20	18	0.07
Jp595D	ZINC	16	14	0.07
Jp595E		18	16	0.07
Jp595F		20	18	0.07

AMARRA CRUZ

Jp609

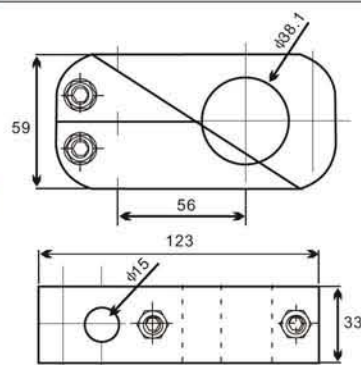

AMARRA CRUZ

Jp610

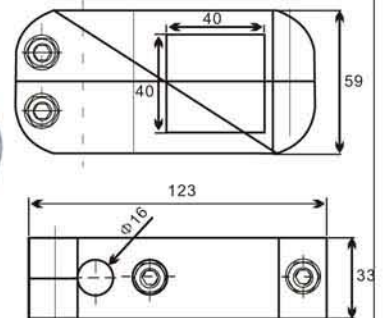

MORDAZA CRUZ

Jp174

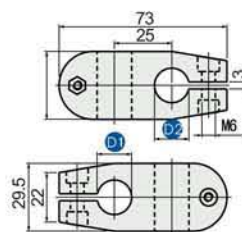

CODIGO	Ø1 mm	Ø2 mm	Kg
Jp174A	14	14	0.07
Jp174B	14	15	0.07
Jp174C	14	16	0.07
Jp174D	14	18	0.07
Jp174E	15	15	0.07
Jp174F	15	16	0.07
Jp174G	15	18	0.07
Jp174H	16	16	0.07
Jp174I	16	18	0.07
Jp174J	18	18	0.07

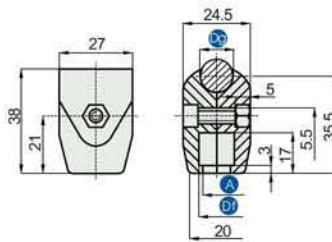
**MORDAZA SIMPLE CILINDRICA**
**Jp82**

CODIGO	MAT PERNO	Ø mm	A mm	Ø <sub>2</sub> mm	Kg
Jp82A	INOX	12	10	12	0.01
Jp82B		12	10	14	0.01
Jp82C		13.5	11.5	12	0.01
Jp82D		13.5	11.5	14	0.01
Jp82E	ZINC	12	10	12	0.01
Jp82F		12	10	14	0.01
Jp82G		13.5	11.5	12	0.01
Jp82H		13.5	11.5	14	0.01

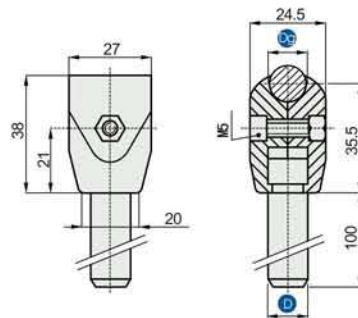
**MORDAZA SIMPLE CILINDRICA C/ VASTAGO**
**Jp82P**

CODIGO	VASTAGO	Ø mm	Ø <sub>2</sub> mm	Kg
Jp82P1	INOX	12	12	0.12
Jp82P2		12	14	0.12
Jp82P3		14	12	0.15
Jp82P4		14	14	0.15

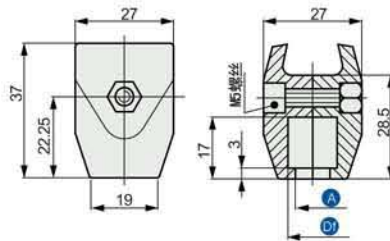
**MORDAZA SIMPLE CONICA**
**Jp210**

CODIGO	MAT PERNO	Ø mm	A mm	Kg
Jp210A	INOX	12	10	0.02
Jp210B		13.5	11.5	0.02

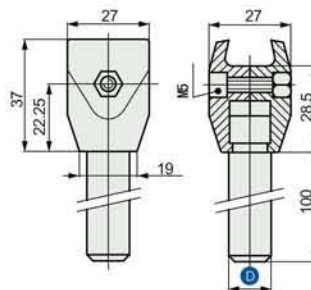
**MORDAZA SIMPLE CONICA C/VASTAGO**
**Jp210P**

CODIGO	VASTAGO	Ø mm	Kg
Jp210P1	INOX	12	0.12
Jp210P2		14	0.15

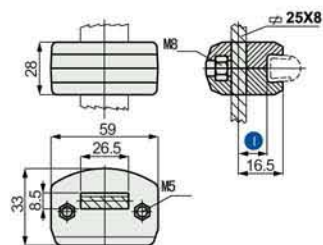
**MORDAZA CONICA DESLIZANTE**
**Jp211**

CODIGO	MAT PERNO	Ø mm	Kg
Jp211	INOX	8	0.05

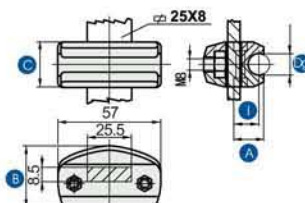
**MORDAZA CILINDRICA DESLIZANTE**
**Jp159, Jp437**

CODIGO	MAT PERNO	Ø <sub>A</sub> mm	Ø mm	A mm	B mm	C mm	Kg
Jp159A	INOX	8	12	15.5	32.5	21	0.05
Jp159B		10	12	15.8	32.5	21	0.05
Jp159C		12	14	17.8	35.0	25	0.05
Jp159D		14	15	19.5	35.0	25	0.05
Jp437		12	18	22.0	41.0	25	0.05

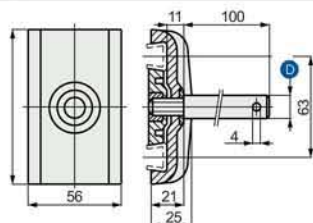
**MORDAZA DOBLE CONICA**
**Jp213**

CODIGO	MAT VASTAGO	Ø mm	Kg
Jp213A	INOX	12	0.19
Jp213B		14	0.22
Jp213C		16	0.25

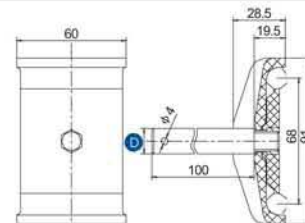
**MORDAZA DOBLE CILINDRICA**
**Jp214**

CODIGO	MAT VASTAGO	Ø mm	Kg
Jp214A	INOX	12	0.19
Jp214B		14	0.22
Jp214C		16	0.25

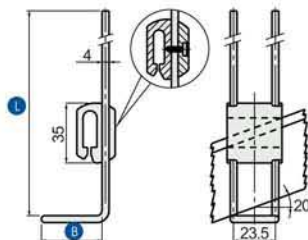
**SOPORTE DE BANDEJA**
**Jp225**

CODIGO	MAT	Ø mm	B mm	Kg
Jp225	INOX	200	35	0.06

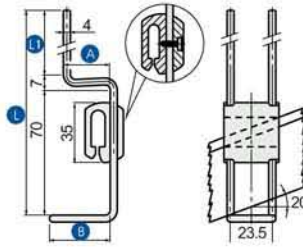
**SOPORTE DE BANDEJA**
**Jp226**

CODIGO	L mm	l <sub>1</sub> mm	A mm	B mm	Kg
Jp226A	180	103	14	35	0.06
Jp226B	180	103	17	35	0.06
Jp226C	180	103	27	35	0.06
Jp226D	180	103	27	50	0.06
Jp226E	180	103	27	50	0.06
Jp226F	200	123	38	35	0.06
Jp226G	230	153	27	35	0.06
Jp226H	310	233	18	35	0.06

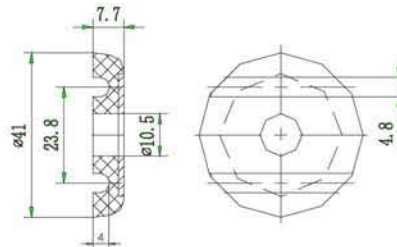
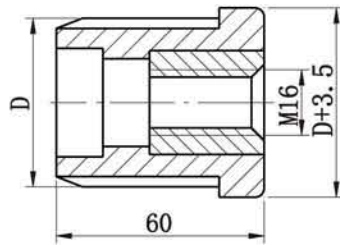
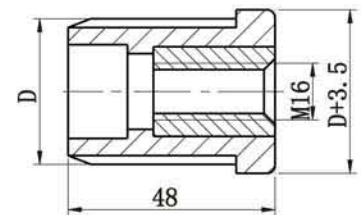
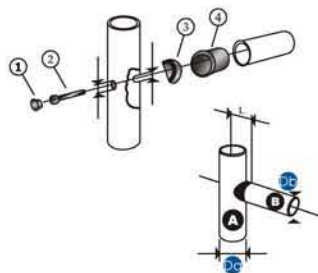
**ARANDELA FIJACION SOPORTE DE BANDEJA**
**Jp227**

**TAPON HILADO REDONDO**
**Jp178**

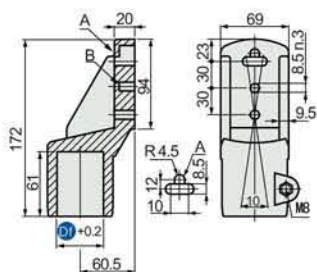
**TAPON HILADO CUADRADO**
**Jp179**

**JUNTA DE CONEXION SIMPLE**
**Jp409**

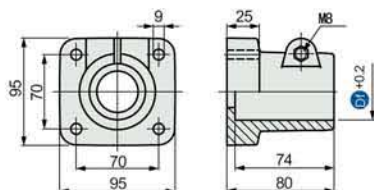
CODIGO	A mm	B mm	B ESPESOR mm
Jp409A	38	38	1.5
Jp409B	42.4	38	1.5
Jp409C	42.4	42.4	1.5
Jp409D	48.3	38	1.5
Jp409E	48.3	42.4	1.5
Jp409F	60.3	42.4	1.5

**CABEZAL SOPORTE LATERAL**
**Jp199**

CODIGO	MAT PERNO	$\varnothing$ mm
Jp199A	304	48.3
Jp199B	304	$\varnothing$ 38
Jp199C	ZINC	$\varnothing$ 38
Jp199D	304	$\varnothing$ 40
Jp199E	ZINC	$\varnothing$ 40

**CABEZAL DE APOYO CUADRADO**
**Jp198**

CODIGO	MAT PERNO	$\varnothing$ mm
Jp198A	304	48.3
Jp198B	304	$\varnothing$ 38
Jp198C	ZINC	$\varnothing$ 38
Jp198D	304	$\varnothing$ 40
Jp198E	ZINC	$\varnothing$ 40

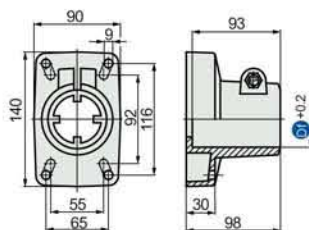
**CABEZAL DE APOYO RECTANGULAR**
**Jp280**

CODIGO	MAT PERNO	$\varnothing$ mm
Jp280A	304	48.3
Jp280B	304	60.3

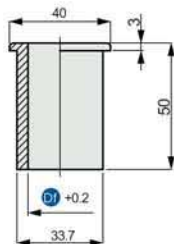
**ADAPTADOR**
**Jp420**

CODIGO	$\varnothing$ mm	Kg
Jp420	26.9	0.02



AMARRA DE PIE

Jp454

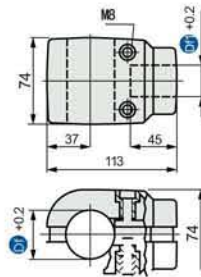

CODIGO	MAT PERNO	$\varnothing$ mm	$\varnothing$ mm
Jp454	304	42.4	33.7

AMARRA DE PIE

Jp137

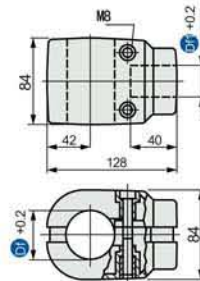

CODIGO	MAT PERNO	$\varnothing$ mm	$\varnothing$ mm
Jp137A	304	48.3	42.4
Jp137B		60.3	42.4

BASE TRIPODE

Jp615

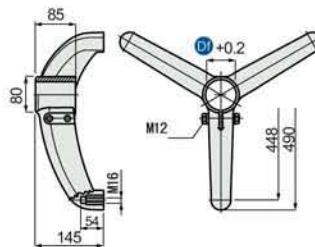

CODIGO	MAT PERNO	$\varnothing$ mm
Jp615A	304	38.1
Jp615B		42.4
Jp615C		48.3
Jp615D		50.8
Jp615E		60.3

BASE BIPODE CON SALIDA LATERAL

Jp616

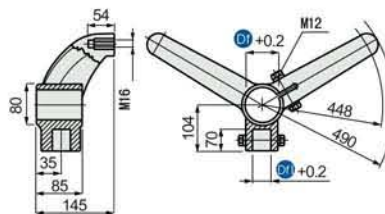

CODIGO	MAT PERNO	$\varnothing$ mm	$\varnothing$ mm
Jp616A	304	42.4	42.4
Jp616B		48.3	42.4
Jp616C		50.8	42.4
Jp616D		60.3	42.4

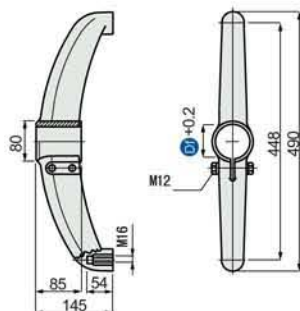
**BASE BIPODE**
**Jp618**

CODIGO	MAT PERNO	Ø mm
Jp618A	304	38.1
Jp618B		42.4
Jp618C		48.3
Jp618D		50.8
Jp618E		60.3

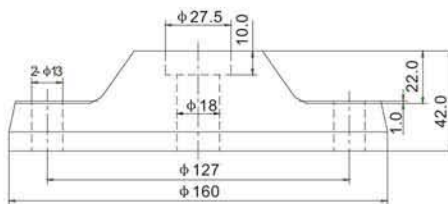
**BASE PIE D.160**
**Jp629**

CODIGO	MATERIAL	DIMENSION
Jp629	PA+POM	160x42

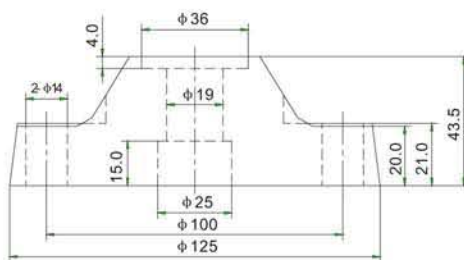
**BASE PIE D.125**
**Jp625**

CODIGO	MATERIAL	DIMENSION
Jp625	PA+POM	125x43

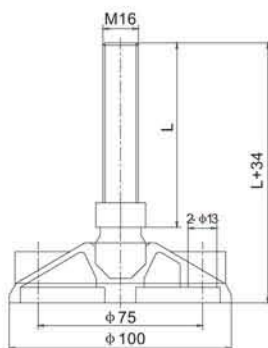
**PIE ARTICULADO D. 100 MM**
**Jp624**

CODIGO	L	MATERIAL	DIMENSION
Jp624	128	PA+POM	100 x34

**PIE ARTICULADO**

Jp626, Jp627, Jp628



CODIGO	D mm	HxL	MATERIAL
Jp626A	60	M16X80	PA+POM
Jp626B		M16X130	
Jp626C		M16X180	
Jp627A	70	M16X80	PA+POM
Jp627B		M16X130	
Jp627C		M16X180	
Jp628A	80	M16X80	PA+POM
Jp628B		M16X130	
Jp628C		M16X180	

**RODILLO DE RETORNO**

Jp561

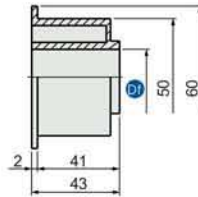
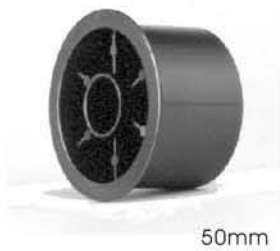

CODIGO	d. EJE mm	Ø mm
Jp561	15	15.5

**RODILLO DE RETORNO**

Jp560

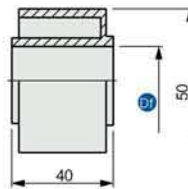

CODIGO	d. EJE mm	Ø mm
Jp560	15	15.5

**RODILLO DE RETORNO**

Jp73

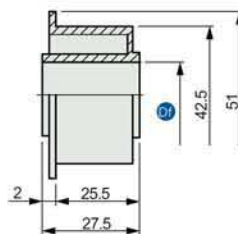

CODIGO	d. EJE mm	Ø mm
Jp73A	12	12.5
Jp73B	16	16.5
Jp73C	18	18.5
Jp73D	20	20.5

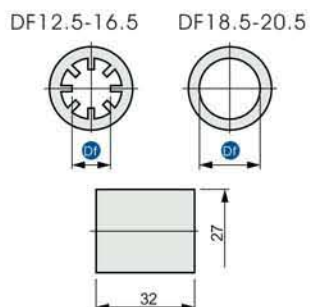
**RODILLO DE RETORNO**
**Jp126**

CODIGO	d. EJE mm	$\varnothing$ mm
Jp126A	12	12.5
Jp126B	16	16.5
Jp126C	18	18.5
Jp126D	20	20.5

**RODILLO DE RETORNO**
**Jp125**

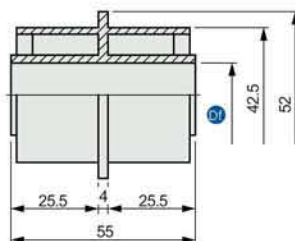

42.5mm



CODIGO	d. EJE mm	$\varnothing$ mm
Jp125A	12	12.5
Jp125B	16	16.5
Jp125C	18	18.5
Jp125D	20	20.5

**RODILLO DE RETORNO**
**Jp554**

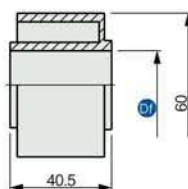

60mm



CODIGO	d. EJE mm	$\varnothing$ mm
Jp554A	12	12.5
Jp554B	16	16.5
Jp554C	18	18.5
Jp554D	20	20.5

**DISCO RODILLO DE RETORNO**
**Jp555**

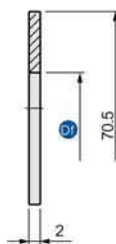

JP554-JP613



CODIGO	d. EJE mm	$\varnothing$ mm
Jp555A	12	12.5
Jp555B	16	16.5
Jp555C	18	18.5
Jp555D	20	20.5

**RODILLO DE RETORNO**
**Jp421**

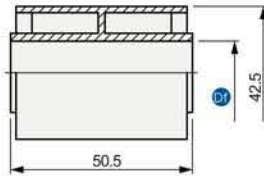

42.5mm



CODIGO	d. EJE mm	Ø <sub>h</sub> mm
Jp421A	12	12.5
Jp421B	16	16.5
Jp421C	18	18.5
Jp421D	20	20.5

**RODILLO DE RETORNO**
**Jp388**

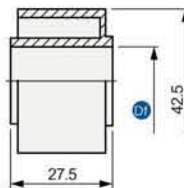

42.5mm



CODIGO	d. EJE mm	Ø <sub>h</sub> mm
Jp421A	12	12.5
Jp421B	16	16.5
Jp421C	18	18.5
Jp421D	20	20.5

**RODILLO DE RETORNO**
**Jp556**

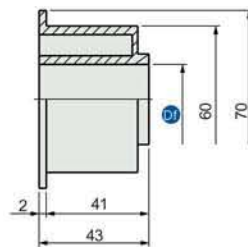
50mm

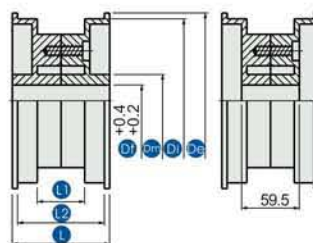

CODIGO	d. EJE mm	Ø <sub>h</sub> mm
Jp556A	12	12.5
Jp556B	16	16.5
Jp556C	18	18.5
Jp556D	20	20.5

**RUEDA DE RETORNO**
**Jp67, Jp22, Jp74**

CODIGO	MAT PERNO	Ø <sub>h</sub> mm	Ø <sub>h</sub> mm	Ø <sub>h</sub> mm	L <sub>1</sub> mm	L <sub>2</sub> mm	L <sub>3</sub> mm	Ø <sub>h</sub> mm
Jp67A	304	167	156	41	50	84.5	87.5	30
Jp67B		167	156	41	50	84.5	87.5	40
Jp22A		200	191	53	45	85.5	87.5	30
Jp22B		200	191	53	45	85.5	87.5	40
Jp74A		200	191	53	62	102.5	105.5	30
Jp74B		200	191	53	62	102.5	105.5	40

RUEDA DE RETORNO

Jp22M

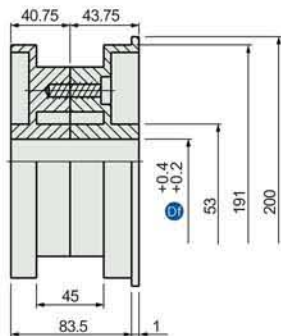

CONTROL DE CONTACTO

Jp518

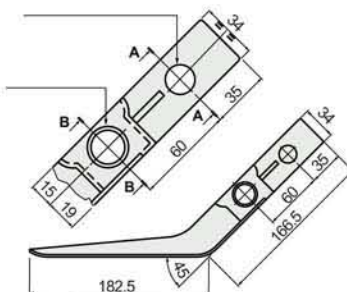

PATIN DE RETORNO

Jp150

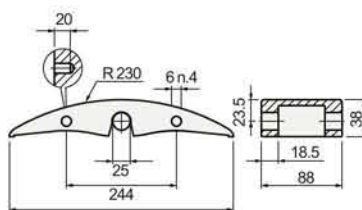

ABRAZADERA

Jp371

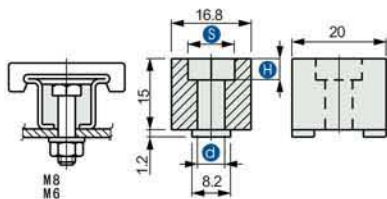

CONECTOR

Jp372

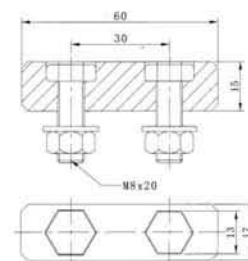

PATIN DE DESLIZAMIENTO

Jp551

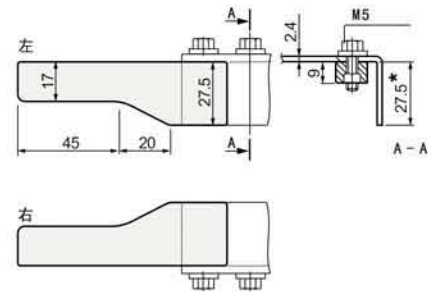
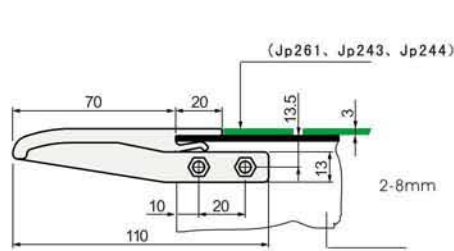

PATIN DE DESLIZAMIENTO

Jp550

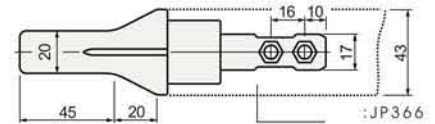
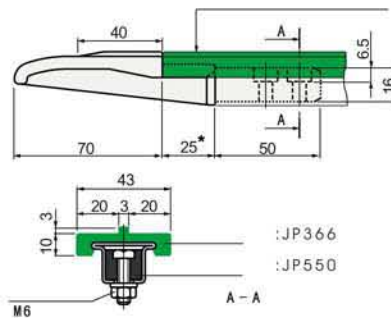

MORDAZA CONICA

Jp275

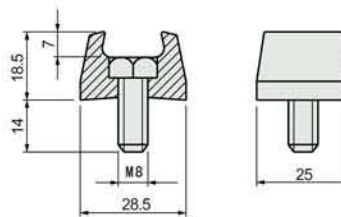

PLACA DE TRANSFERENCIA

Jp567

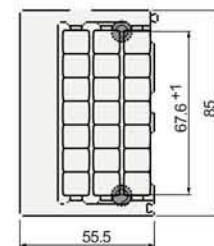
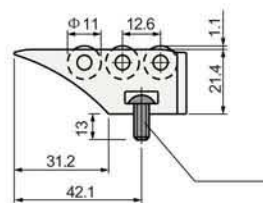

TRANSFERENCIA

Jp568

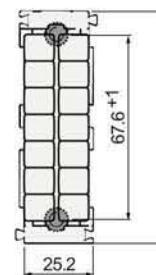
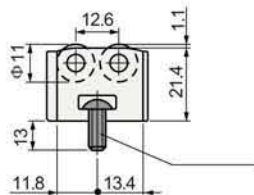

TRANSFERENCIA

Jp569

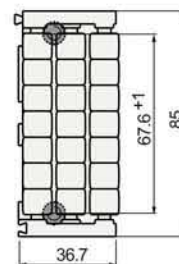
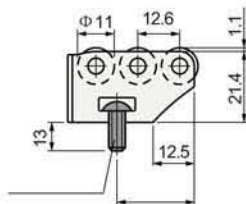

GUIA DE ACUMULACION

Jp628s

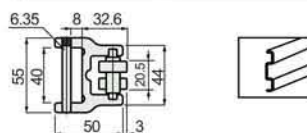
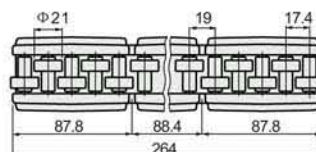

GUIA DE ACUMULACION

Jp557

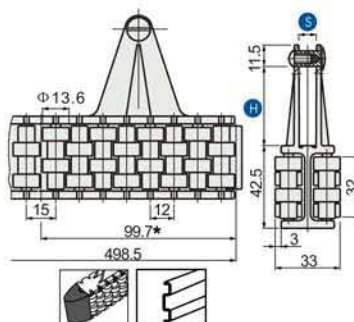
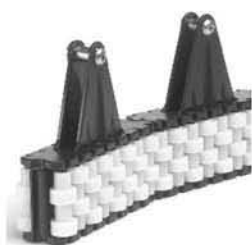

CODIGO	H mm	S mm	Kg/m
Jp557A	30	6	1.22
Jp557B	40	8	1.22



GUIA DE ACUMULACION

Jp581

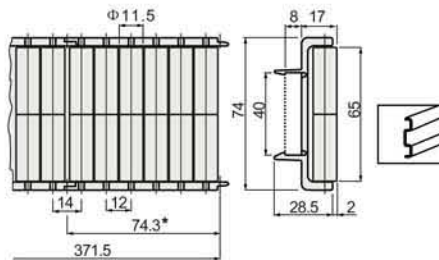

GUIA DE ACUMULACION

Jp554

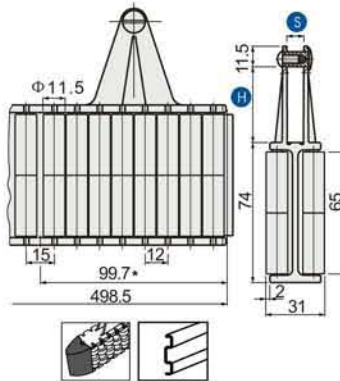

CODIGO	H mm	S mm	Kg/m
Jp557A	30	6	1.22
Jp557B	40	8	1.22

GUIA DE ACUMULACION

Jp580

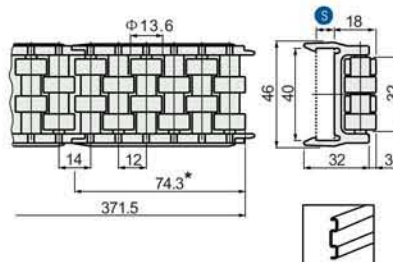

CODIGO	S mm	Kg/m
Jp580A	8	0.61
Jp580B	10	0.61

GUIA DE ACUMULACION

Jp580p

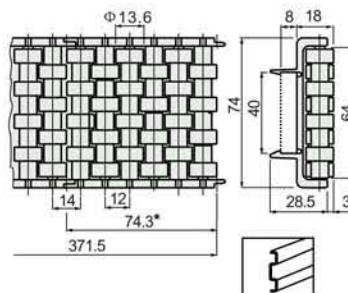
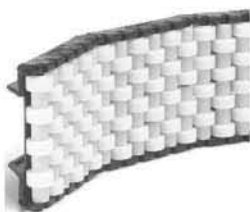

GUIA DE ACUMULACION

Jp582

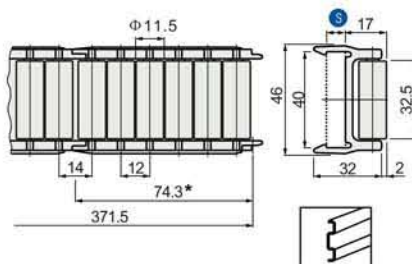

CODIGO	$\Phi$ mm	Kg/m
Jp582	8	0.62

GUIA DE ACUMULACION

Jp585

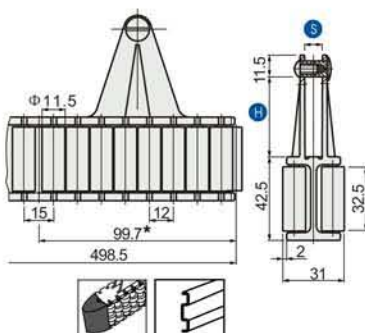

CODIGO	$\Phi$ mm	$\Phi$ mm	Kg/m
Jp585A	30	6	1.24
Jp585B	40	8	1.24

GUIA DE ACUMULACION

Jp128

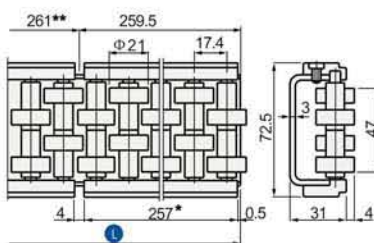

CODIGO	MATERIAL	$\Phi$ mm	Kg/m
Jp128A	304	1041	3.8
Jp128B		2085	3.8
Jp128C		3129	3.8
Jp128D		1041	3.8
Jp128E		2085	3.8
Jp128F		3129	3.8

GUIA DE ACUMULACION

Jp129

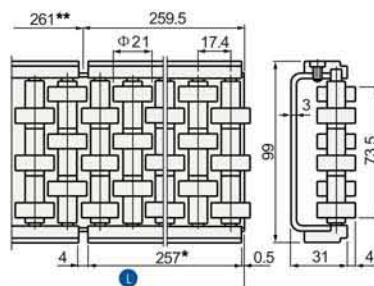

CODIGO	MATERIAL	$\Phi$ mm	Kg/m
Jp129A	304	1041	5.0
Jp129B		2085	5.0
Jp129C		3129	5.0
Jp129D		1041	5.0
Jp129E		2085	5.0
Jp129F		3129	5.0

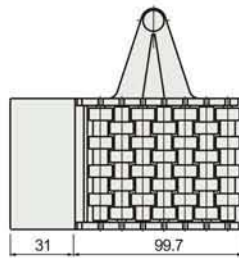
**CABEZA DE GUIA DE ACUMULACION**
**Jp805、 Jp806**

CODIGO	DIMENSION	PARA GUIA DE ACUMULACION	Kg/m
Jp805A	30X6	JP557	0.24
Jp805B	40X8		0.24
Jp806A	30X6	JP807	0.26
Jp806B	40X8		0.26

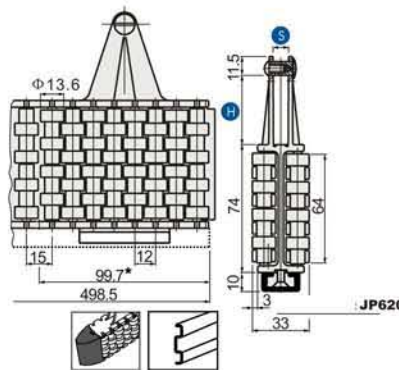
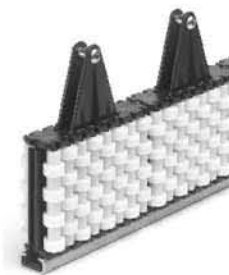
**GUIA DE ACUMULACION**
**Jp807**

CODIGO	H mm	S mm	Kg/m
Jp807A	30	6	2.4
Jp807B	40	8	2.4

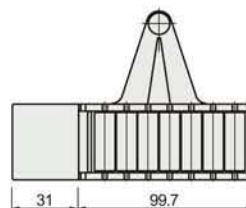
**CABEZA DE GUIA DE ACUMULACION**
**Jp586**

CODIGO	DIMENSION	Kg/m
Jp586A	30X6	0.15
Jp586B	40X8	0.15

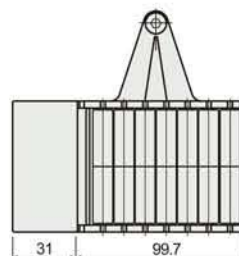
**CABEZA DE GUIA DE ACUMULACION**
**Jp587、 Jp808**

CODIGO	DIMENSION	PARA GUIA DE ACUMULACION	Kg/m
Jp587A	30X6	JP585	0.24
Jp587B	40X8		0.24
Jp808A	30X6	JP597	0.26
Jp808B	40X8		0.26

GUIA DE ACUMULACION

Jp597

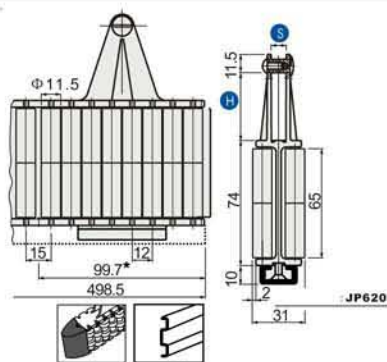

CODIGO	H mm	S mm	Kg/m
Jp597A	30	6	2.5
Jp597B	40	8	2.5

CABEZA DE GUIA DE ACUMULACION

Jp570

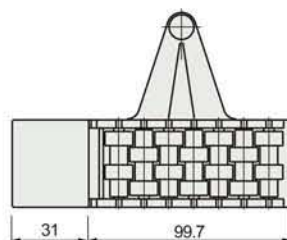

CODIGO	DIMENSION	Kg/m
Jp570A	30X6	0.15
Jp570B	40X8	0.15

GUIA DE ACUMULACION

Jp128S

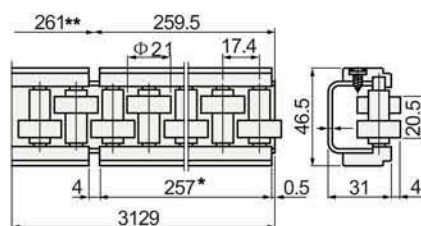

CODIGO	MAT	Kg/m
Jp128S1	304	2.06
Jp128S2	ZINC	2.06

GUIA DE ACUMULACION

Jp128AS

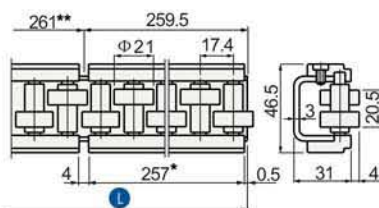

CODIGO	MAT	L mm	Kg/m
Jp128AS1	304	1041	2.6
Jp128AS2		2085	2.6
Jp128AS3		3129	2.6
Jp128AS4		1041	2.6
Jp128AS5		2085	2.6
Jp128AS6		3129	2.6

**ACCESORIOS PARA LLENADORAS**

Jp611

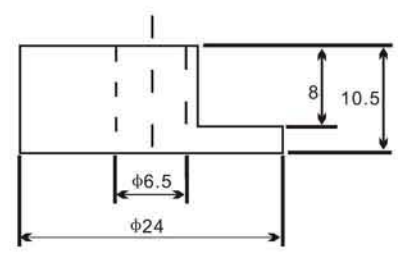

**ANILLOS DE FIJACION**

Jp612

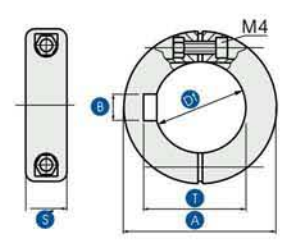

CODIGO	Øj mm	A mm	T mm	B mm	S mm	Kg
Jp612A	18	38			14	0.018
Jp612B	20	40			14	0.019
Jp612C	25	45			14	0.022
Jp612D	30	50	33.3	8	16	0.026
Jp612E	35	56	38.3	10	16	0.030

Jp613A

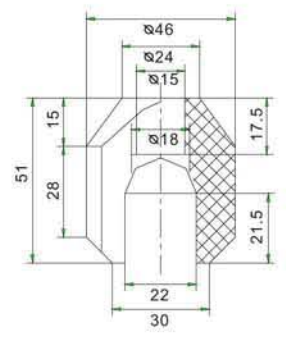

Jp613B

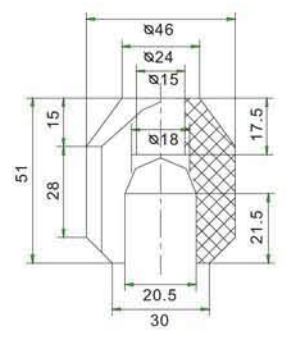

**ACCESORIOS PARA LLENADORAS**

Jp613C

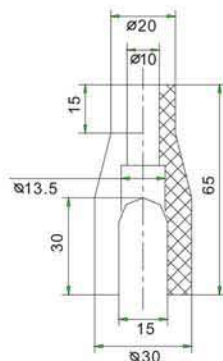

Jp613D

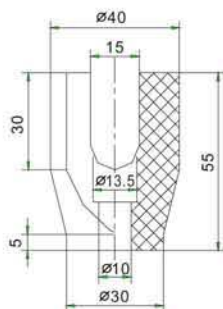

Jp613E

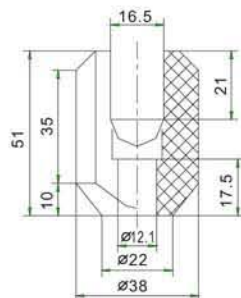

Jp630

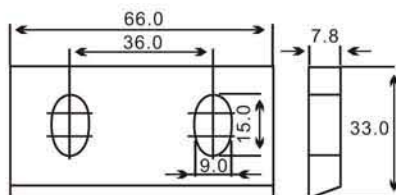

Jp631

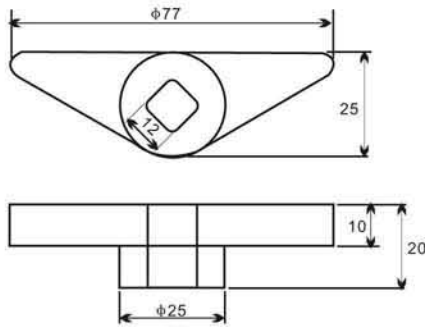

Jp632

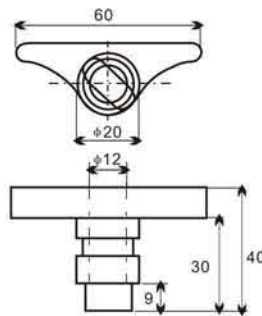

CERRADURA SIMPLE

Jp633

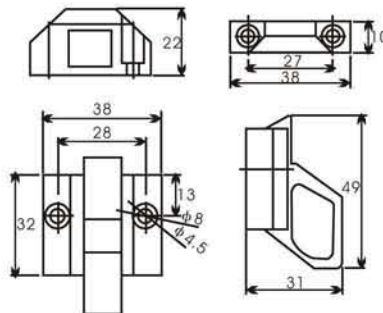

Jp619

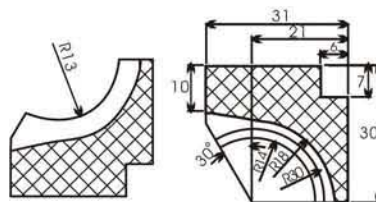

**ACCESORIOS PARA LLENADORAS**

Jp620

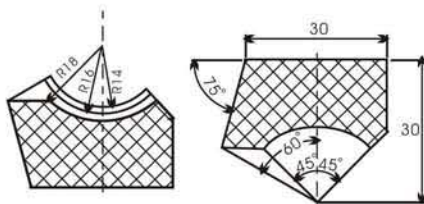

6001E

Jp215

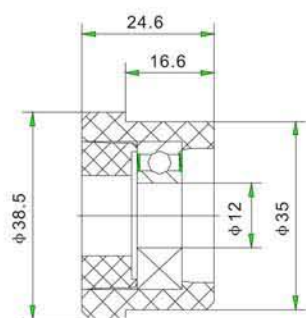

6202E

Jp217

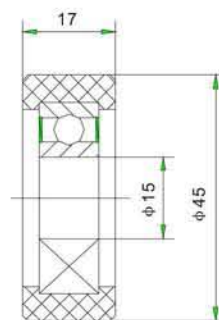

Jp228

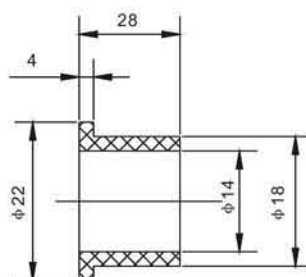

Jp602

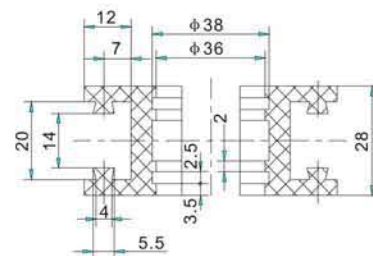
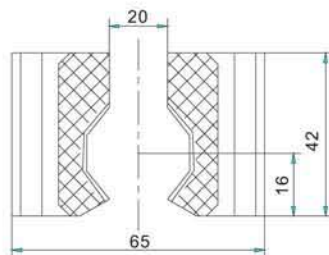



ACCESORIOS PARA LLENADORAS

Jp603

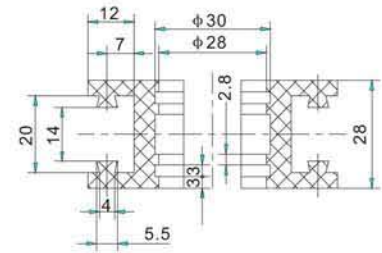
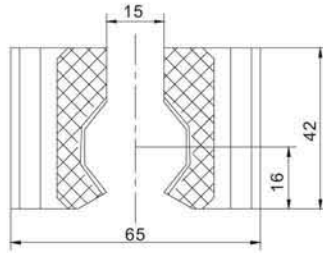

Jp604

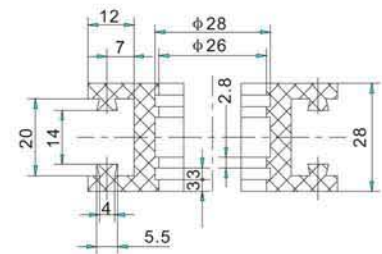
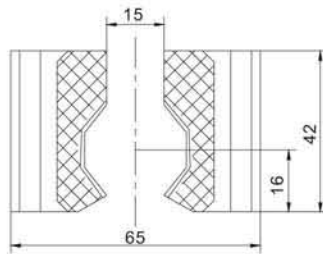

Jp605

:PA+PTFE

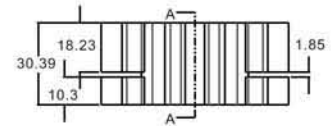
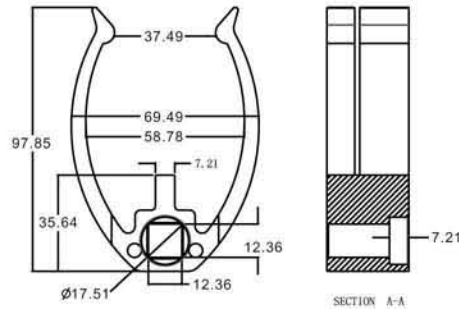

25

Jp606

:PA+PTFE

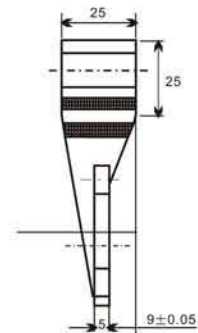
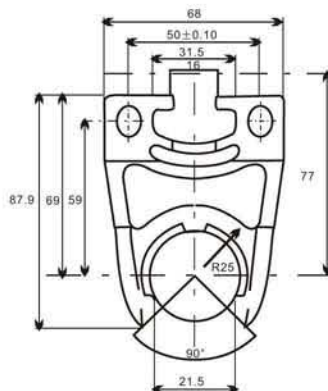

**ACCESORIOS PARA LLENADORAS**

26

Jp607

:PA+PTFE

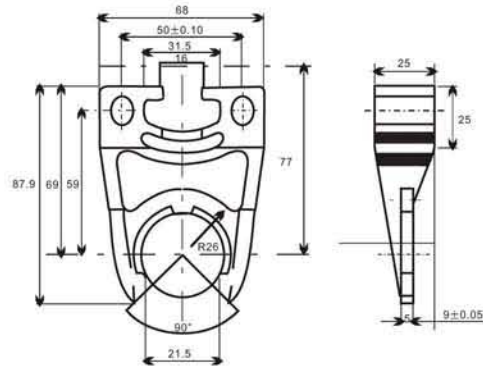

35

Jp608

:PA+PTFE

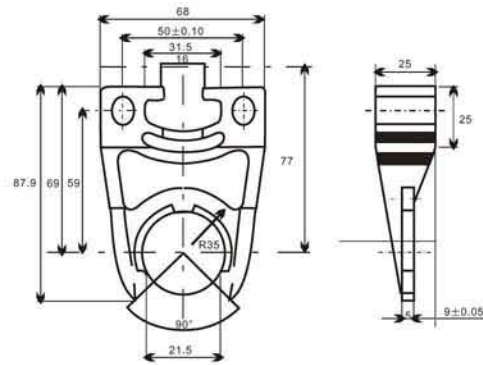

Jp218

Jp219

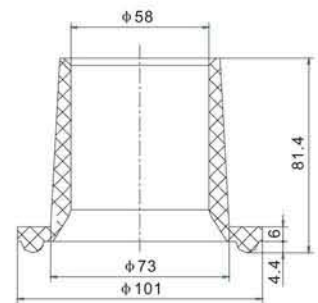
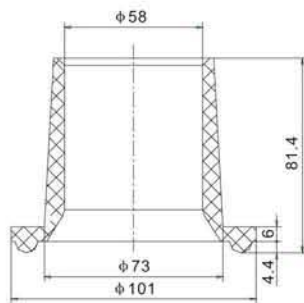

PORTA-ESPEJO

Jp220

PORTA-ESPEJO

Jp221

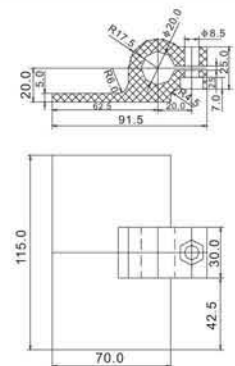
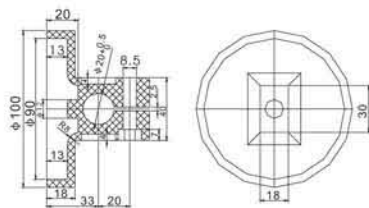

BISAGRA

180°

Jp571, Jp572, Jp573

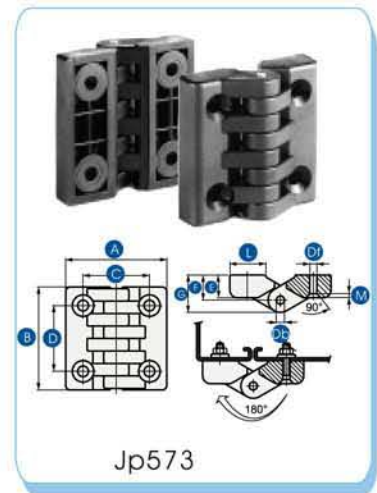
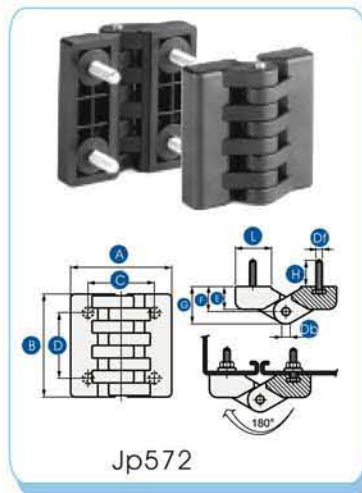
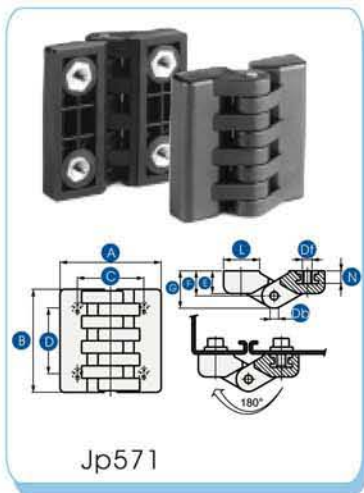

CODIGO	ANGULO	PERNO	A	B	C	D	E	F	G	H	L	M	N	dc
			mm	mm	mm	mm	mm	mm	mm	mm	mm	mm	mm	mm
Jp571	180°	M5	48	49	31	30.2	11	13	19	14	17	2.3	7.5	4
Jp572		M6	64	65	40	40.2	13.7	15	23	17.5	24	3.3	10	5
Jp573		M10	97	97	62.8	60	20.6	23	35	20	35	5.5	15	8

BISAGRA

180°

Jp337

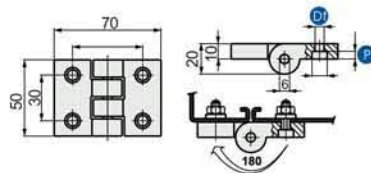

CODIGO	ANGULO	PERNO	Øf	Øc	P
			mm	mm	mm
Jp337A	180°	M6	6.5	10.5	6
Jp337B		M8	8.5	13.5	4

BISAGRA

170°

Jp260

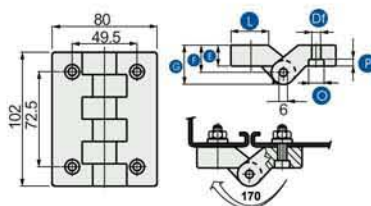

CODIGO	ANGULO	PERNO	E	F	G	Ø	P	L	Øf
			mm	mm	mm	mm	mm	mm	mm
Jp260A	170°	M6	11.5	11.5	23.5	10.5	6	35	6.5
Jp260B		M8	11.5	11.5	23.5	13.5	8	35	8.5
Jp260C		M6	18	18	30	10.5	6	22	6.5
Jp260D		M8	18	18	30	13.5	8	22	8.5

BISAGRA

270°

Jp576

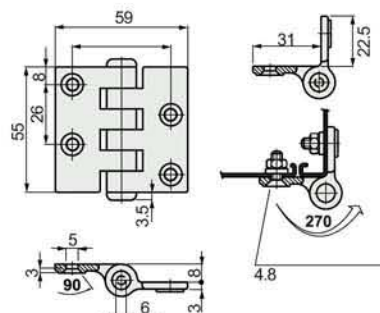

BISAGRA

195°

Jp575

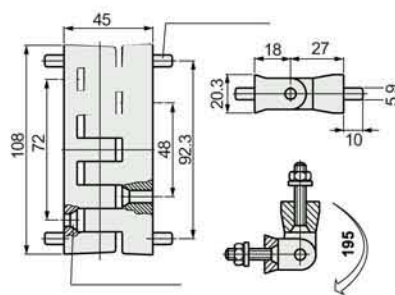

MANILLA GRANDE

Jp621

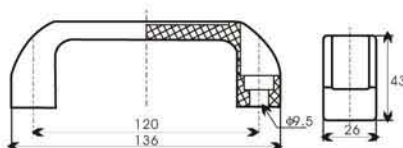

MANILLA PEQUEÑA

Jp622

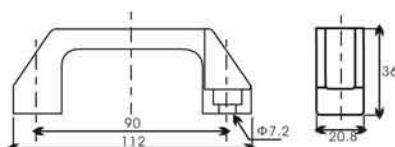

TOPE

Jp623

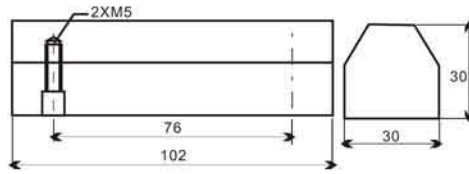

A

Jp230

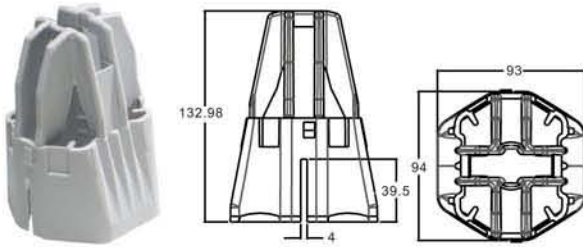

B

Jp231

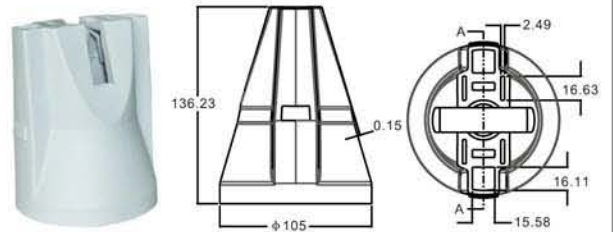

C

Jp232

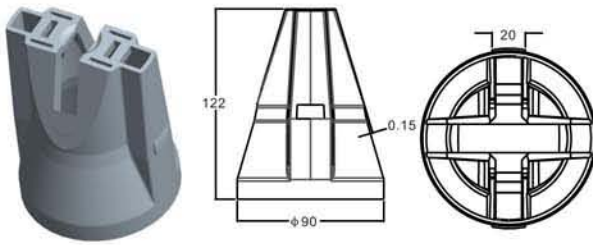

D

Jp233

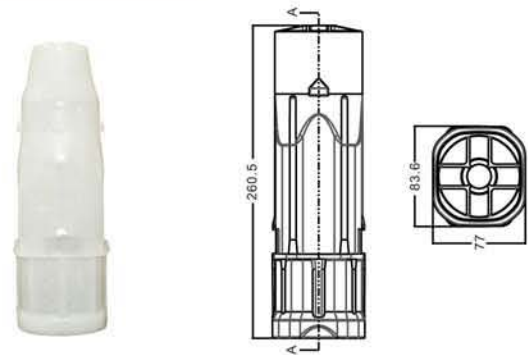

Jp222



Jp223

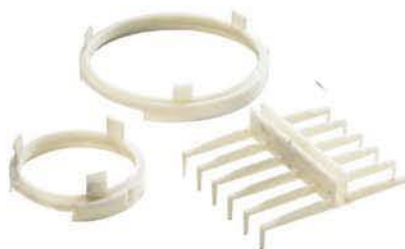

Jp224



BOQUILLAS PARA LLENADORAS

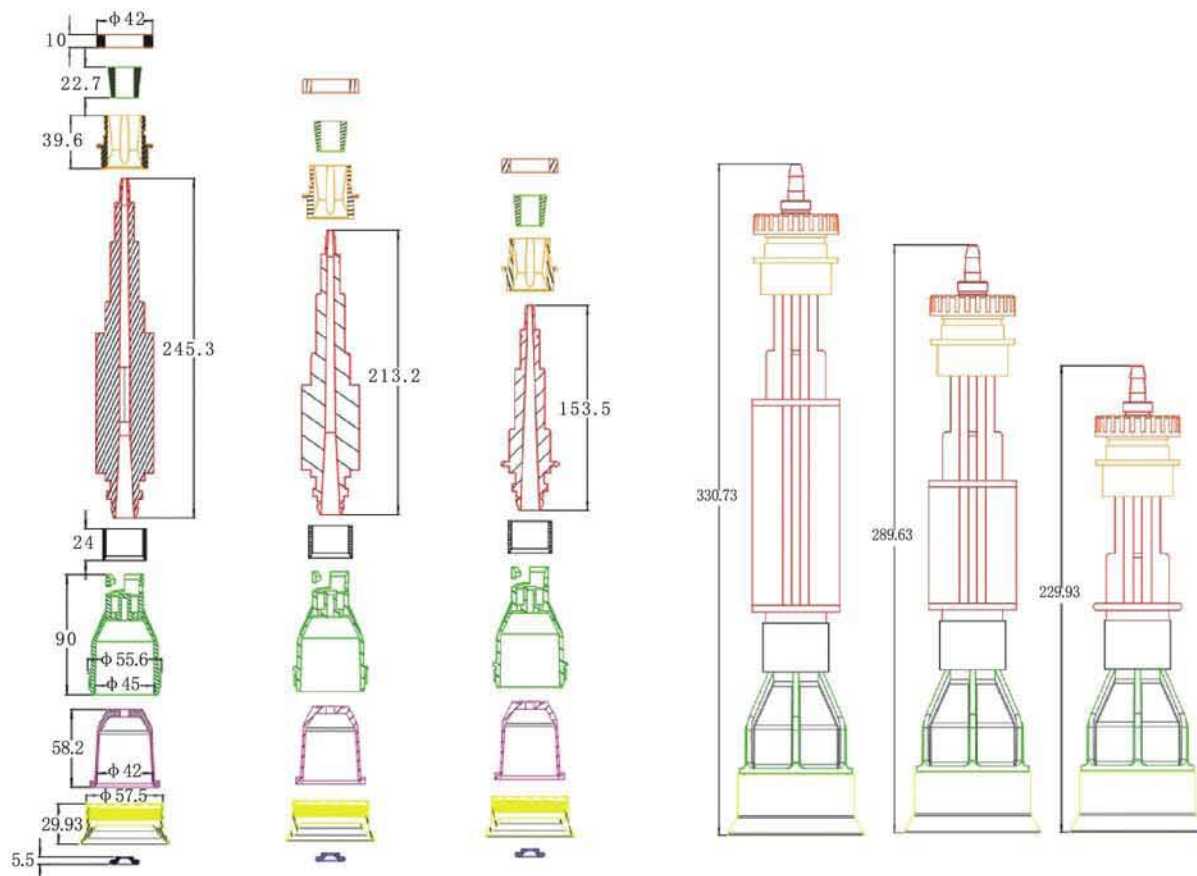
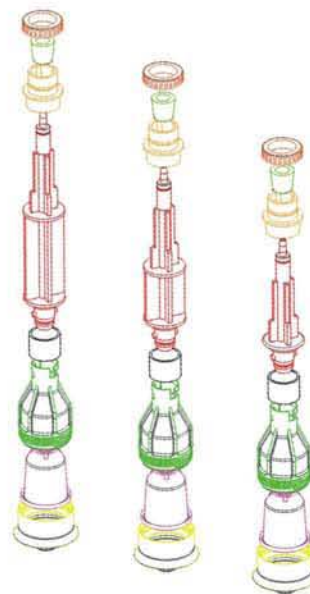

### BOQUILLAS PARA LLENADORAS

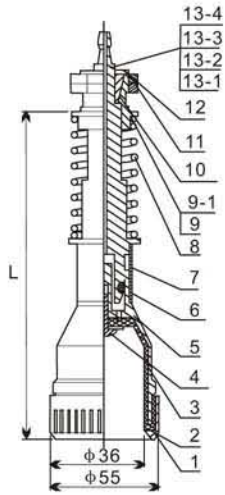

(L)
190
252
290
300

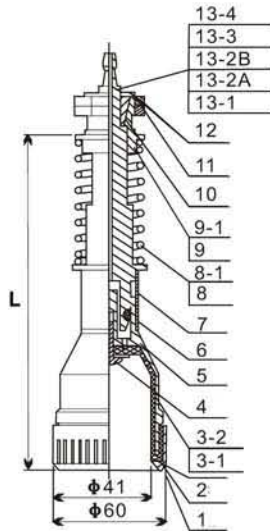

(L)
185
247
247
285
300

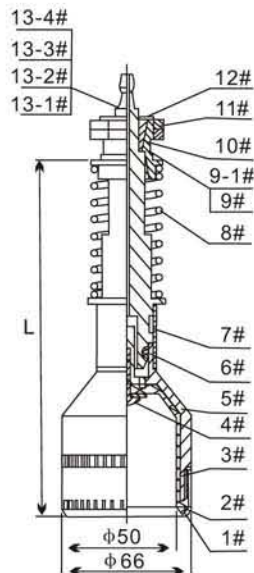

(L)
185
250
285
300



## SOPORTES DE RODAMIENTO

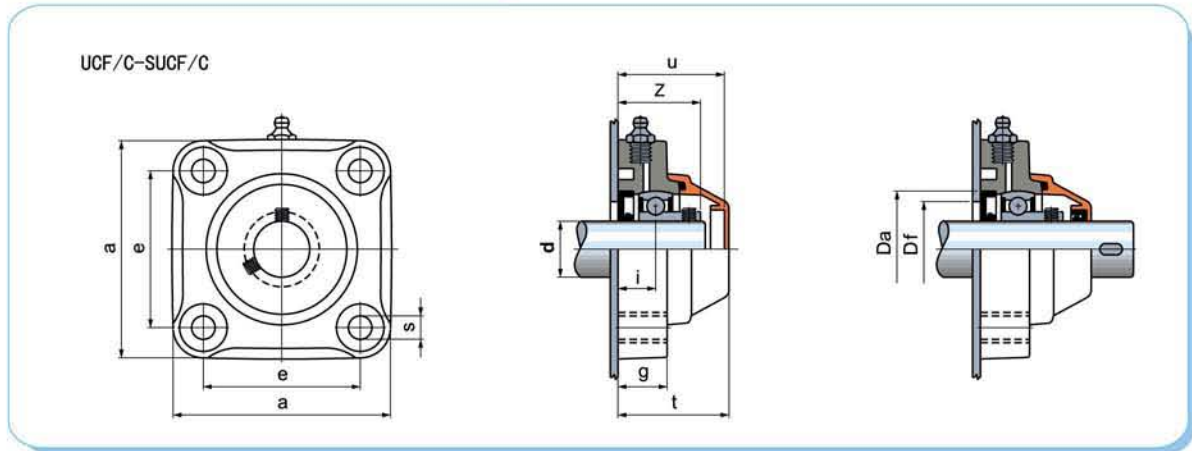

d mm		e	a	s	g	i	z	u	t	Da	Df	Kg	
<b>PA Fv</b>													
25	UCF 205 C	70	98	11	22,5	16,8	36,3	47,5	49,5	52	50	45	YAT 205 2 0,40
30	UCF 206 C	83	110	11	26	20	41	53	55	62	60	50	YAT 206 2 0,56
35	UCF 207 C	92	120	11	26	19,5	45	57	59	72	70	55	YAT 207 2 0,72
40	UCF 208 C	102	131	11	30	22	47,3	62,5	65,5	80	78	65	YAT 208 2 0,95
40*	SUCF 208 C	83	110	11	26	19	48	64	66	80	78	65	YAT 208 2 0,88
<b>PP Fv</b>													
25	UCF 205 C	70	98	11	22,5	16,8	36,3	47,5	49,5	52	50	45	YAT 205 2 0,40
30	UCF 206 C	83	110	11	26	20	41	53	55	62	60	50	YAT 206 2 0,56
35	UCF 207 C	92	120	11	26	19,5	45	57	59	72	70	55	YAT 207 2 0,72
40	UCF 208 C	102	131	11	30	22	47,3	62,5	65,5	80	78	65	YAT 208 2 0,95
40*	SUCF 208 C	83	110	11	26	19	48	64	66	80	78	65	YAT 208 2 0,88

d mm					Fr <sub>+</sub>		Fr <sub>+</sub>					
					PAFV	PPFV	PAFV	PPFV	PAFV	PPFV	PAFV	PPFV
25	UCF 205 C	10800	7800	2160	17000	12000	18000	10000				
30	UCF 206 C	15000	11200	3000	17000	12000	18000	10000				
35	UCF 207 C	19600	15300	3920	18000	12000	22000	12000	- 20 a + 90	- 20 a + 70	80	100
40	UCF 208 C	23600	19000	4720	18000	12500	22000	12000				
40	SUCF 208 C	23600	19000	4720	17000	12000	18000	10000				





## MANTENCION DE SOPORTES DE RODAMIENTO

1



2



3



4



5



6



7



mm	mm		Nm	
20	3	3	4	4
25	3	3	4	4
30	3	4	4	6,5
35	3	5	4,5	16,5
40	4	5	6,5	16,5

REPUESTOS PARA SOPORTES DE RODAMIENTOS

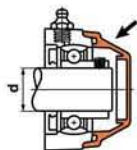

TAPA CIEGA



(mm)					
20	25	30	35	40	40*
69286	65443	63242	63589	69296	629391
			63232		

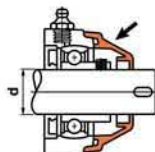

TAPA ABIERTA



(mm)					
20	25	30	35	40	40*
646151	646161	646171	646181	646201	646211
			646191		

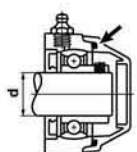
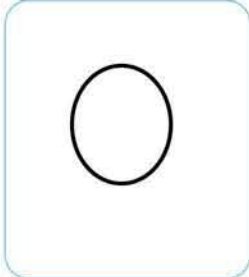

O'RING



(mm)					
20	25	30	35	40	40*
66139	63059	69977	661981	66159	66159
66149	66119	66129	661991	66169	66169

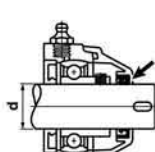

RETEN TAPA



(mm)					
20	25	30	35	40	40*
66199	63069	600942	641071	66219	66219
66209	66179	600972	641081	66229	66229

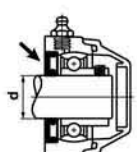

RETEN SOPORTE

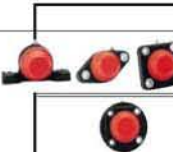

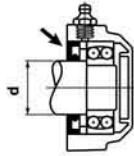

(mm)					
20	25	30	35	40	40*
204	205	206	207	208	S208
632151	608941	68416	641111	632141	603622
641091	641101	643561	641121	641131	603632

## REPUESTOS PARA SOPORTES DE RODAMIENTOS

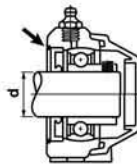

		(mm)					
		25	30	35	40	45	45*
		1204	1205	1206	1207	1208	S 1208
<b>RETEN SOPORTE</b> 	<b>SIMPLE LABIO</b>	603642	603662	603682	603702	603722	603742
	<b>DOBLE LABIO</b>	603652	603672	603692	603712	603732	603752



		(mm)				
		20	25	30	35	40
<b>ANILLO RETEN</b> 	<b>AISI304</b>	600982	646281	646291	646301	601052
	<b>AISI316</b>	603812	603822	603832	603842	603852

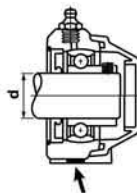
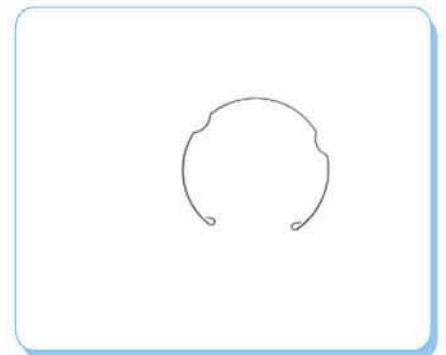

		(mm)				
		20	25	30	35	40
<b>BASE SOPORTE</b> 	<b>PVC</b>	692391	646251	646261	646271	692401



GUIAS DE DESLIZAMIENTO

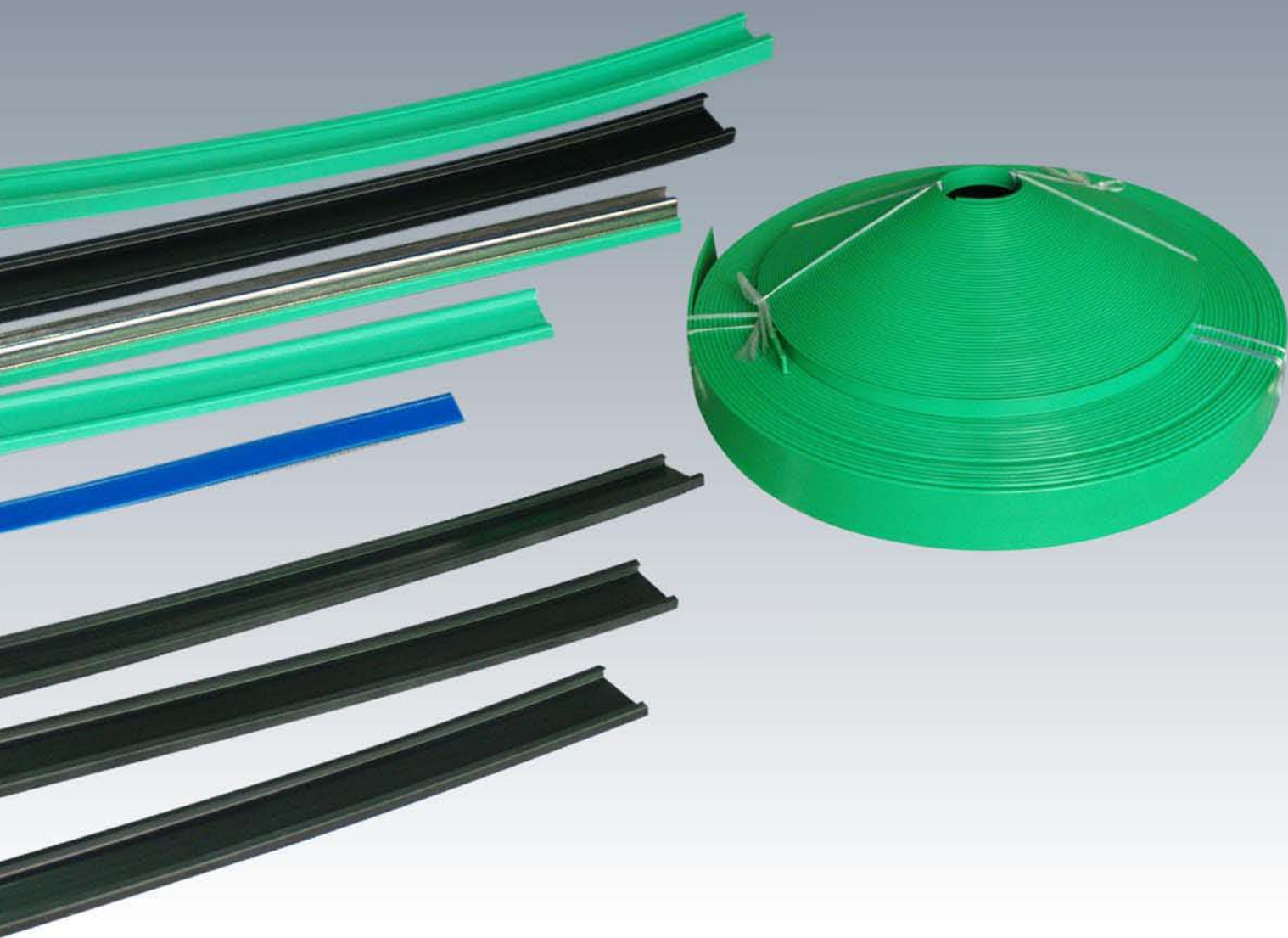

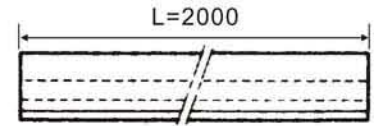
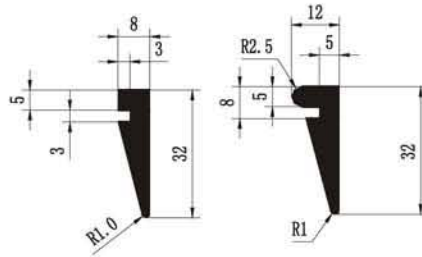
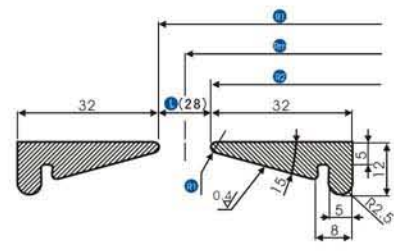
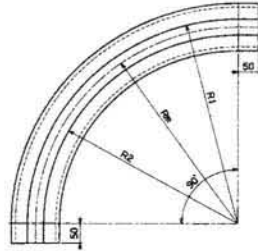
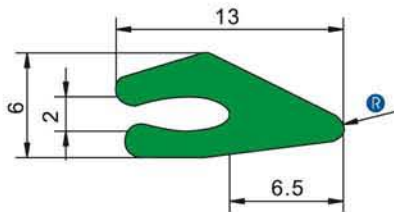
**GUIA RECTA PARA BOTELLAS PET**
**Jdp01**

**GUIA CURVA PARA BOTELLAS PET**
**Jdp02**

**GUIA CURVA PARA BOTELLAS PET**
**Jd91**

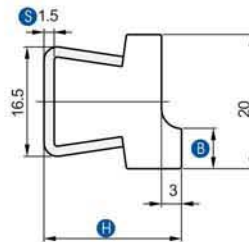
CODIGO	$\phi$ <sub>1</sub> mm	$\phi$ <sub>2</sub> mm	$\phi$ <sub>3</sub> mm	L mm
Jd91a	500	514	486	28
Jd91b	750	764	736	28
Jd91c	1000	1014	986	28

90°

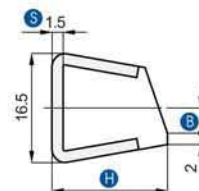
**GUIA LATERAL**
**Jd596**

CODIGO	MAT BASE CONICA	S mm	H mm	B mm	m	kg/m
Jd596	304/201	1.5	20.5	6	3	0.65

**GUIA LATERAL**
**Jd393**

CODIGO	MAT BASE CONICA	S mm	H mm	B mm	m	kg/m
Jd393	304/201	1.5	15	3.9	3	0.50
		1.5	17	3.6		

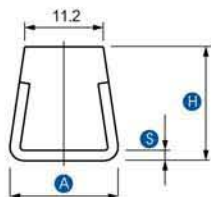
**GUIA DE DESLIZAMIENTO**
**Jd223**

CODIGO	MAT BASE	S mm	H mm	A mm	m	kg/m
Jd223	304/201	1.5	17.5	16.5	3	0.54
	304/201	2	18	17	3	0.54

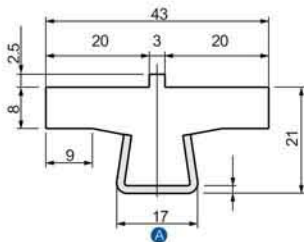
**GUIA DE DESLIZAMIENTO**
**Jd310**

CODIGO	MAT BASE	S mm	H mm	A mm	m	kg/m
Jd310	304	2		17	3	

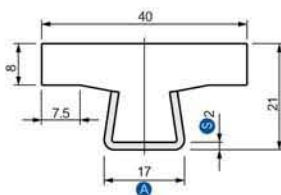
**GUIA DE DESLIZAMIENTO**
**Jd356**

CODIGO	MAT BASE	S mm	H mm	A mm	m	kg/m
Jd356	304	2	21	17	3	

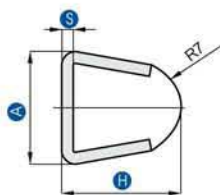
**GUIA DE DESLIZAMIENTO**
**Jd219**

CODIGO	MAT BASE	S mm	H mm	A mm	m	kg/m
Jd219	304/201	1.5	17.5	16.5	3	0.54
	304/201	2	18	17	3	0.54

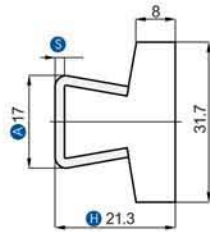
**GUIA DE DESLIZAMIENTO**
**Jd273**

CODIGO	MAT BASE	S mm	H mm	A mm	m	kg/m
Jd273	304	2	21.3	17	3	0.76

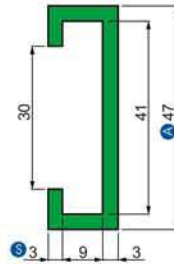
**GUIA DE DESLIZAMIENTO C**
**Jd539**

CODIGO	S mm	H mm	A mm	m	kg/m
Jd539	2	15	47	3/6	0.23

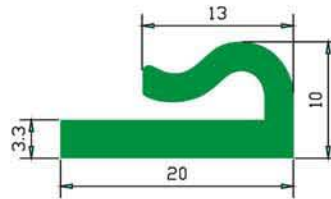
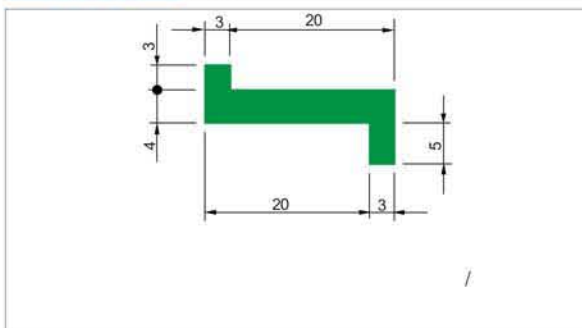
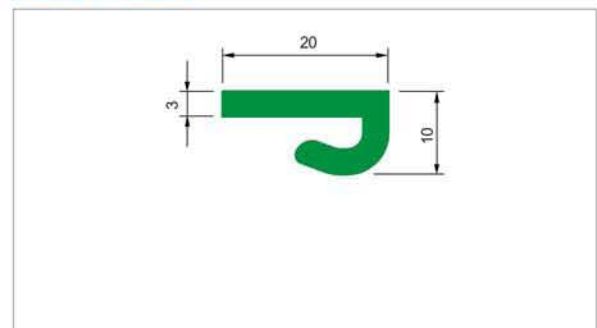
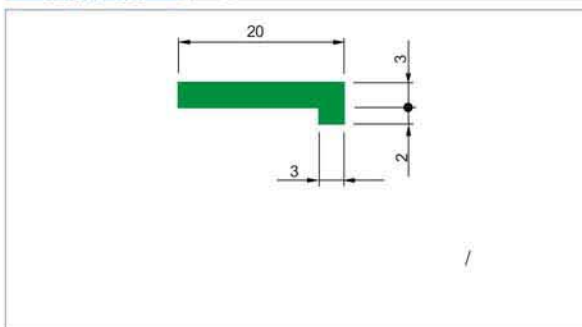
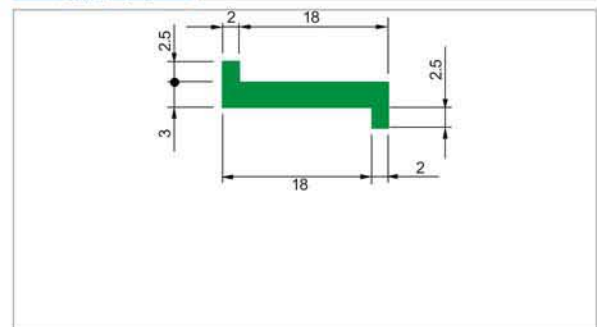
**GUIA DE DESLIZAMIENTO J**
**Jd540**

**Jd262 Z**

**Jd261 J**

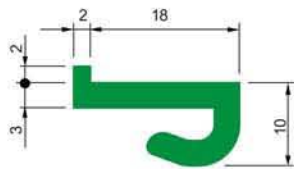
**Jd243 L**

**Jd241 Z**

**GUIAS DE DESLIZAMIENTO**

**Jd251 JZ**



2.5mm-4mm

**Jd242**

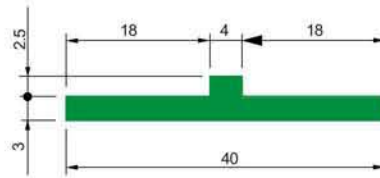

**Jd263**

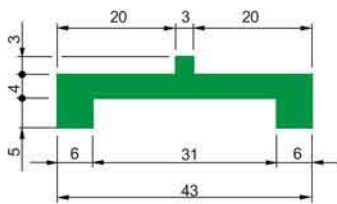

**Jd386 L**

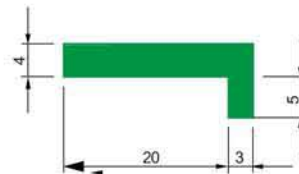

**Jd362 C**

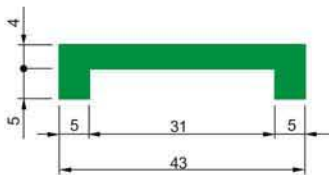

**Jd244**

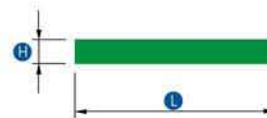

CODIGO	L X H mm	LARGO MT
Jd244	20X3	60
	20X5	20/80
	25X3	60
	30X3	60
	40X3	60
	40X5	50

**Jd387 C**

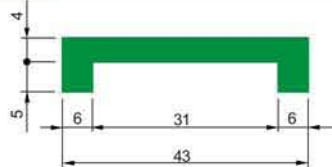



GUIAS DE DESLIZAMIENTO

Jd001

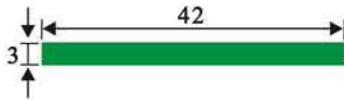

Jd002

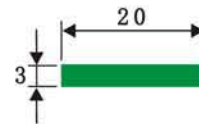

Jd003



Jd004

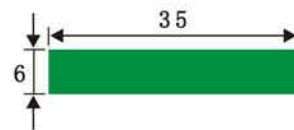

Jd005

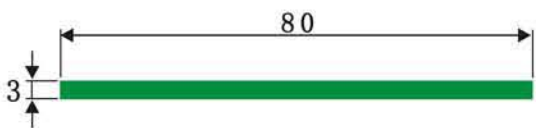

Jd006

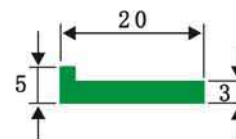

Jd007

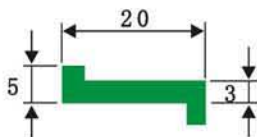

Jd008

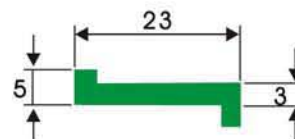

Jd009

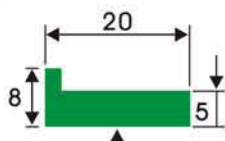

**GUIAS DE DESLIZAMIENTO**

Jd010

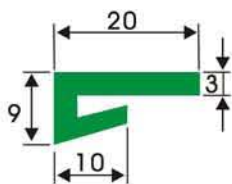

Jd011

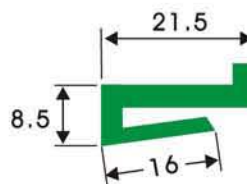

Jd012

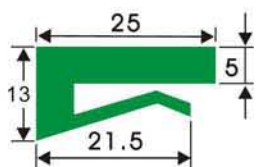

Jd013

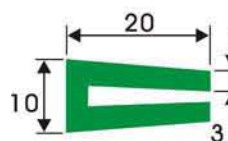

Jd014

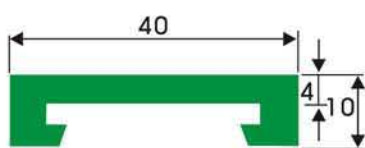

Jd015

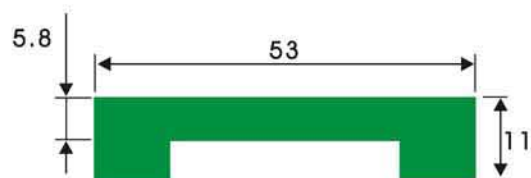

Jd016

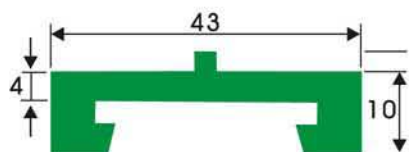

Jd017

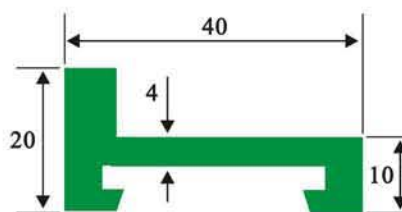

**GUIAS DE DESLIZAMIENTO**

Jd018

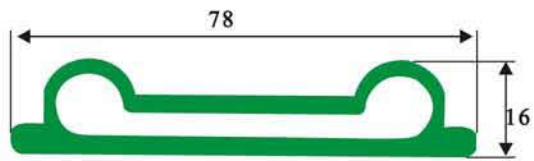

Jd019

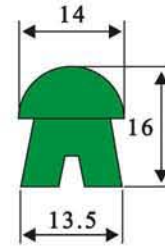

Jd020

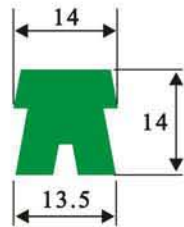

Jd021



Jd022

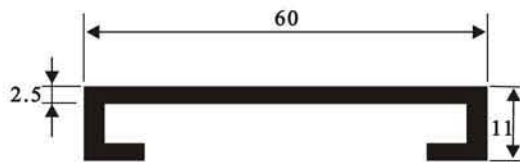

Jd023

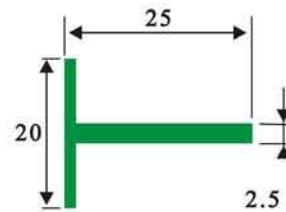

Jd024

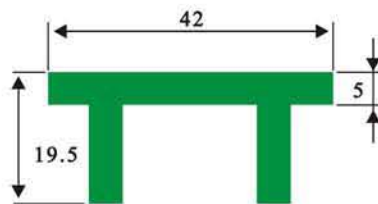

Jd025

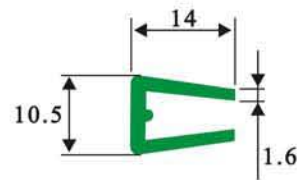

GUIAS DE DESLIZAMIENTO

Jd026

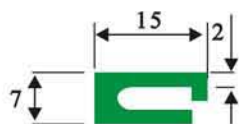

Jd027

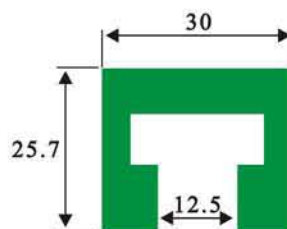

Jd028

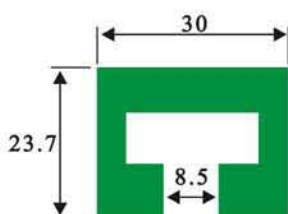

Jd029

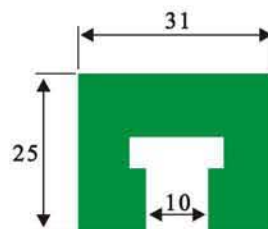

Jd030

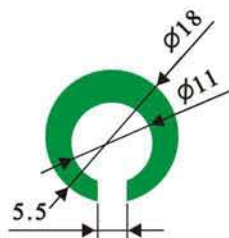

Jd031

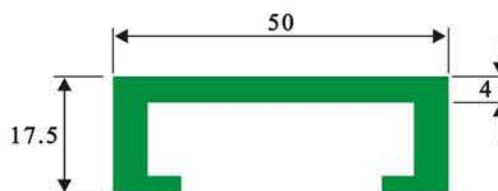

Jd032

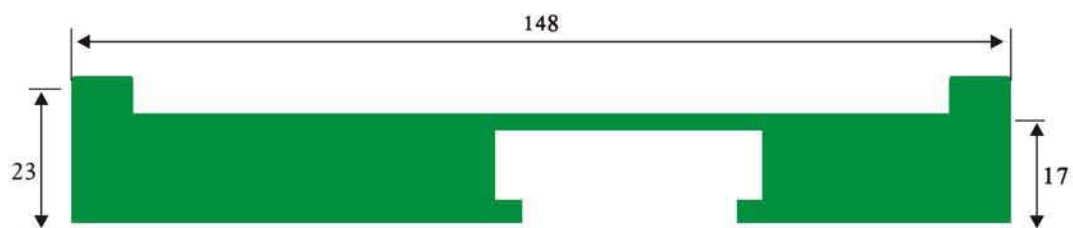

GUIAS DE DESLIZAMIENTO

Jd033

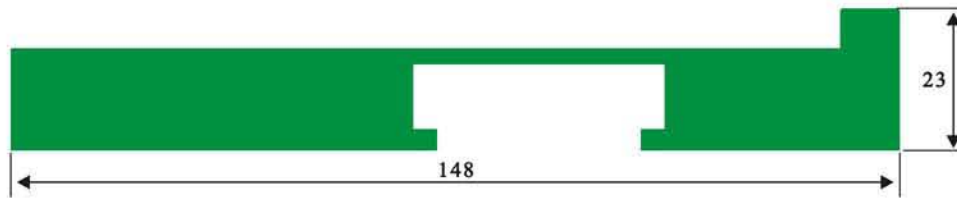

Jd034

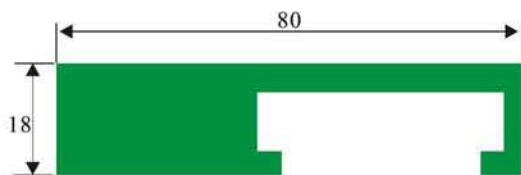

Jd035

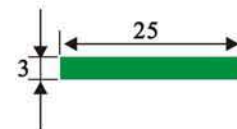

Jd036

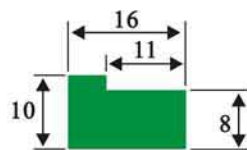

Jd039

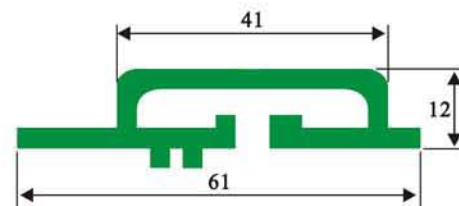

Jd040

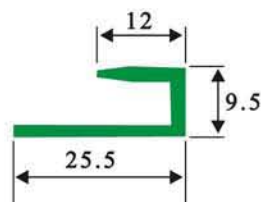

Jd041

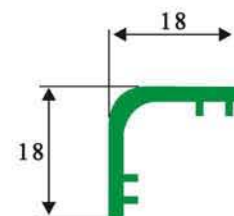

GUIAS DE DESLIZAMIENTO

Jd042

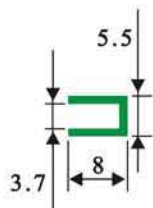

Jd043

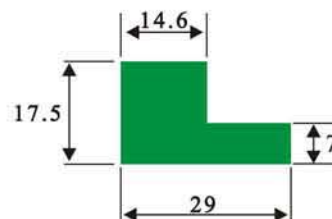

Jd044

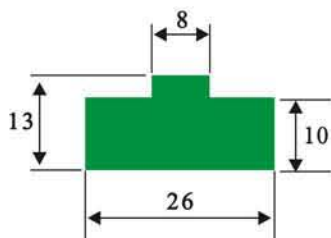

Jd045

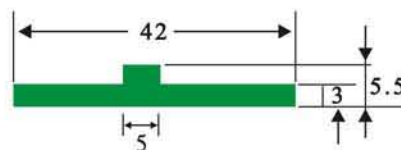

Jd049



Jd050

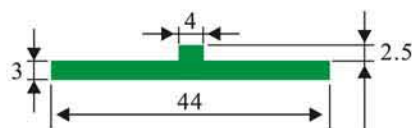

Jd051

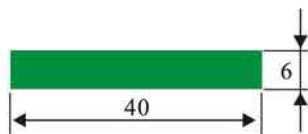

Jd052

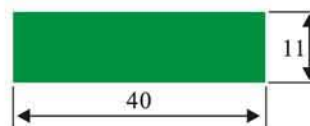

**GUIAS DE DESLIZAMIENTO**

Jd053

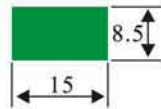

Jd054



Jd055

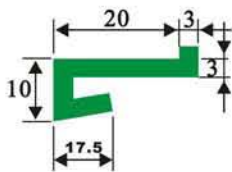

Jd056

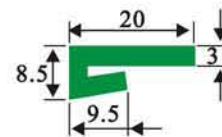

Jd057

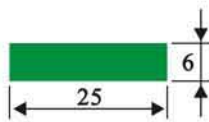

Jd058

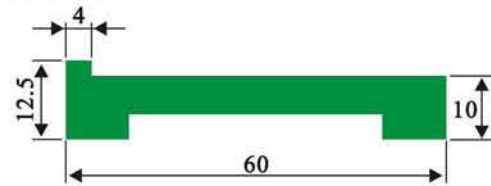

Jd060

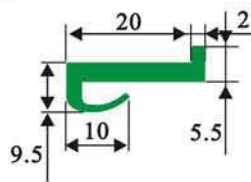

Jd061

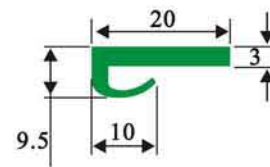

Jd063

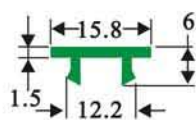

Jd064

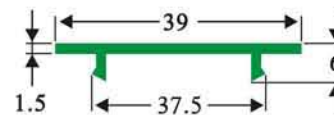

**GUIAS DE DESLIZAMIENTO**

Jd065

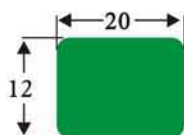

Jd066

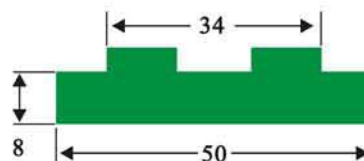

Jd067

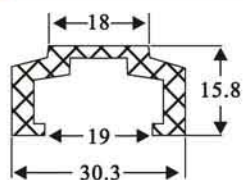

Jd068

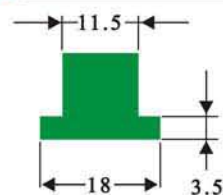

Jd069

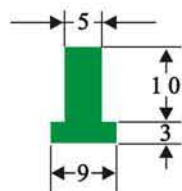

Jd070



Jd071

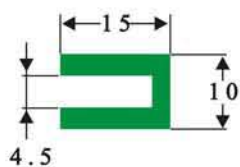

Jd072

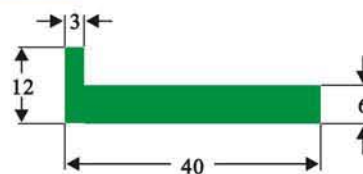

Jd073

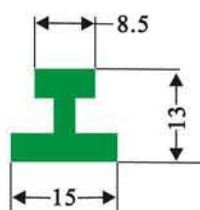



GUIAS DE DESLIZAMIENTO

Jd074

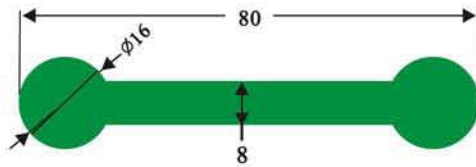

Jd075

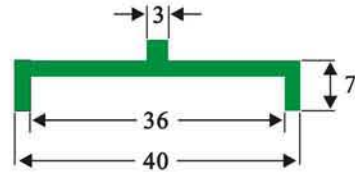

Jd078

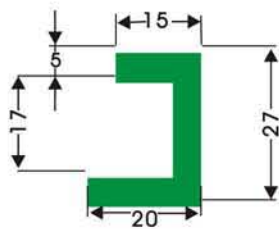

Jd080

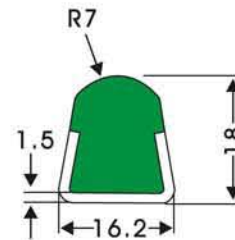

Jd081

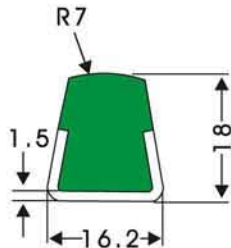

Jd082

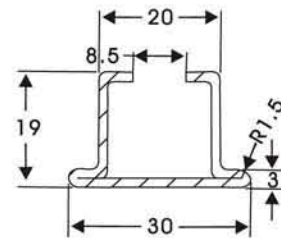

Jd083

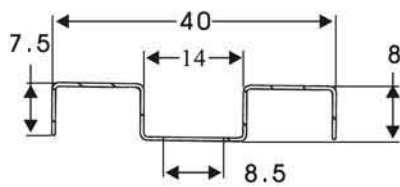

Jd084

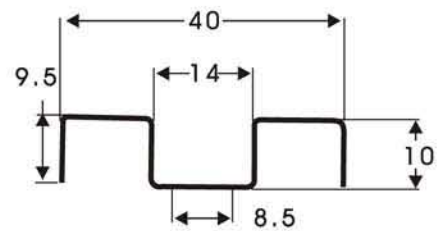

**GUIAS DE DESLIZAMIENTO**

Jd085

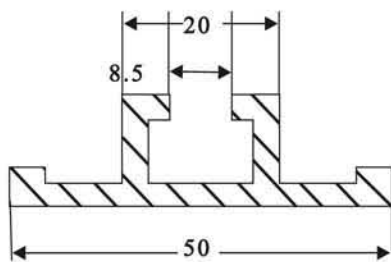

Jd086

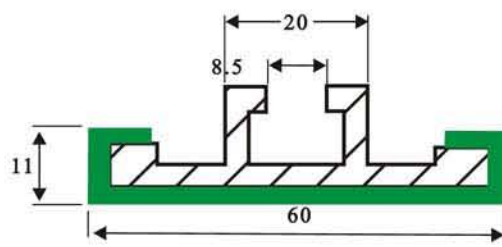

Jd087

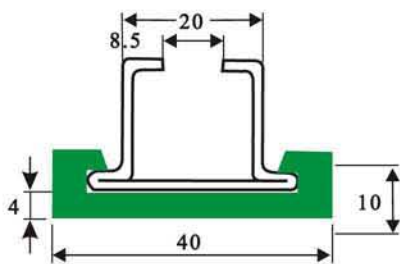

Jd088

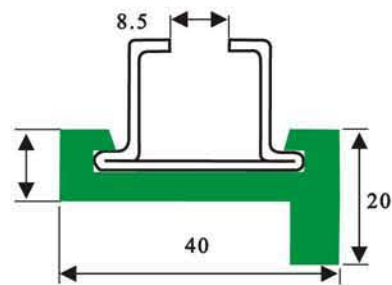

Jd089

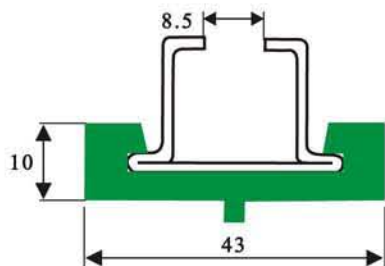

Jd090

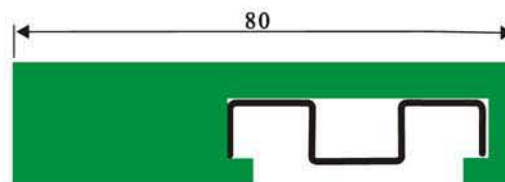

PLASTICOS ESPECIALES



TEL: 56-2-5555123  
E-MAIL: [VENTAS@ITAL-CHILE.CL](mailto:VENTAS@ITAL-CHILE.CL)  
WEB: [WWW.ITAL-CHILE.CL](http://WWW.ITAL-CHILE.CL)  
DIR.: SAN FRANCISCO 1122  
SANTIAGO

**Ital**  **chile**